



Making home ownership possible

Heathfield Gardens
Central Croydon
13 apartments & 7 maisonettes
Mikhail Riches

Heathfield Gardens is just south of Croydon town centre. It's a very convenient location on a quiet street close to the restaurant quarter and a short walk from South, West and East Croydon stations.

There are 13 apartments and 7 maisonettes, set within an existing residential area, with shared landscaped areas for neighbours to meet.

13 APARTMENTS AND 7 MAISONETTES
SHARED OWNERSHIP
FROM £77,500 FOR A 25% SHARE



The specifications in this brochure are for guidance only. These particulars do not form any part of an offer or contract and are subject to change.

sales@soresi.co.uk
0208 607 0550



Making home ownership possible



Each home has a private balcony or garden, and there's secure cycle storage for residents.

Located just a short walk from Croydon town centre which offers access to the high street, plenty of culture, independent shops and cafes, cinemas, libraries, parks and the infamous BoxPark.

There are great connections around Croydon and beyond to central London and Gatwick Airport, with buses, trams, and trains and even the Overground all within easy reach.









KEY FEATURES

- Shared landscaped areas
- Help to Buy available
- Short walk to East, West and South Croydon stations
- Quiet location
- Perfect for couples and young families
- Parquet timber flooring in living areas
- Composite stone grey worktops and Bosch appliances



Interior photographs from a different Brick By Brick scheme, some finishes may vary.

SUSTAINABILITY FEATURES

-  Car club space
-  Electric vehicle parking
-  PV panels
-  Cycle parking
-  MVHR unit
-  Green roof

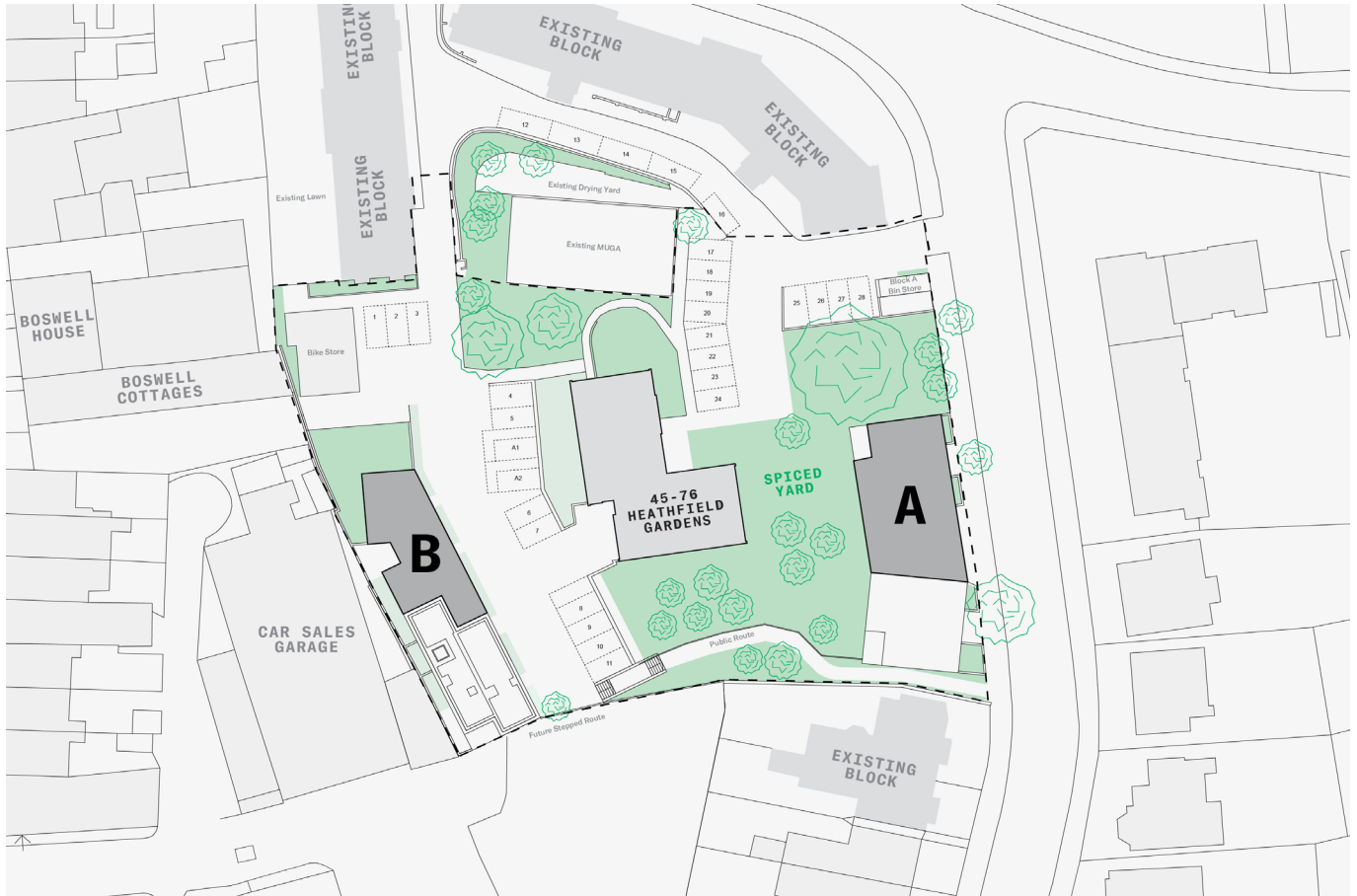

Site plan

Tucked away from the main road, Heathfield Gardens offers a quiet location close to everything Croydon has to offer.

LOCAL AREA / TRANSPORT

- Bus stops: Coombe Road (stop V), 2 min walk
- Train stations:
West Croydon station, 17 min walk, 6 min cycle
East Croydon station, 16 min walk, 5 min cycle
South Croydon station, 9 min walk, 6 min cycle
- Journey time: central London by train, 20 mins
- Nearest parks: Park Hill Recreation Ground, Wandle Park, Lloyd Park



Making home ownership possible



WHAT IS SHARED OWNERSHIP?

Shared ownership is a way of making home ownership possible for more people. You buy a share of your home, with a lower deposit, smaller mortgage and monthly payment on the rest. You can choose how much you buy, between 25% and 75%, depending on your income.

SOResi is a sales agent specialising in shared ownership, by making everything clear and uncomplicated, so you understand how it all works at every stage, before and after you buy.