



welcome to  
**Millfields**  
Cam • Gloucestershire



A modern development of  
3 bedroom new homes  
for shared ownership sale

welcome to your new home

# Millfields, Cam

Gloucestershire GL11

3 Bedroom Terrace Houses | **Plots 43, 44, 45, 78, 79 & 80**

platform   
**home**  
OWNERSHIP



## Kitchen

Contemporary kitchen cupboards

Stainless steel cooker, hob and extractor

Space for washing machine and fridge/freezer

Vinyl flooring

## Bathroom

Three piece white suite

Family bathroom

Downstairs WC

Vinyl flooring

## General

Village location close to the Cotswolds

Local amenities

Transport links

CGI shown is for illustrations purposes only.

# Millfields, Cam

Gloucestershire GL11

3 Bedroom Terrace Houses | **Plots 43, 44, 45, 78, 79 & 80**

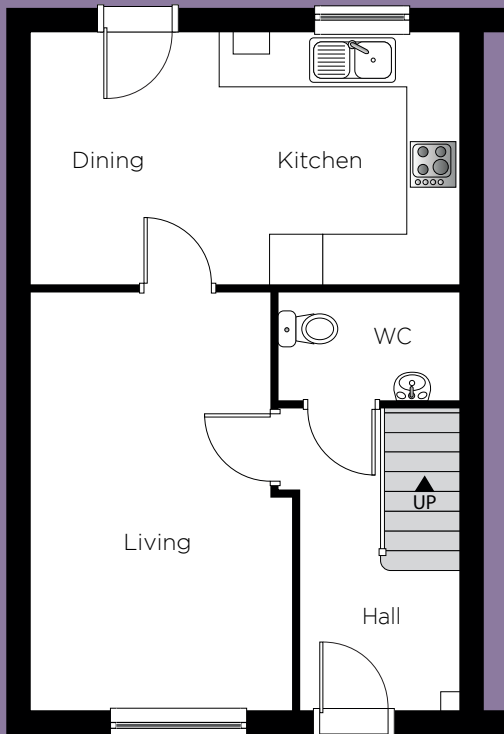

Ground Floor

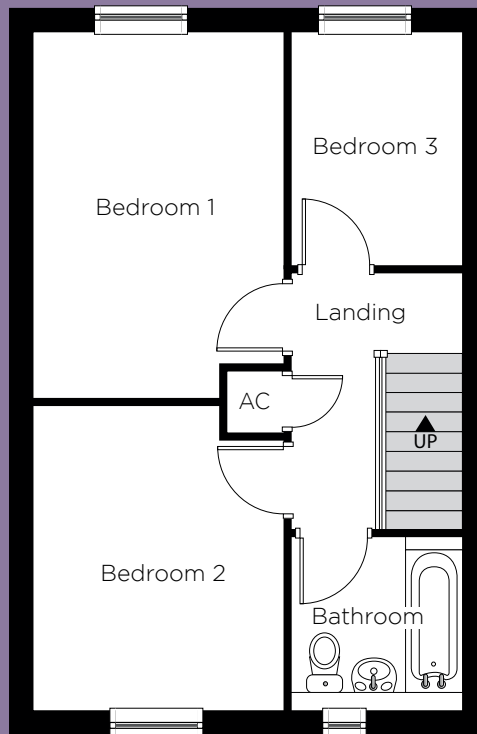

First Floor

**Please note:**  
Some plots will be the opposite floor layout to shown.

## Ground Floor

Kitchen/ dining	5.25m 17' 3"	x	3.09m 10' 1"	(max)
Living	5.09m 16' 8"	x	3.19m 10' 5"	(max)

## First Floor

Bed 1	4.51m 14' 9"	x	3.07m 10' 1"	(max)
Bed 2	3.70m 12' 1"	x	3.07m 10' 1"	(max)
Bed 3	2.88m 9' 5"	x	2.11m 6' 11"	(max)
Bathroom	2.10m 6' 11"	x	2.10m 6' 11"	(max)

**Total Floor Area:**  
87.41m<sup>2</sup>/940.90 sq.ft

Kitchen layouts are indicative only. Please consult with Platform staff for specific plans, room dimensions and kitchen layouts. The information is for guidance only and is not to be relied on as statements or representations of fact and they do not make or give representation or warrant whatsoever and do not form part of any contract. All room measurements shown in metric first followed by imperial underneath.



# Millfields, Cam

Gloucestershire GL11

Site plan



## Development

-  3 Bedroom End-Terrace Houses Plots 43, 45, 78 & 80
-  3 Bedroom Mid-Terrace Houses Plots 44 & 79

Part of the  platform housing group

For further details please contact our sales team on: **0333 200 7304** or email: [sales@platformhg.com](mailto:sales@platformhg.com)

**Contact Us:**  [www.platformhomeownership.com](http://www.platformhomeownership.com) |  [facebook.com/PlatformHomeOwnership](https://facebook.com/PlatformHomeOwnership)  
 [twitter.com/PlatformNewHome](https://twitter.com/PlatformNewHome) |  [instagram.com/platformhomeownership](https://instagram.com/platformhomeownership)

# Millfields, Cam

Gloucestershire GL11

House prices for all plots available



## Houses available

Plot	House Type	Postal Address	Handover	100% Price	40% Share Value	Monthly Rent	Service Charge
43	3 Bedroom End-Terrace House	21 Whatling Way, Cam, Dursley, Gloucestershire GL11 5FT.	February 2024	£302,500	£121,500	£415.94	£28.31
44	3 Bedroom Mid-Terrace House	19 Whatling Way, Cam, Dursley, Gloucestershire GL11 5FT.	February 2024	£300,000	£120,000	£412.50	£28.31
45	3 Bedroom End-Terrace House	17 Whatling Way, Cam, Dursley, Gloucestershire GL11 5FT.	February 2024	£302,500	£121,500	£415.94	£28.31
78	3 Bedroom End-Terrace House	28 Whatling Way, Cam, Dursley, Gloucestershire GL11 5FT.	January 2024	£302,500	£121,500	£415.94	£28.31
79	3 Bedroom Mid-Terrace House	26 Whatling Way, Cam, Dursley, Gloucestershire GL11 5FT.	January 2024	£300,000	£120,000	£412.50	£28.31
80	3 Bedroom End-Terrace House	24 Whatling Way, Cam, Dursley, Gloucestershire GL11 5FT.	January 2024	£302,500	£121,500	£415.94	£28.31

For further details please contact our sales team on: **0333 200 7304** or email: [sales@platformhg.com](mailto:sales@platformhg.com)

**Contact Us:**  [www.platformhomeownership.com](http://www.platformhomeownership.com) |  [facebook.com/PlatformHomeOwnership](https://facebook.com/PlatformHomeOwnership)

 [twitter.com/PlatformNewHome](https://twitter.com/PlatformNewHome) |  [instagram.com/platformhomeownership](https://instagram.com/platformhomeownership)

For details contact our sales team  
on **0333 200 7304**  
or email: **sales@platformhg.com**

**Contact Us:**



[www.platformhomeownership.com](http://www.platformhomeownership.com)



[facebook.com/PlatformHomeOwnership](https://facebook.com/PlatformHomeOwnership)



[twitter.com/PlatformNewHome](https://twitter.com/PlatformNewHome)



[instagram.com/platformhomeownership](https://instagram.com/platformhomeownership)

Scheme administered by Platform Housing Group  
1700 Solihull Parkway, Birmingham Business Park, Solihull, B37 7YD.

Part of the **platform**  
housing group