

CANARY WHARF

luminesce.

LIFE ILLUMINATED.

PLOT 2.01 - 1 BEDROOM

FULL MARKET VALUE

£496,563

25% MINIMUM SHARE

£124,140

10% DEPOSIT

£12,414*

PAY NO RENT FOR 6 MONTHS!*

TOTAL INTERNAL AREA	61.46 sq m	662 sq ft
Reception Room & Kitchen	8.53 x 3.18 m	28' x 10'5"
Bedroom	5.96 x 2.81 m	19'7" x 9'3"

Rent: 2.75%

Service Charge: ££253

Included in the Service Charge is:



Balconies to each apartment



9th floor terrace with panoramic City views

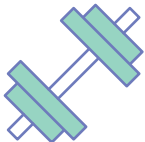

Private resident' gym



Canary Wharf in as little as 2 mins on DLR

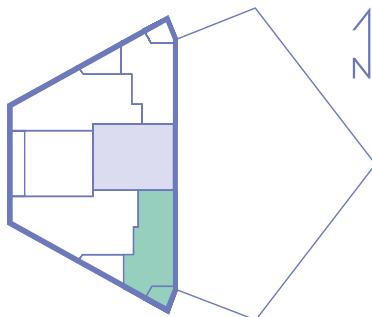

2nd Floor



W - Wardrobe | C - Cupboard

BOOK YOUR VIEWING APPOINTMENT

Call 0344 800 1762

or email luminesce@site-sales.co.uk



Shared Ownership Terms and Conditions Apply. The floorplans provided are intended to only give a general indication of the proposed floor layout and are not drawn to scale. Measurements are given to the widest point, are approximate and are given as a guide only. Unless specifically incorporated in writing into the sales contract the specification is not intended to form part of any contract or warranty. *Terms and conditions apply. Please speak to a sales consultant for more information.