

# ST ANDREW'S MEADOW

• BACTON •



## 2 bedroom semi-detached house

Plots 37, 38, 45, 46

### GROUND FLOOR

Kitchen	4.29m x 2.57m	14'1" x 8'5"
Living room	5.00m x 4.07m	16'5" x 13'4"

### FIRST FLOOR

Bedroom 1	3.77m x 3.31m	12'4" x 10'10"
Bedroom 2	4.20m x 2.71m	13'9" x 8'11"

# ST ANDREW'S MEADOW

• BACTON •

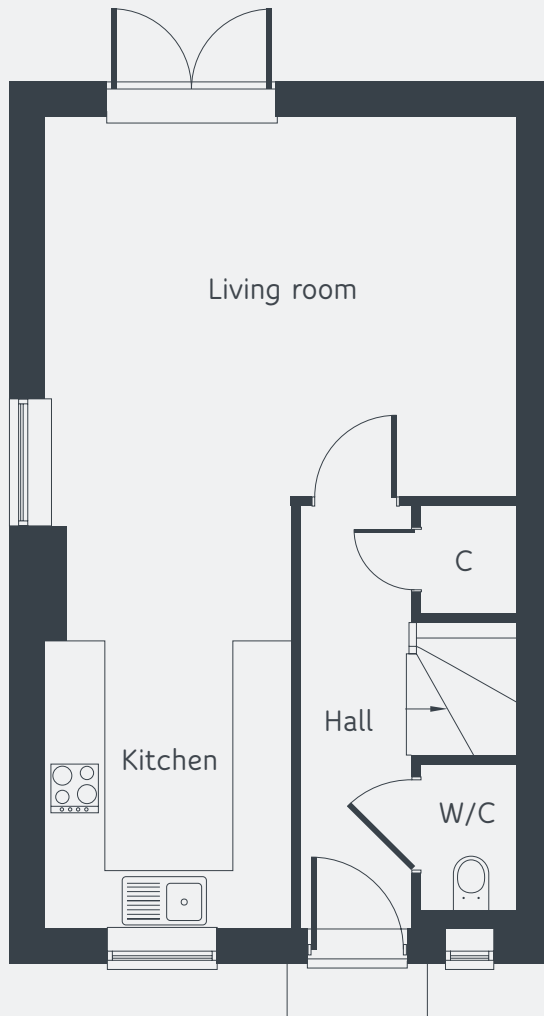

GROUND FLOOR

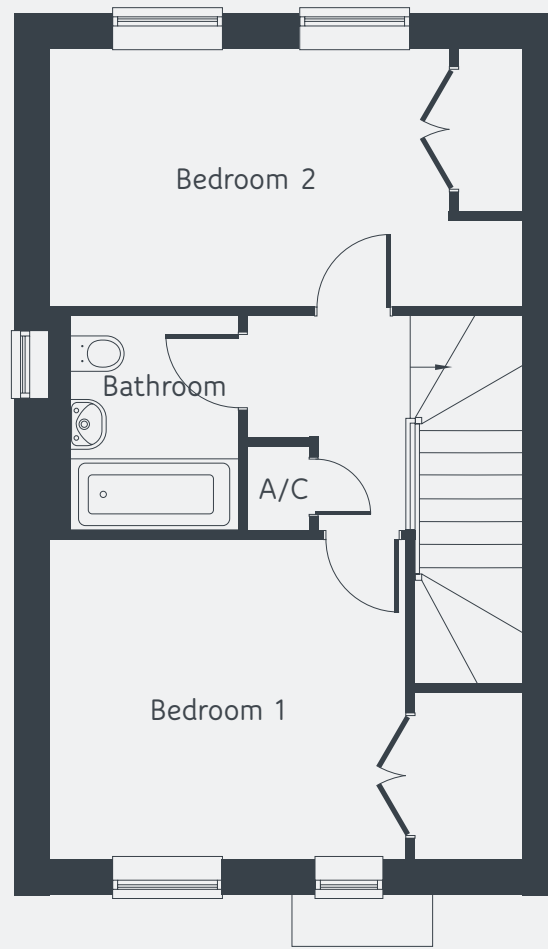

FIRST FLOOR

Total floor space: 850 sq ft / 79 sq m

Floor plans and computer generated images are indicative only and external finished may vary.  
Dimensions shown may vary within a tolerance of +/- 50mm and are not intended to be used for carpet sizes, appliance sizes or items of furniture.  
Floor plans are not shown to scale.