

£55,000 Shared Ownership

124 Commercial Road, Bournemouth, Dorset, BH2 5AT



- Guideline Minimum Deposit £5,500
- Sixth Floor with Balcony
- Impressive View
- Parking Space
- Guideline Income Dual £27.3k | Single £32.5k
- Approx. 537 Sqft Gross Internal Area
- Town Centre Location
- Short Walk from the Beach

GENERAL DESCRIPTION

SHARED OWNERSHIP (Advertised price represents 25% share. Full market value £220,000). This apartment is on the sixth floor and features a reception room with open-plan kitchen, a good-sized main bedroom and a slightly smaller second double bedroom. Both the reception and the larger bedroom have double doors that lead out onto a narrow but full-width terrace which provides a great view of the surrounding area. The building has a lift, modern double glazing, well insulated walls and a brilliant town centre location. The well-tended public gardens are close by and the beach is only a short walk away. The apartment comes with use of a parking space.

Tenure: Leasehold (125 years from 2008).

Minimum Share: 25% (£55,000).

Shared Ownership Rent: £546.25 per month (subject to annual review).

Combined Building Insurance/Admin Fee: £43.53 per month (subject to annual review).

Service Charge: £112.22 per month (subject to annual review).

Ground Rent: £106.66 for current year.

Guideline Minimum Income: Dual £27,300 | Single £32,500 (based on minimum share and 10% deposit).

Council Tax: Band B, Bournemouth, Christchurch & Poole Council. Priority is given to applicants living and/or working in this local authority.

This property is offered for sale in the condition seen. The housing association does not warrant to carry out any remedial or redecoration work of a cosmetic nature unless specifically advised in writing. As a general rule, fitted domestic appliances are included in the sale; non-fitted appliances are not. If you require confirmation, you must request this in writing from Urban Moves. The information in this document supersedes any information given verbally either in person or by telephone.



Commercial Road, Bournemouth, BH2

Approximate Area = 537 sq ft / 50 sq m
For identification only - Not to scale

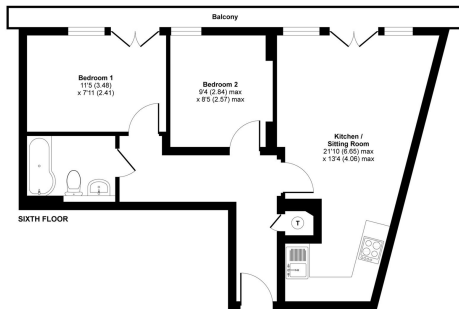

DIMENSIONS

- RECEPTION
21' 10" max. x 13' 4" max. (6.65m x 4.06m)
- KITCHEN
included in reception measurement
- BEDROOM 1
11' 5" x 7' 11" (3.48m x 2.41m)
- BEDROOM 2
9' 4" max. x 8' 5" max. (2.84m x 2.57m)
- BATHROOM

Approved Property Measurement Standards incorporating International Property Measurement Standards (IPMS) (Residential) Produced by Urban Moves REF: 638640

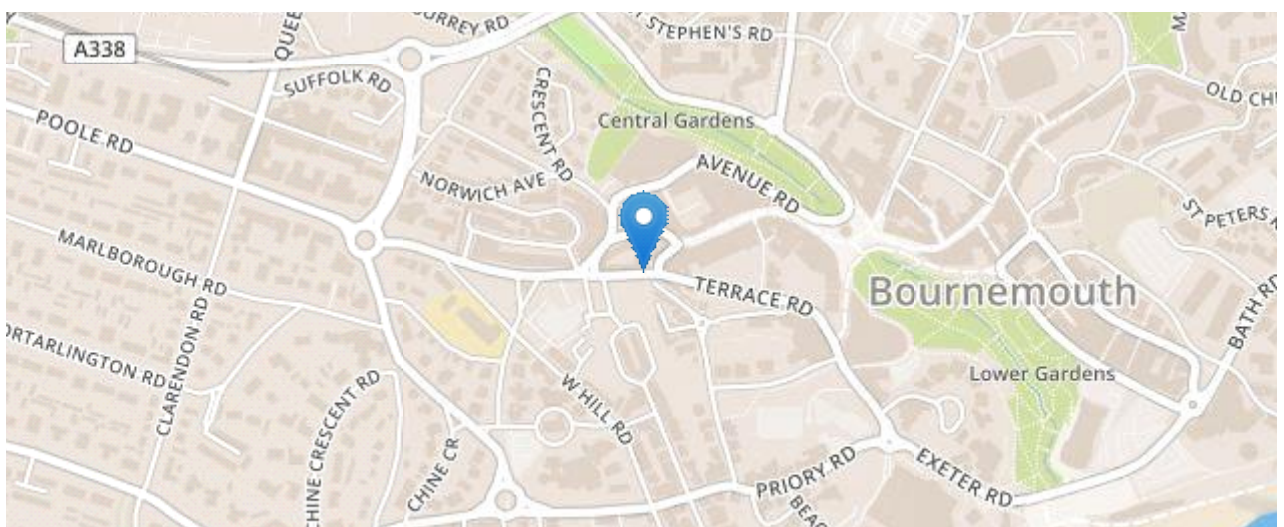
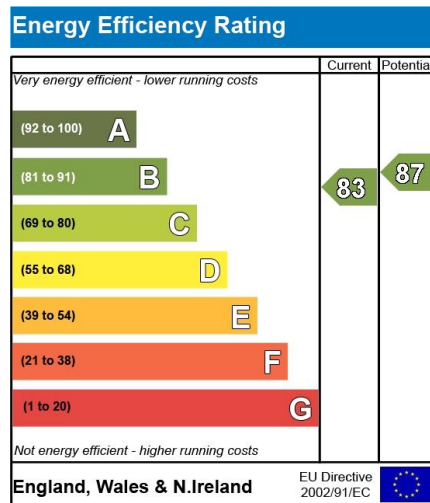
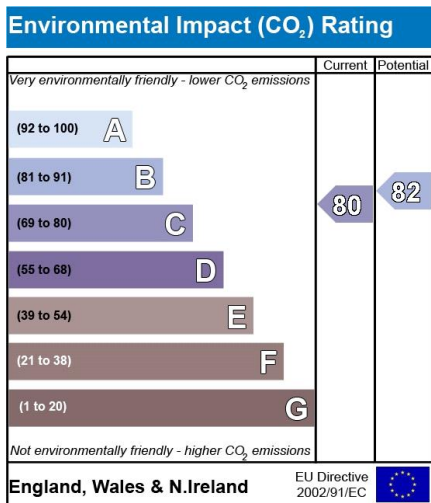

All content shown is to be used as a general guideline for the property. None of the contents of this document constitute part of an offer or contract. All measurements, photographs, floor-plans and data provided are only a guideline and should not be relied upon.