

# The Chestnut II

The Hedgerows, Hellingly

Three Bedroom Home

Plots 51, 52, 53, 54, 57, 58, 59, 72, 73, 223 and 224



Your place  
to thrive

[orbithomes.org.uk](https://orbithomes.org.uk)

📞 01323 700527

➔ [thehedgerows@orbit.org.uk](mailto:thehedgerows@orbit.org.uk)

# The Chestnut II

The Hedgerows, Hellingly

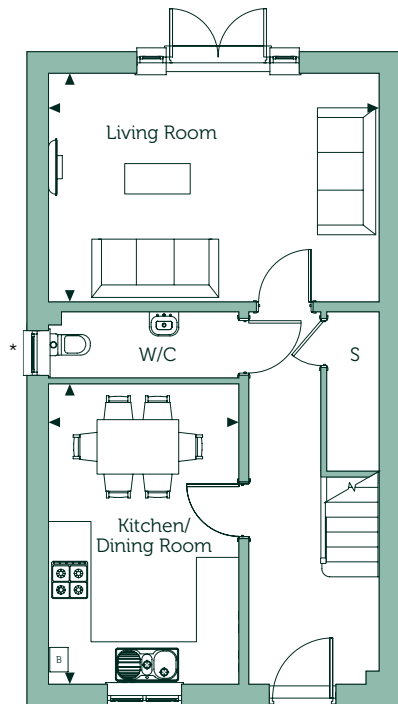

## Ground Floor

**Living Room**  
16'7" x 11'6"                      5.06m x 3.50m

**Kitchen/Dining Room**  
15'1" x 9'7"                        4.60m x 2.92m

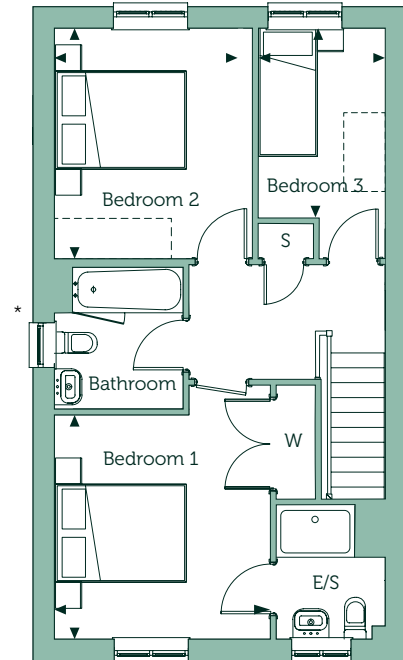

## First Floor

**Bedroom 1**  
11'3" x 10'10"                      3.43m x 3.30m

**Bedroom 2**  
11'7" x 9'9"                        3.53m x 2.96m

**Bedroom 3**  
9'7" x 6'7"                         2.91m x 2.01m

**Gross internal area**  
1018 sq ft                         94.6 sq m

\*Refer to plot specific plans for window allocations.

## Key

**B** Boiler   **S** Store Cupboard   **W** Fitted wardrobe

Floorplans are not drawn to scale. Measurements are taken from areas marked with an arrow. They are maximum approximate dimensions and given as a guide only. These should not be used as a basis for purchasing flooring or furniture. Orbit reserve the right to alter plans, specifications, position of doors and windows and change tenure subject to demand without prior notice. External elevations vary from plot to plot. Please ask your Sales Consultant for current information when reserving your new home. Information correct at time of going to print. Computer generated image overleaf.