



Woodland View.

Woodland View, Bishops Cleeve

Brand new two and three bedroom
Shared Ownership homes in
Bishops Cleeve



The Cleeve

2 bedroom house



Computer generated artists impression only. The image shown is for illustrative purposes only. Brick and tile colour, window and door styles, elevational treatments and external landscaping may vary. Please consult our sales team.

Bromford.

The Cleeve
2 bedroom house

Bromford.
findahome.bromford.co.uk
sales@bromford.co.uk
0800 0852 499



Ground Floor

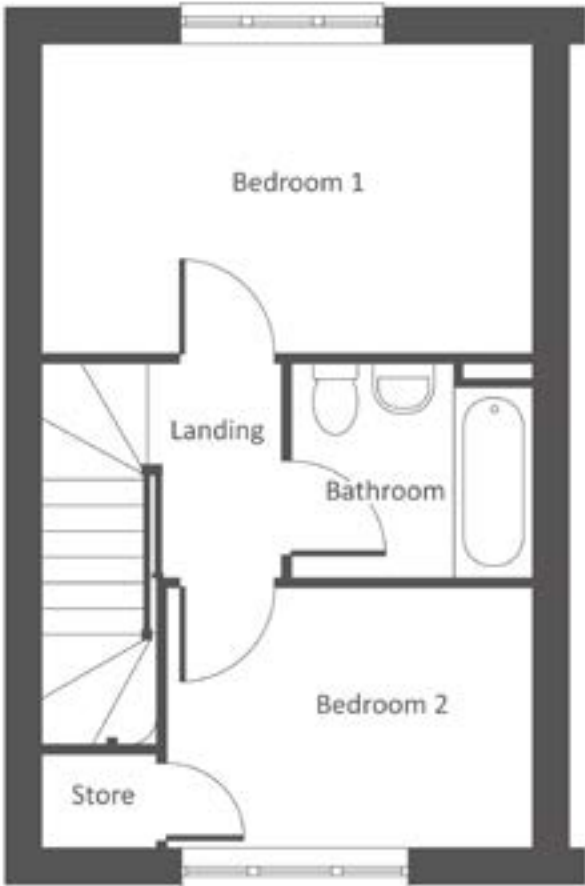

First Floor

- Full gas fired central heating
- Double glazing and high performance insulation throughout
- Allocated parking spaces
- Turfed rear gardens
- 12 years new home warranty

Room	Metres	Feet
Living/Dining	2.74m x 4.37m	9'0" x 14'4"
Kitchen	3.17m x 2.50m	10'5" x 8'2"
WC	1.01m x 1.91m	3'6" x 6'3"

Room	Metres	Feet
Bedroom 1	2.74m x 4.37m	9'0" x 14'4"
Bedroom 2	2.30m x 3.25m	7'6" x 10'7"
Bathroom	1.88m x 2.13m	6'2" x 7'0"

Due to the nature of construction, room sizes may vary and purchasers are advised to satisfy themselves as to their accuracy. These dimensions are not intended to be used for carpet sizes, appliance spaces or items of furniture. Please note that the windows positions may vary, please speak with our Sales Consultants for each individual plot information. For electrical, heating and kitchen specification please contact our sales team.

The Woodmancote

3 bedroom house



Computer generated artists impression only. The image shown is for illustrative purposes only. Brick and tile colour, window and door styles, elevational treatments and external landscaping may vary. Please consult our sales team.

Bromford.

The Woodmancote
3 bedroom house

Bromford.
findahome.bromford.co.uk
sales@bromford.co.uk
0800 0852 499



Ground Floor

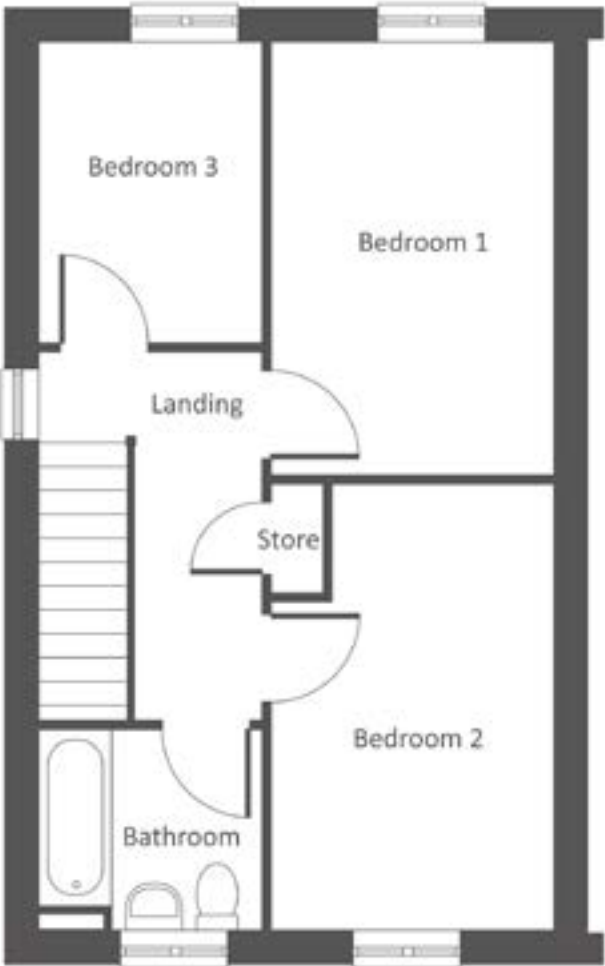

First Floor

- Full gas fired central heating
- Double glazing and high performance insulation throughout
- Allocated parking spaces
- Turfed rear gardens
- 12 years new home warranty

Room	Metres	Feet
Living/Dining	4.15m x 4.96m	13'7" x 16'3"
Kitchen	3.15m x 2.94m	10'4" x 9'8"
WC	1.02m x 1.91m	3'4" x 6'3"

Room	Metres	Feet
Bedroom 1	4.15m x 2.71m	13'7" x 8'10"
Bedroom 2	4.28m x 2.71m	14'0" x 8'10"
Bedroom 3	2.88m x 2.13m	9'5" x 7'0"
Bathroom	1.92m x 2.13m	6'3" x 7'0"

Due to the nature of construction, room sizes may vary and purchasers are advised to satisfy themselves as to their accuracy. These dimensions are not intended to be used for carpet sizes, appliance spaces or items of furniture. Please note that the windows positions may vary, please speak with our Sales Consultants for each individual plot information. For electrical, heating and kitchen specification please contact our sales team.

Are you dreaming of owning your own home but think you can't afford it?

Think again – shared ownership can make that dream a reality.

Shared ownership is a scheme that allows you to buy a share of your property, usually between 40% and 75%, and pay subsidised rent on the rest.

It's a great way to get on the property ladder and often proves to be more affordable than renting.

There are certain criteria that you need to match to be eligible for shared ownership so to get all the details please go to findahome.bromford.co.uk to find out more.



Woodland View.

Woodland View, Homelands Farm,
Bishops Cleeve GL52 8HZ

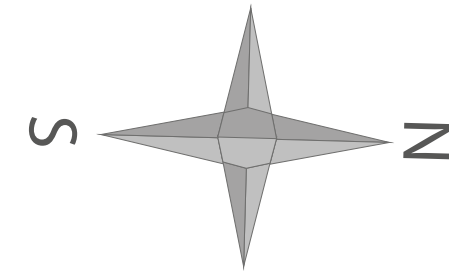

- The Cleeve
2 bedroom house
- The Woodmancote
3 bedroom house
- Bromford.affordable rent
- Linden Homes

Artist's impression drawn from architect's plans to show the relative position of individual properties. NOT TO SCALE. This is a two dimensional drawing and will not show land contours and gradients, boundary treatments, landscaping or local authority street lighting. Please contact our sales team for more information.

Bromford.

You'll notice that on most of our property listings we say that a local connection to the area is needed.

This is because the homes for sale in these areas have been built specifically to help meet the needs of local people who can't afford to get on the housing ladder any other way.

The local area connection criteria varies between sites, but generally it's based on:

- **Being a resident (or employed within) the area for a number of years (usually between 2 to 5)**
- **Family connections – for example, parent, grandparent, child, grandchild or adult sibling – who have lived in the area for at least three years.**

Priority will be given to applicants who have a connection to Tewkesbury Borough Council.

Next steps

- Check the local area connection
- Register with the Help to Buy agent for the area you're looking to buy in
- Get in touch and we'll talk you through the affordability assessment
- More information at findahome.bromford.co.uk/sharedownership

So what happens
next?



For almost 60 years we have provided customers with new and affordable homes. We want all of our customers to thrive and believe that with the right homes and someone who believes in their potential, almost anything is possible - with shared ownership helping more people than ever before to realise their dreams of owning their home.

Bromford.

Want to contact us?

Shannon Way,
Ashchurch,
Tewkesbury,
GL20 8ND

0800 0852 499
sales@bromford.co.uk
findahome.bromford.co.uk



Bromford abides by the Consumer Protection from Unfair Trading Regulations 2008