

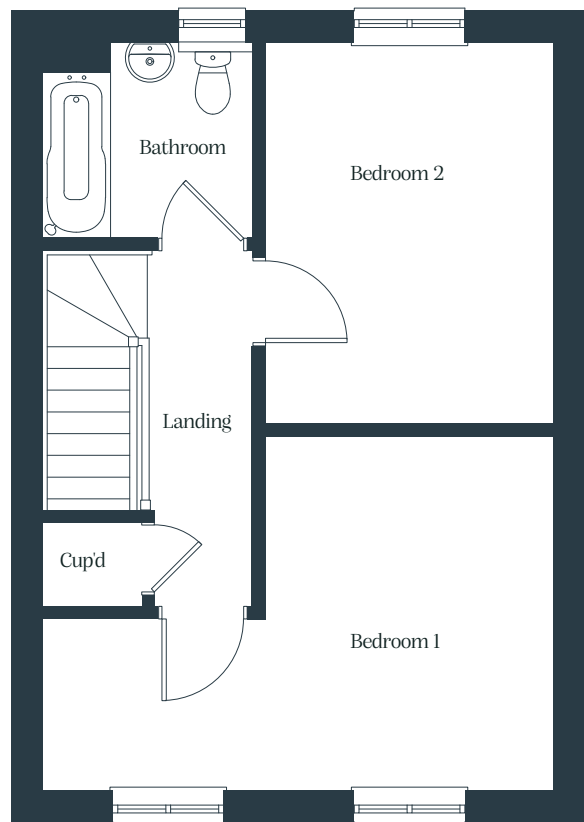

# ASHVINE PARK CANTERBURY

## Two bedroom house

8 HANCOCK WAY, THANINGTON, CANTERBURY, KENT

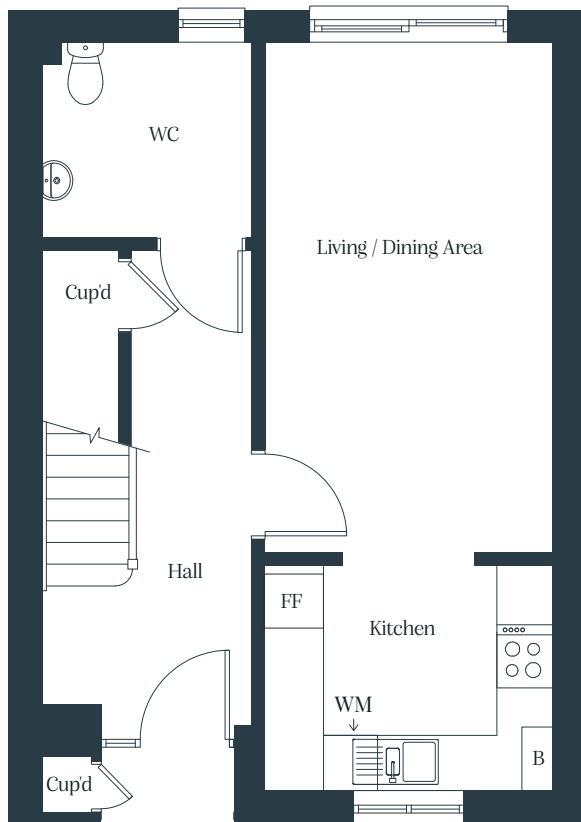

<b>Total Internal Area</b>	<b>79 sq m</b>
Kitchen	2.9m x 2.3m
Living / Dining area	2.9m x 5.2m
Bedroom 1	5.2m x 3.6m
Bedroom 2	2.9m x 3.9m

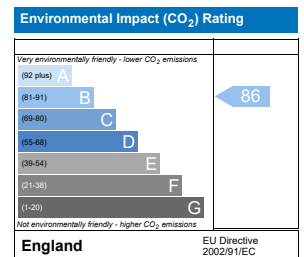
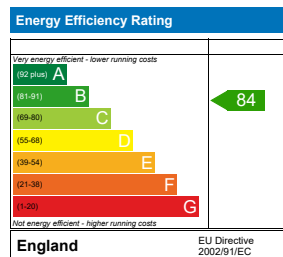

Cup'd = Cupboard, WC = Water Closet, B = Boiler, FF = Fridge Freezer, WM = Washing Machine

Floor plans shown are indicative only. All room sizes are approximate with maximum dimensions of finished items of furniture. Room layouts may be subject to minor modifications. Furniture, kitchen and bathroom layouts shown are indicative only\*. Measurement at widest point.

Parking under FOG is for private sale use.



# ASHVINE PARK CANTERBURY

## Two bedroom house

10 HANCOCK WAY, THANINGTON, CANTERBURY, KENT

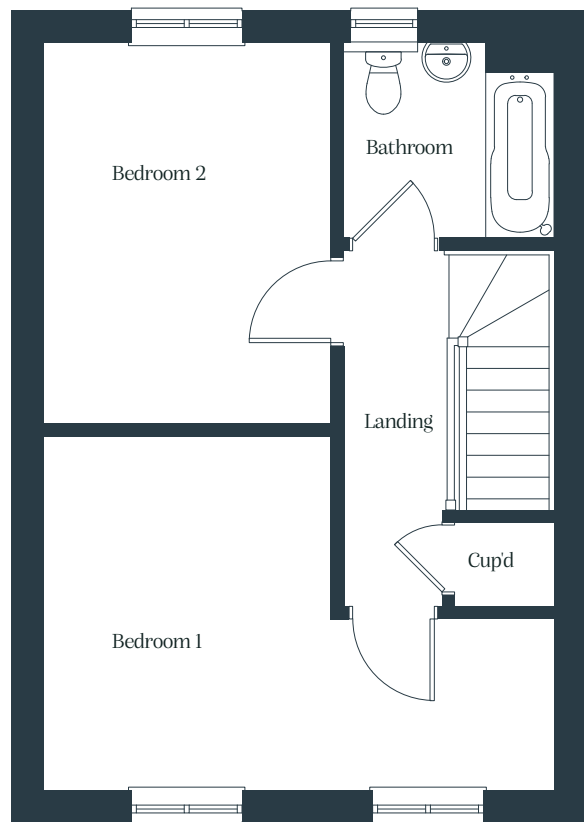
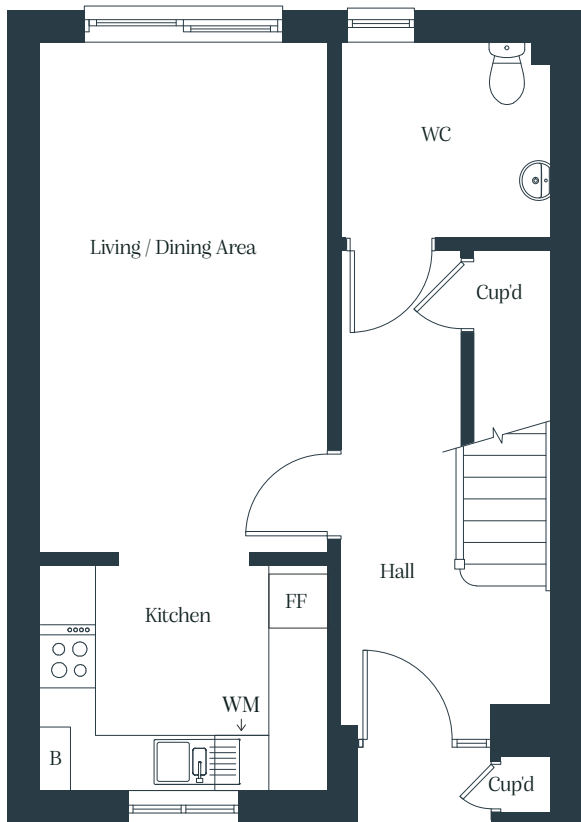

Total Internal Area	79 sq m
Kitchen	2.9m x 2.3m
Living / Dining area	2.9m x 5.2m
Bedroom 1	5.2m x 3.6m
Bedroom 2	2.9m x 3.9m

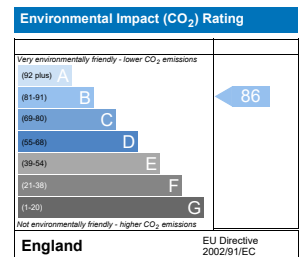
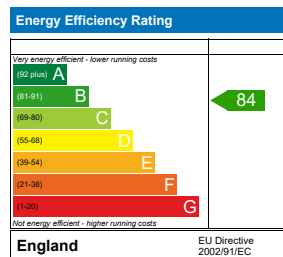

Cup'd = Cupboard, WC = Water Closet, B = Boiler, FF = Fridge Freezer, WM = Washing Machine

Floor plans shown are indicative only. All room sizes are approximate with maximum dimensions of finished items of furniture. Room layouts may be subject to minor modifications. Furniture, kitchen and bathroom layouts shown are indicative only\*. Measurement at widest point.

Parking under FOG is for private sale use.



# ASHVINE PARK CANTERBURY

## Three bedroom house

12 HANCOCK WAY, THANINGTON, CANTERBURY, KENT

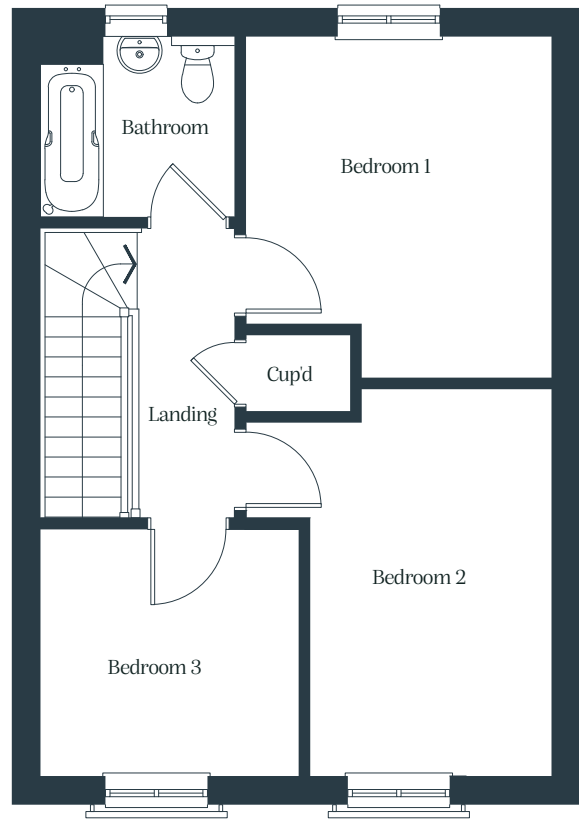
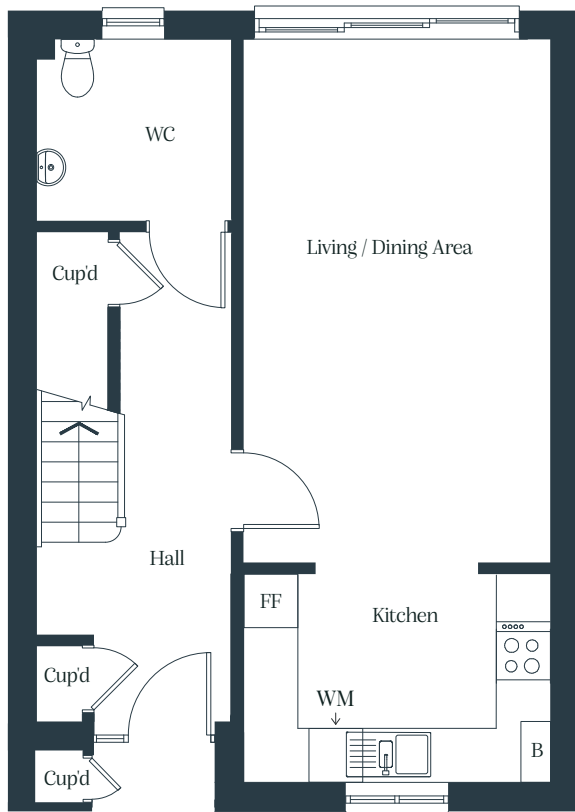

<b>Total Internal Area</b>	<b>93 sq m</b>
Kitchen	3.4m x 2.3m
Living / Dining area	3.4m x 5.7m
Bedroom 1	3.4m x 3.7m
Bedroom 2	2.6m x 4.3m
Bedroom 3	2.8m x 2.7m

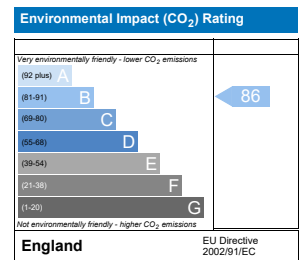
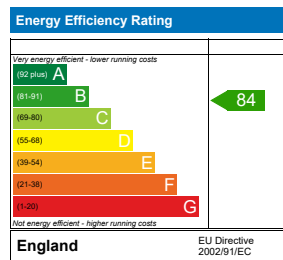

Cup'd = Cupboard, WC = Water Closet, B = Boiler, FF = Fridge Freezer, WM = Washing Machine

Floor plans shown are indicative only. All room sizes are approximate with maximum dimensions of finished items of furniture. Room layouts may be subject to minor modifications. Furniture, kitchen and bathroom layouts shown are indicative only\*. Measurement at widest point.

Parking under FOG is for private sale use.



# ASHVINE PARK CANTERBURY

## Three bedroom house

14 HANCOCK WAY, THANINGTON, CANTERBURY, KENT

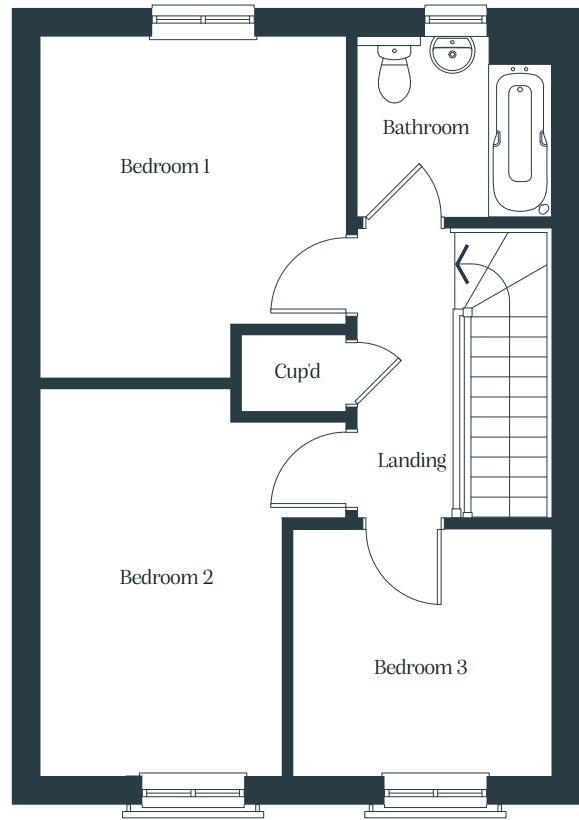
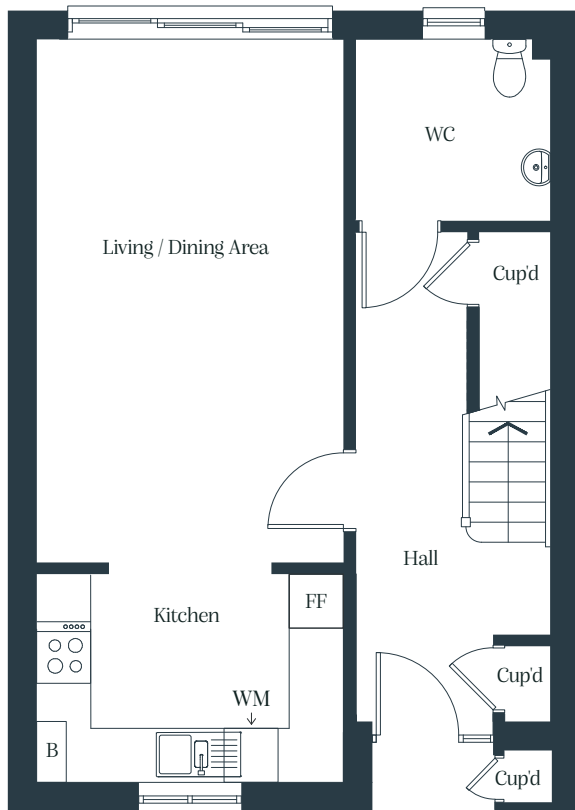

**Total Internal Area** 93 sq m

Kitchen	3.4m x 2.3m
Living / Dining area	3.4m x 5.7m
Bedroom 1	3.4m x 3.7m
Bedroom 2	2.6m x 4.3m
Bedroom 3	2.8m x 2.7m

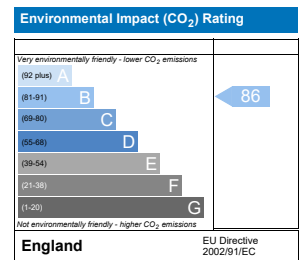
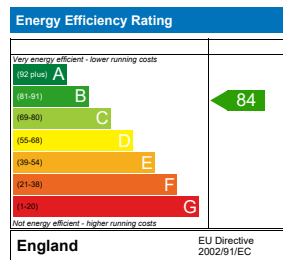

Cup'd = Cupboard, WC = Water Closet, B = Boiler, FF = Fridge Freezer, WM = Washing Machine

Floor plans shown are indicative only. All room sizes are approximate with maximum dimensions of finished items of furniture. Room layouts may be subject to minor modifications. Furniture, kitchen and bathroom layouts shown are indicative only\*. Measurement at widest point.

Parking under FOG is for private sale use.



# ASHVINE PARK CANTERBURY

## Three bedroom house

16 HANCOCK WAY, THANINGTON, CANTERBURY, KENT

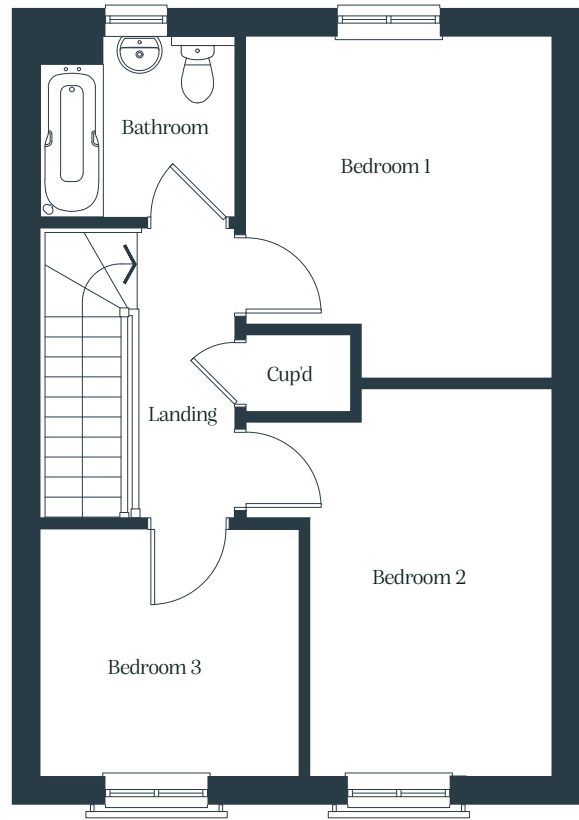
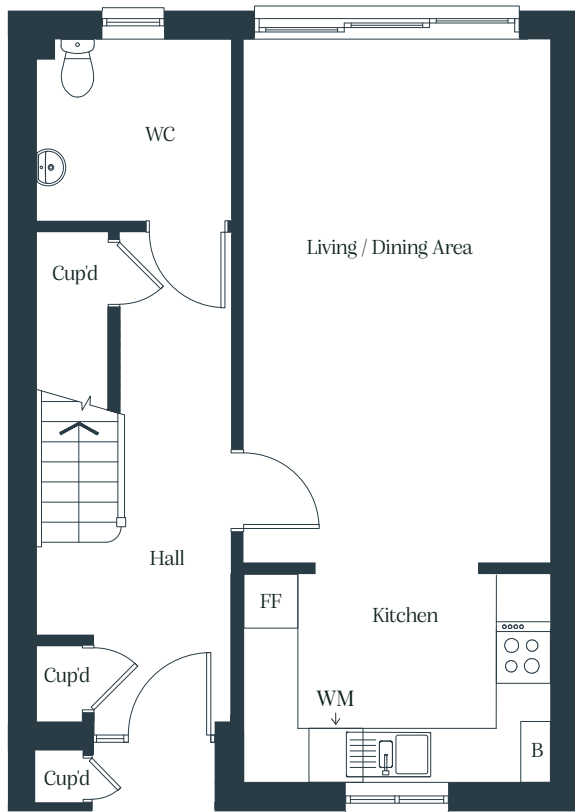

<b>Total Internal Area</b>	<b>93 sq m</b>
Kitchen	3.4m x 2.3m
Living / Dining area	3.4m x 5.7m
Bedroom 1	3.4m x 3.7m
Bedroom 2	2.6m x 4.3m
Bedroom 3	2.8m x 2.7m

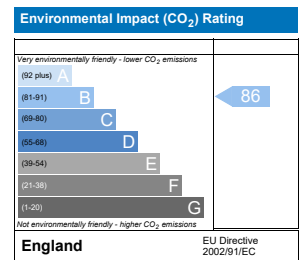
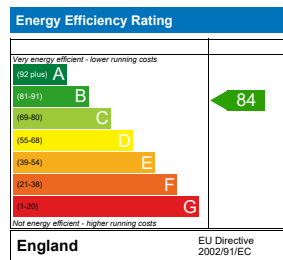

Cup'd = Cupboard, WC = Water Closet, B = Boiler, FF = Fridge Freezer, WM = Washing Machine

Floor plans shown are indicative only. All room sizes are approximate with maximum dimensions of finished items of furniture. Room layouts may be subject to minor modifications. Furniture, kitchen and bathroom layouts shown are indicative only\*. Measurement at widest point.

Parking under FOG is for private sale use.



# ASHVINE PARK CANTERBURY

## Three bedroom house

18 HANCOCK WAY, THANINGTON, CANTERBURY, KENT

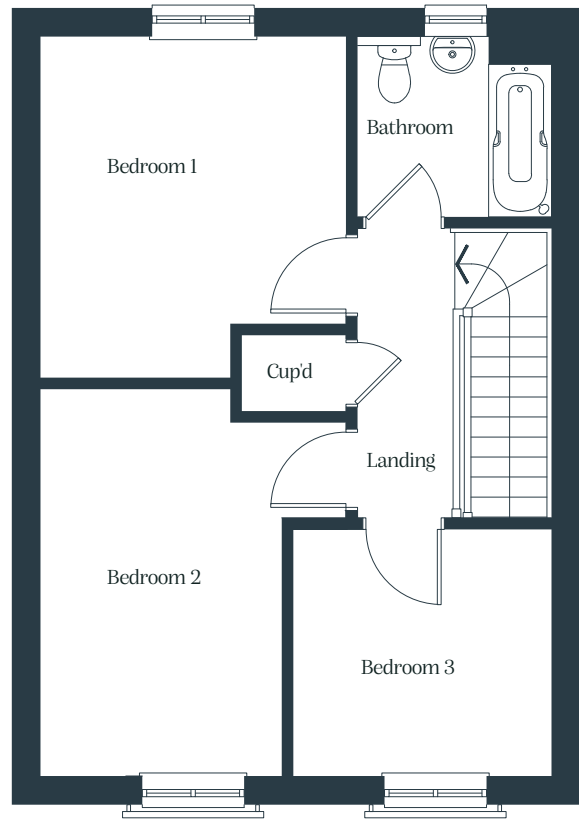
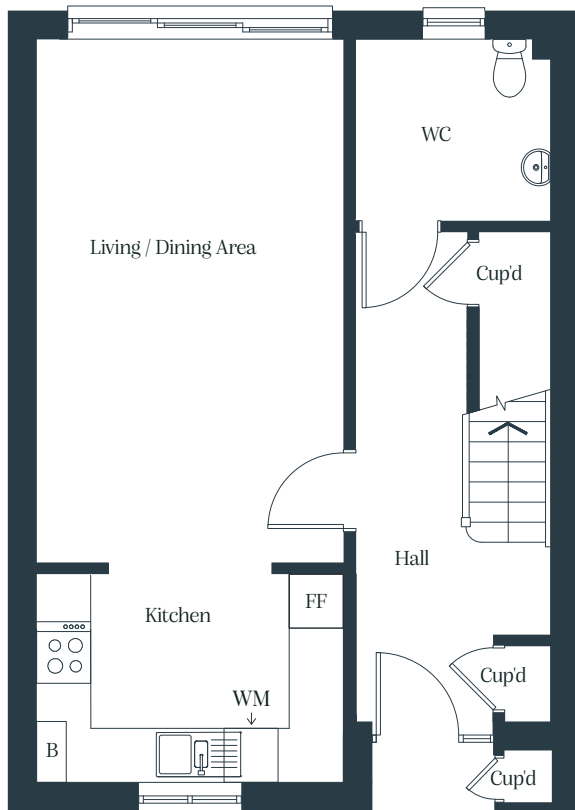

<b>Total Internal Area</b>	<b>93 sq m</b>
Kitchen	3.4m x 2.3m
Living / Dining area	3.4m x 5.7m
Bedroom 1	3.4m x 3.7m
Bedroom 2	2.6m x 4.3m
Bedroom 3	2.8m x 2.7m

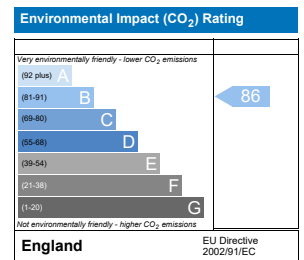
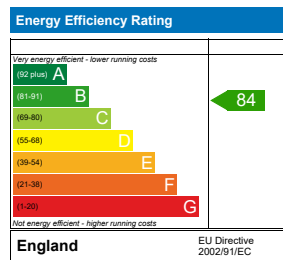

Cup'd = Cupboard, WC = Water Closet, B = Boiler, FF = Fridge Freezer, WM = Washing Machine

Floor plans shown are indicative only. All room sizes are approximate with maximum dimensions of finished items of furniture. Room layouts may be subject to minor modifications. Furniture, kitchen and bathroom layouts shown are indicative only\*. Measurement at widest point.

Parking under FOG is for private sale use.



# ASHVINE PARK CANTERBURY

## Three bedroom house

3 MILES WAY, THANINGTON, CANTERBURY, KENT

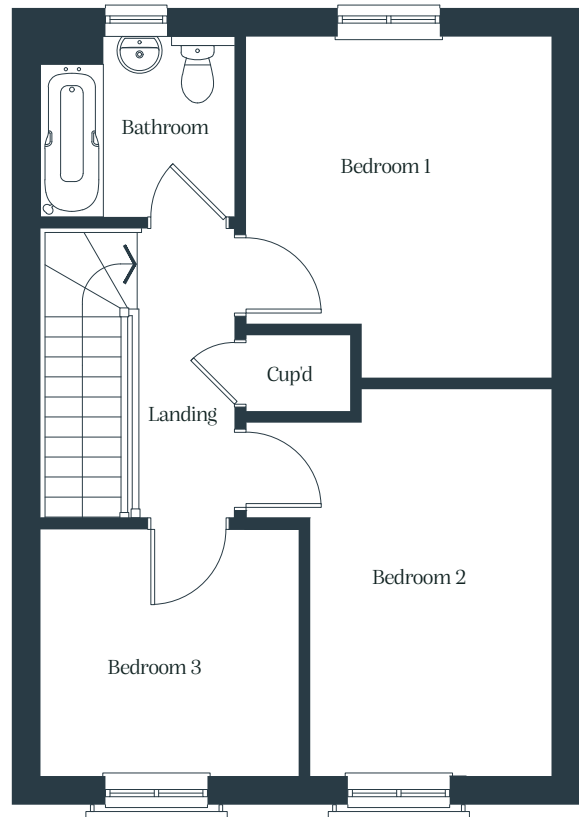
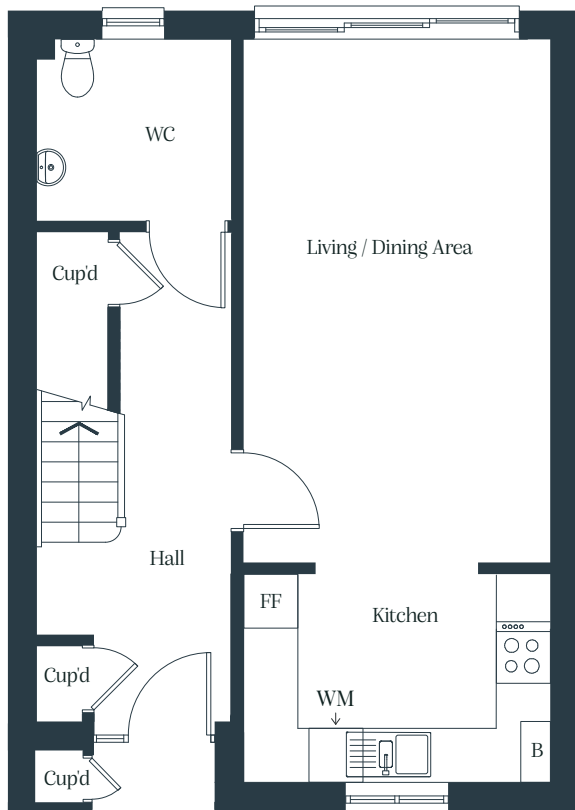

<b>Total Internal Area</b>	<b>93 sq m</b>
Kitchen	3.4m x 2.3m
Living / Dining area	3.4m x 5.7m
Bedroom 1	3.4m x 3.7m
Bedroom 2	2.6m x 4.3m
Bedroom 3	2.8m x 2.7m

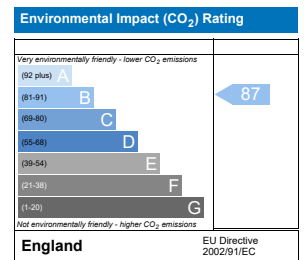
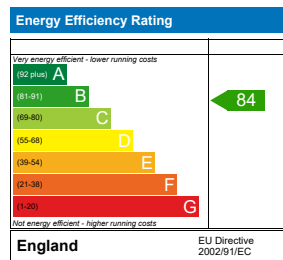

Cup'd = Cupboard, WC = Water Closet, B = Boiler, FF = Fridge Freezer, WM = Washing Machine

Floor plans shown are indicative only. All room sizes are approximate with maximum dimensions of finished items of furniture. Room layouts may be subject to minor modifications. Furniture, kitchen and bathroom layouts shown are indicative only\*. Measurement at widest point.

Parking under FOG is for private sale use.



# ASHVINE PARK CANTERBURY

## Three bedroom house

5 MILES WAY, THANINGTON, CANTERBURY, KENT

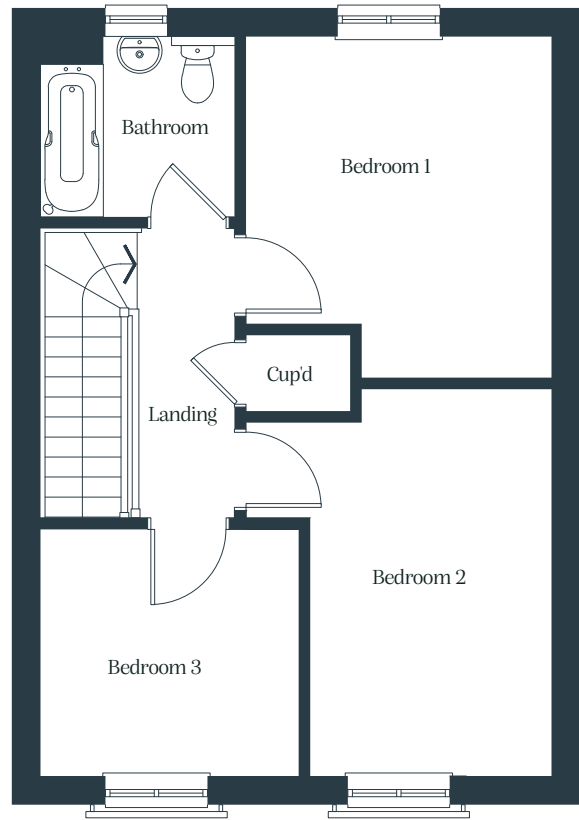
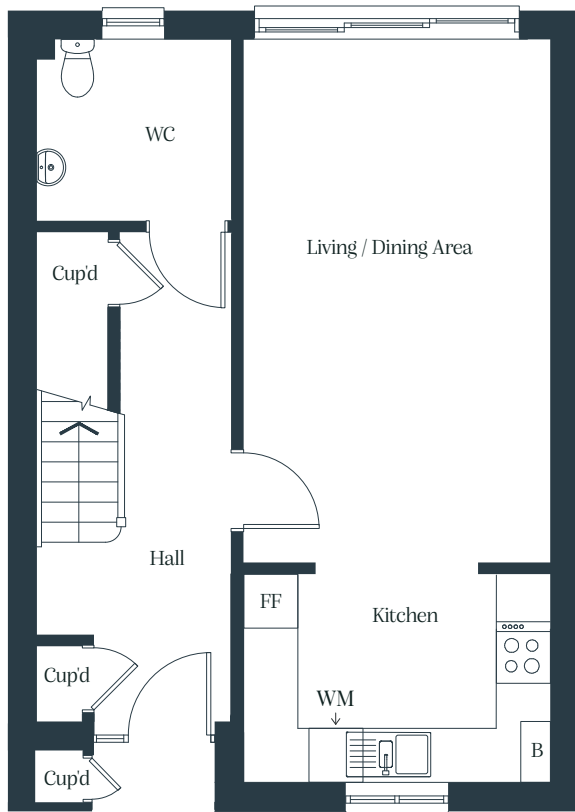

<b>Total Internal Area</b>	<b>93 sq m</b>
Kitchen	3.4m x 2.3m
Living / Dining area	3.4m x 5.7m
Bedroom 1	3.4m x 3.7m
Bedroom 2	2.6m x 4.3m
Bedroom 3	2.9m x 2.7m

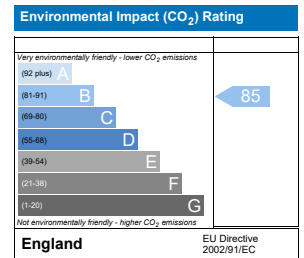
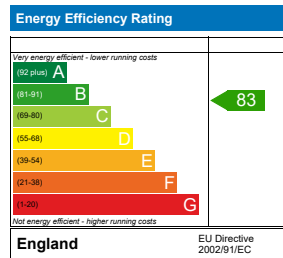

Cup'd = Cupboard, WC = Water Closet, B = Boiler, FF = Fridge Freezer, WM = Washing Machine

Floor plans shown are indicative only. All room sizes are approximate with maximum dimensions of finished items of furniture. Room layouts may be subject to minor modifications. Furniture, kitchen and bathroom layouts shown are indicative only\*. Measurement at widest point.

Parking under FOG is for private sale use.





# ASHVINE PARK CANTERBURY

## Three bedroom house

7 MILES WAY, THANINGTON, CANTERBURY, KENT

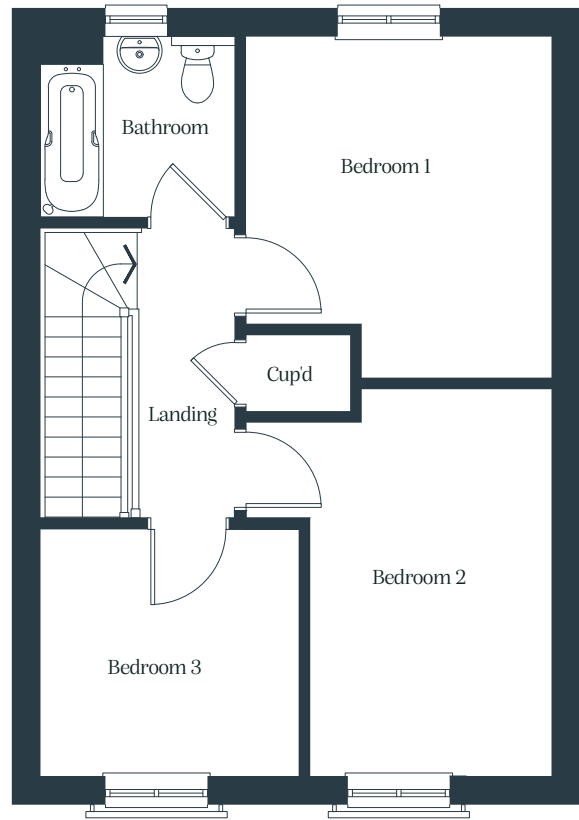
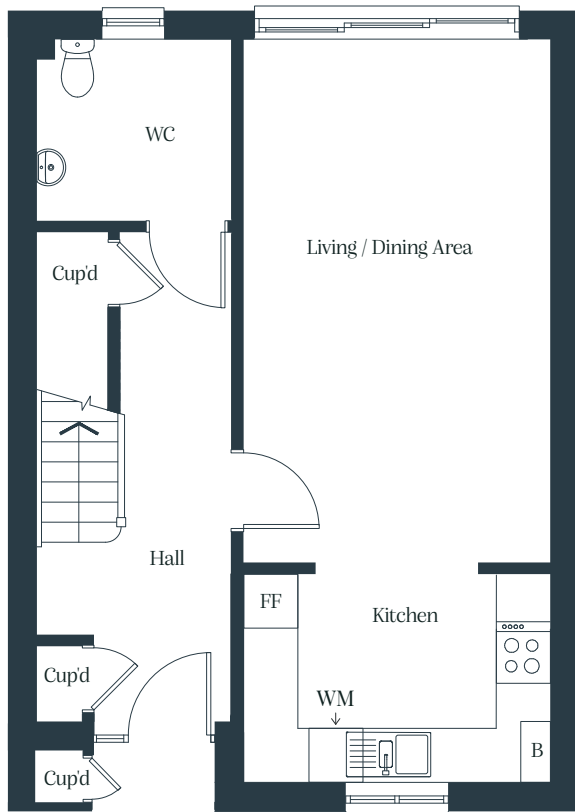

<b>Total Internal Area</b>	<b>93 sq m</b>
Kitchen	3.4m x 2.3m
Living / Dining area	3.4m x 5.7m
Bedroom 1	3.4m x 3.7m
Bedroom 2	2.6m x 4.3m
Bedroom 3	2.8m x 2.7m

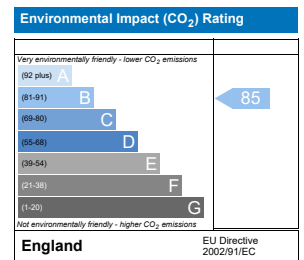
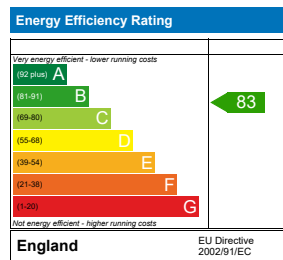

Cup'd = Cupboard, WC = Water Closet, B = Boiler, FF = Fridge Freezer, WM = Washing Machine

Floor plans shown are indicative only. All room sizes are approximate with maximum dimensions of finished items of furniture. Room layouts may be subject to minor modifications. Furniture, kitchen and bathroom layouts shown are indicative only\*. Measurement at widest point.

Parking under FOG is for private sale use.



# ASHVINE PARK CANTERBURY

## Three bedroom house

9 MILES WAY, THANINGTON, CANTERBURY, KENT

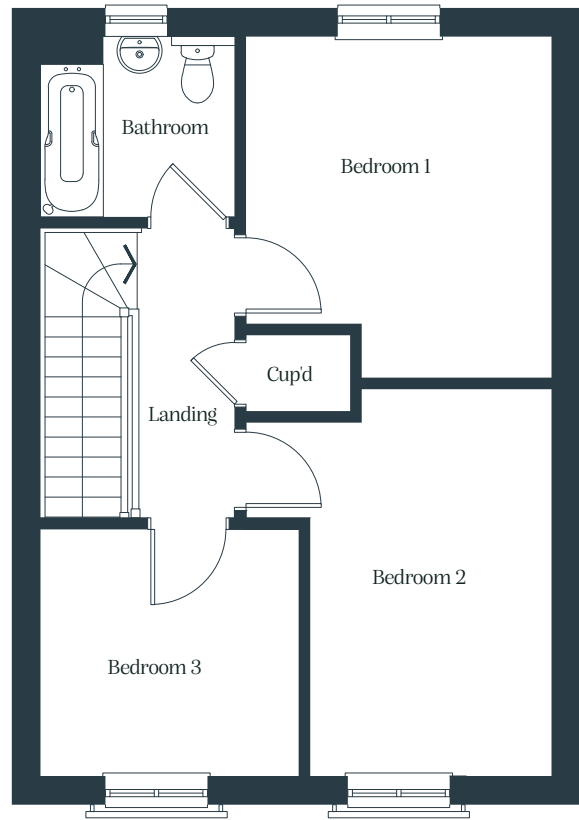
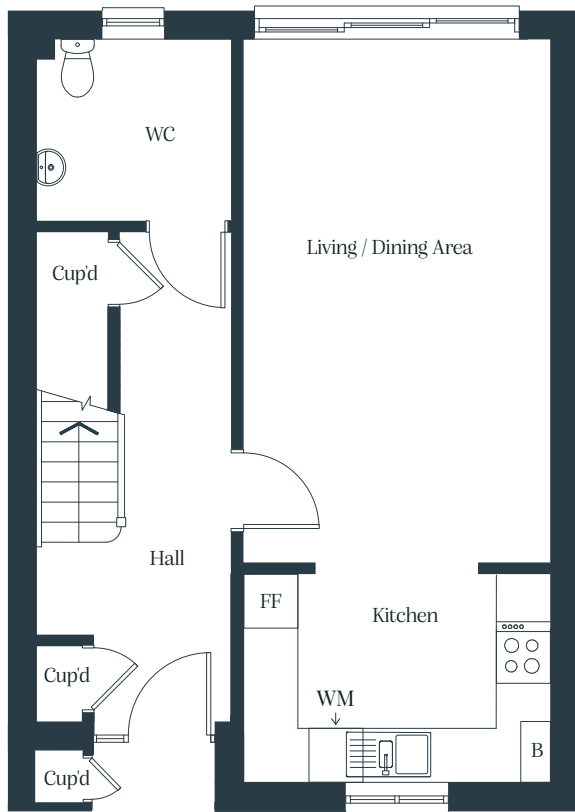

<b>Total Internal Area</b>	<b>93 sq m</b>
Kitchen	3.4m x 2.3m
Living / Dining area	3.4m x 5.7m
Bedroom 1	3.4m x 3.7m
Bedroom 2	2.6m x 4.3m
Bedroom 3	2.8m x 2.7m

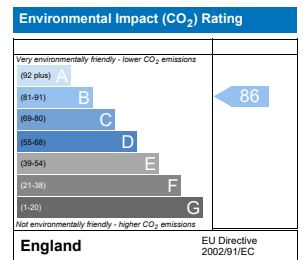
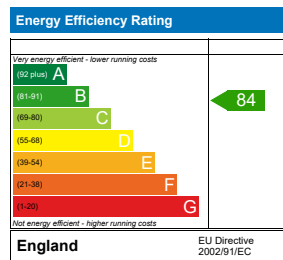

Cup'd = Cupboard, WC = Water Closet, B = Boiler, FF = Fridge Freezer, WM = Washing Machine

Floor plans shown are indicative only. All room sizes are approximate with maximum dimensions of finished items of furniture. Room layouts may be subject to minor modifications. Furniture, kitchen and bathroom layouts shown are indicative only\*. Measurement at widest point.

Parking under FOG is for private sale use.



# ASHVINE PARK CANTERBURY

## Three bedroom house

11 MILES WAY, THANINGTON, CANTERBURY, KENT

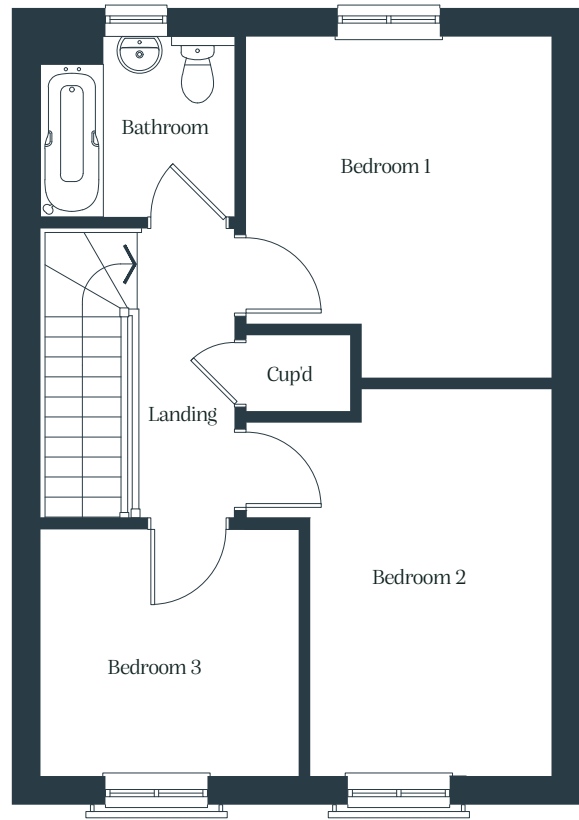
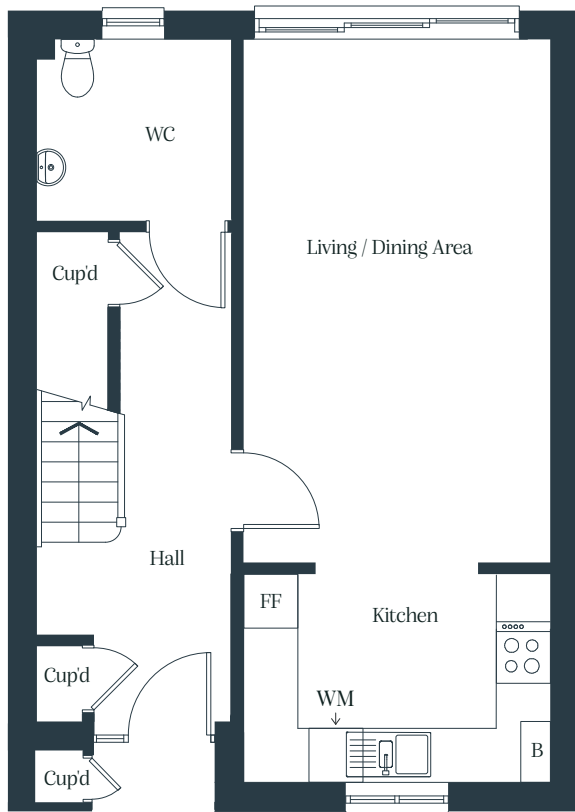

<b>Total Internal Area</b>	<b>93 sq m</b>
Kitchen	3.4m x 2.3m
Living / Dining area	3.4m x 5.7m
Bedroom 1	3.4m x 3.7m
Bedroom 2	2.6m x 4.3m
Bedroom 3	2.8m x 2.7m

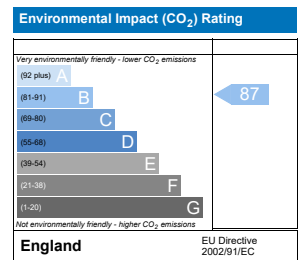
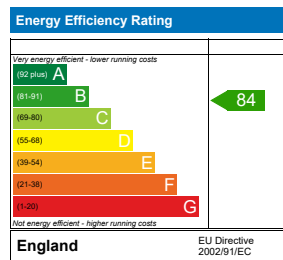

Cup'd = Cupboard, WC = Water Closet, B = Boiler, FF = Fridge Freezer, WM = Washing Machine

Floor plans shown are indicative only. All room sizes are approximate with maximum dimensions of finished items of furniture. Room layouts may be subject to minor modifications. Furniture, kitchen and bathroom layouts shown are indicative only\*. Measurement at widest point.

Parking under FOG is for private sale use.



# ASHVINE PARK CANTERBURY

## Three bedroom house

13 MILES WAY, THANINGTON, CANTERBURY, KENT

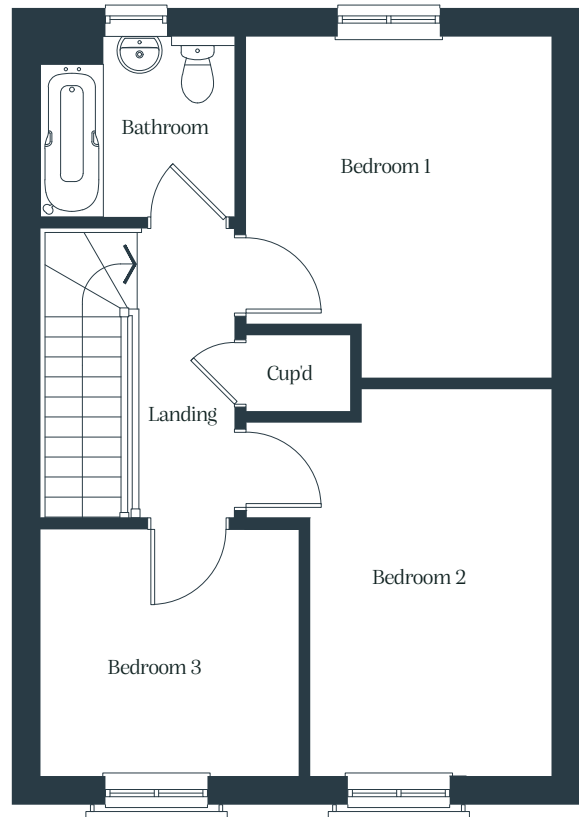
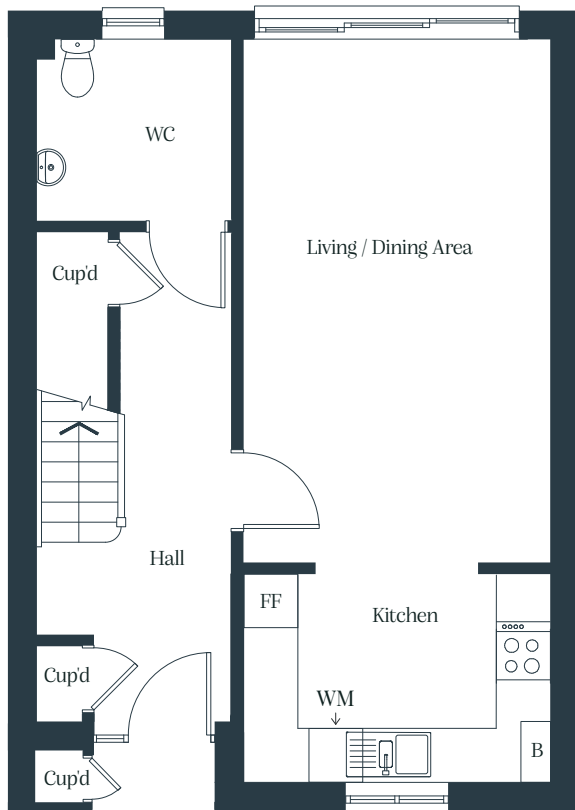

<b>Total Internal Area</b>	<b>93 sq m</b>
Kitchen	3.4m x 2.3m
Living / Dining area	3.4m x 5.7m
Bedroom 1	3.4m x 3.7m
Bedroom 2	2.6m x 4.3m
Bedroom 3	2.9m x 2.7m

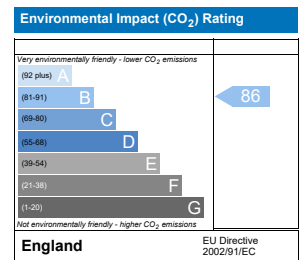
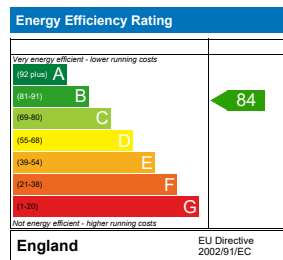

Cup'd = Cupboard, WC = Water Closet, B = Boiler, FF = Fridge Freezer, WM = Washing Machine

Floor plans shown are indicative only. All room sizes are approximate with maximum dimensions of finished items of furniture. Room layouts may be subject to minor modifications. Furniture, kitchen and bathroom layouts shown are indicative only\*. Measurement at widest point.

Parking under FOG is for private sale use.