

**1 BED: TYPE 8**

- No. 8            LEVEL 1
- No. 19          LEVEL 2
- No. 30          LEVEL 3
- No. 41          LEVEL 4
- No. 52          LEVEL 5

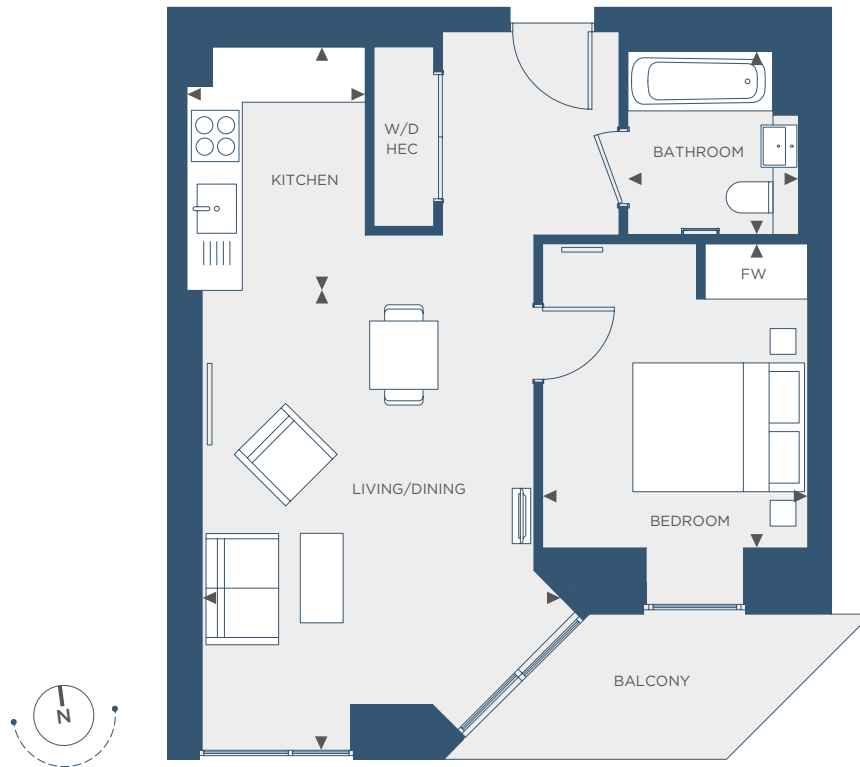

- FW**      Fitted Wardrobe
- W/D**     Washer/Dryer
- HEC**    Heating, Electrical Components

**Dimensions**

<b>Total Area</b>	<b>51.78 sq m</b>	<b>557 sq ft</b>
Kitchen	2090mm x 2850mm	6'10" x 9'4"
Living/Dining	3885mm x 5130mm	12'9" x 16'10"
Bedroom	3065mm x 3565mm	10'0" x 11'8"
Bathroom	1700mm x 2150mm	5'6" x 7'0"
<b>Balcony</b>	<b>5.57 sq m</b>	<b>59 sq ft</b>

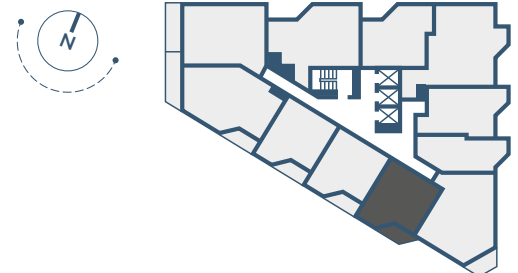

Important notice: this brochure and the description and measurements herein do not form part of any contract and whilst every effort has been made to ensure accuracy, this cannot be guaranteed. Prospective purchasers should not rely on this information but must get their solicitor to check the plans and specification attached to their contract. These particulars are believed to be correct at time of publishing but this cannot be guaranteed. Appliance locations may vary in certain apartments.