

The Rye

Compton Locks, Fenny Compton

Three Bedroom Home

Plots 2, 3, 16*, 17*, 40, 41, 55, 56, 57, 58, 70 & 71



Your place
to thrive

orbithomes.org.uk

📞 01843 653 501

✉️ ComptonLocks@orbit.org.uk

The Rye

Compton Locks, Fenny Compton

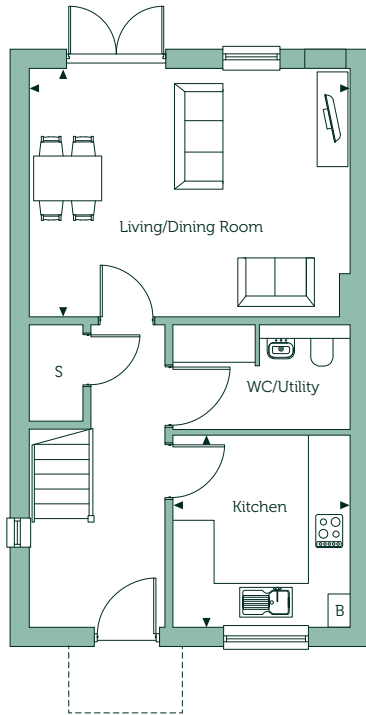

Ground Floor

Kitchen

9'3" x 9'8"

2.840m x 2.985m

Living/Dining Room

16'6" x 12'8"

5.073m x 3.895m

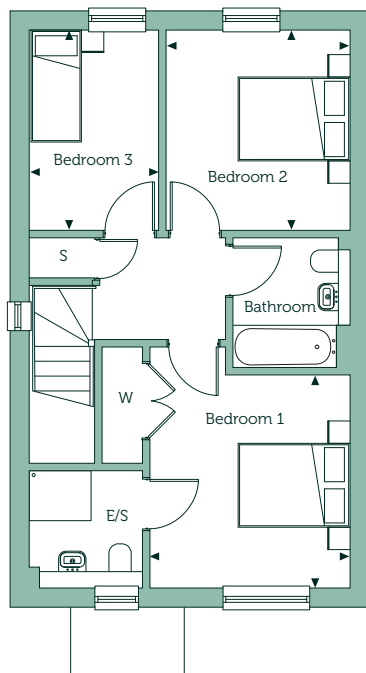

First Floor

Bedroom 1

10'6" x 10'10"

3.227m x 3.348m

Bedroom 2

9'7" x 10'3"

2.945m x 3.149m

Bedroom 3

6'6" x 10'3"

2.014m x 3.149m

Gross internal area

953 sq.ft

88.6 sq.m

Key

B Boiler S Store Cupboard W Fitted Wardrobe E/S En Suite

Floorplans are not drawn to scale. Measurements are taken from areas marked with an arrow. They are maximum approximate dimensions and given as a guide only. These should not be used as a basis for purchasing flooring or furniture. Orbit reserve the right to alter plans, specifications, position of doors and windows and change tenure subject to demand without prior notice. External elevations vary from plot to plot. Please ask your Sales Consultant for current information when reserving your new home. Information correct at time of going to print. Computer generated image overleaf. *Plots are handed.