



welcome to

# The Maltings

Beeston • Nottinghamshire



A modern development of  
2 & 3 bedroom new homes  
for shared ownership sale

welcome to your new home

# The Maltings, Beeston

Nottinghamshire NG9

2 Bedroom Semi-Detached House | **Plots 7, 8, 11, 12, 15, 16, 21 & 22**

platform   
**home**  
O W N E R S H I P



## Kitchen

- Contemporary kitchen
- Stainless steel oven
- Vinyl flooring
- Space for washing machine and fridge

## Bathroom

- Three piece suite
- Family bathroom
- Complimentary tiling
- Downstairs WC
- Vinyl flooring

## General

- Range of local amenities
- Excellent transport links
- Allocated parking
- 10 year build warranty
- Turfed rear garden

CGI shown is for Illustrations purposes only.

# The Maltings, Beeston

Nottinghamshire NG9

2 Bedroom Semi-Detached House | **Plots 7, 8, 11, 12, 15, 16, 21 & 22**

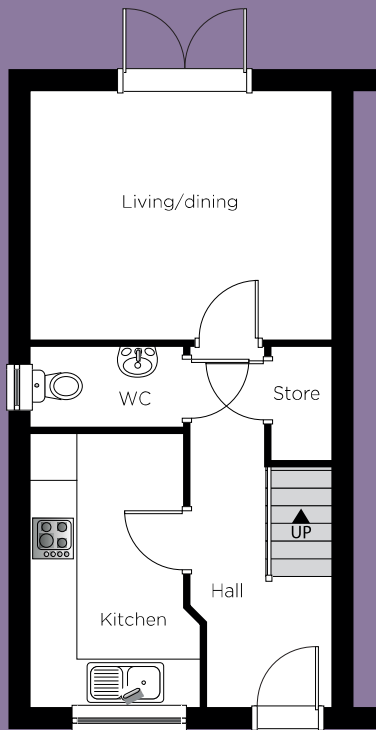

Ground Floor

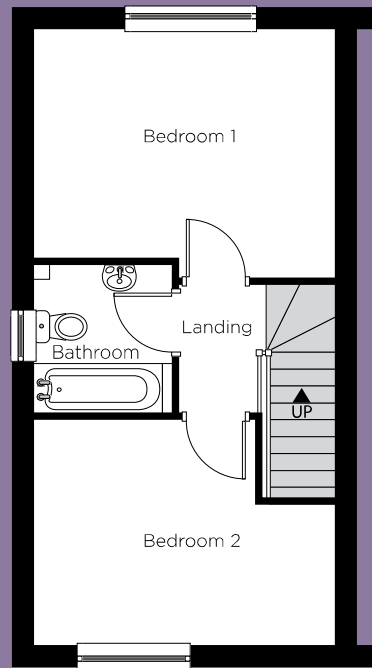

First Floor

**Please note:**  
Some plots will be the opposite floor layout to shown.

## Ground Floor

Kitchen 3.80m x 2.38m (max)  
12' 6" x 7' 10" (max)

Living/dining 4.12m x 3.47m (max)  
13' 6" x 11' 5" (max)

## First Floor

Bed 1 4.12m x 3.47m (max)  
13' 6" x 11' 5" (max)

Bed 2 4.12m x 3.14m (max)  
13' 6" x 10' 3" (max)

Bathroom 2.14m x 1.93m (max)  
7' 0" x 6' 4" (max)

## Total Floor Area:

70.04m<sup>2</sup>/753.90 sq.ft

Kitchen layouts are indicative only. Please consult with Platform staff for specific plans, room dimensions and kitchen layouts. The information is for guidance only and is not to be relied on as statements or representations of fact and they do not make or give representation or warrant whatsoever and do not form part of any contract. All room measurements shown in metric first followed by imperial underneath.

welcome to your new home

# The Maltings, Beeston

Nottinghamshire NG9

3 Bedroom Semi-Detached House | **Plots 9, 10, 13, 14, 17, 18, 19 & 20**

platform   
**home**  
OWNERSHIP



## Kitchen

- Contemporary kitchen
- Stainless steel oven
- Vinyl flooring
- Space for washing machine and fridge

## Bathroom

- Three piece suite
- Family bathroom
- Complimentary tiling
- Downstairs WC
- Vinyl flooring

## General

- Range of local amenities
- Excellent transport links
- Allocated parking
- 10 year build warranty
- Turfed rear garden

CGI shown is for Illustrations purposes only.

# The Maltings, Beeston

Nottinghamshire NG9

3 Bedroom Semi-Detached House | **Plots 9, 10, 13, 14, 17, 18, 19 & 20**

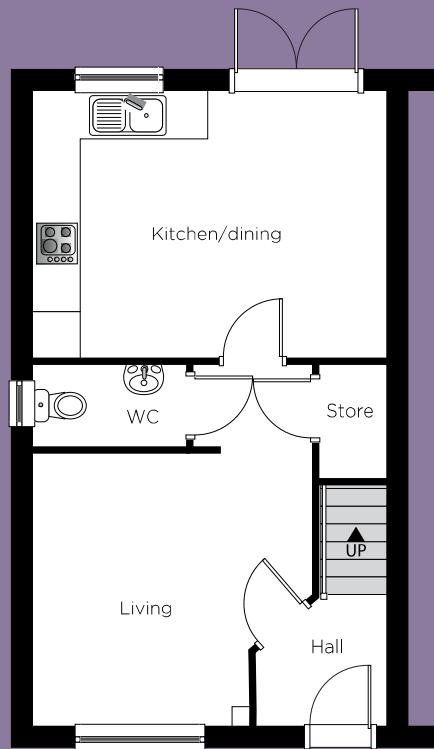

Ground Floor

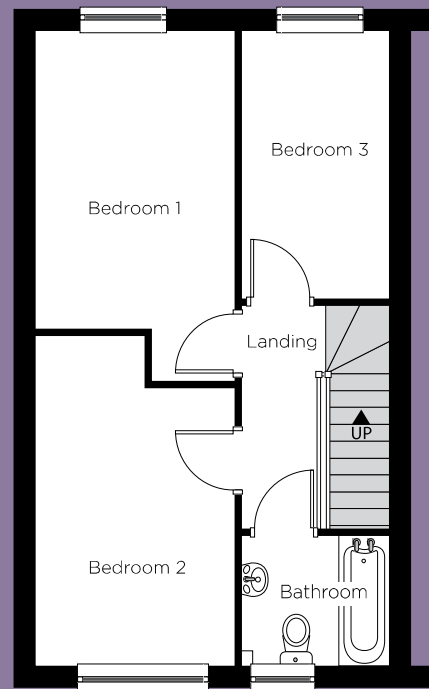

First Floor

**Please note:**  
Some plots will be the opposite floor layout to shown.

## Ground Floor

Kitchen/ dining	4.85m 15' 11"	x	3.69m 12' 1"	(max)
Living	3.90m 12' 10"	x	3.78m 12' 5"	(max)

## First Floor

Bed 1	4.84m 15' 10"	x	2.77m 9' 1"	(max)
Bed 2	4.57m 14' 12"	x	2.77m 9' 1"	(max)
Bed 3	3.69m 12' 1"	x	2.08m 6' 10"	(max)
Bathroom	2.08m 6' 10"	x	1.81m 5' 11"	(max)

## Total Floor Area:

84.67m<sup>2</sup>/911.37 sq.ft

Kitchen layouts are indicative only. Please consult with Platform staff for specific plans, room dimensions and kitchen layouts. The information is for guidance only and is not to be relied on as statements or representations of fact and they do not make or give representation or warrant whatsoever and do not form part of any contract. All room measurements shown in metric first followed by imperial underneath.

# The Maltings, Beeston

Nottinghamshire NG9

Site plan

platform   
**home**  
OWNERSHIP



## Development

-  2 Bedroom Semi-Detached  
Plots 7, 8, 11, 12, 15, 16, 21  
& 22
-  3 Bedroom Semi-Detached  
Plots 9, 10, 13, 14, 17, 18, 19  
& 20

Part of the **platform**  
 housing group

For further details please contact our sales team on: **0333 200 7304** or email: [sales@platformhg.com](mailto:sales@platformhg.com)

**Contact Us:**  [www.platformhomeownership.com](http://www.platformhomeownership.com) |  [facebook.com/PlatformHomeOwnership](https://facebook.com/PlatformHomeOwnership)  
 [twitter.com/PlatformNewHome](https://twitter.com/PlatformNewHome) |  [instagram.com/platformhomeownership](https://instagram.com/platformhomeownership)

# The Maltings, Beeston

Nottinghamshire NG9

House prices for all plots available



## Houses available

Plot	House Type	Postal Address	Handover	100% Price	40% Share Value	Monthly Rent	Service Charge	Sold/Reserved
7	2 Bed Semi-Detached House	80 Dovecote Lane, Beeston, Nottingham NG9 1JG	June/July 2023	£270,000	£108,000	£371.25	£42.48	
8	2 Bed Semi-Detached House	82 Dovecote Lane, Beeston, Nottingham NG9 1JG	June/July 2023	£270,000	£108,000	£371.25	£42.48	
9	3 Bed Semi-Detached House	84 Dovecote Lane, Beeston, Nottingham NG9 1JG	June/July 2023	£340,000	£136,000	£467.50	£42.48	
10	3 Bed Semi-Detached House	86 Dovecote Lane, Beeston, Nottingham NG9 1JG	June/July 2023	£340,000	£136,000	£467.50	£42.48	
11	2 Bed Semi-Detached House	2 Maltings Crescent, Beeston, Nottingham NG9 1FU	July/August 2023	£270,000	£108,000	£371.25	£42.48	RESERVED
12	2 Bed Semi-Detached House	4 Maltings Crescent, Beeston, Nottingham NG9 1FU	July/August 2023	£270,000	£108,000	£371.25	£42.48	RESERVED
13	3 Bed Semi-Detached House	6 Maltings Crescent, Beeston, Nottingham NG9 1FU	July/August 2023	£340,000	£136,000	£467.50	£42.48	
14	3 Bed Semi-Detached House	8 Maltings Crescent, Beeston, Nottingham NG9 1FU	July/August 2023	£340,000	£136,000	£467.50	£42.48	
15	2 Bed Semi-Detached House	10 Maltings Crescent, Beeston, Nottingham NG9 1FU	July/August 2023	£270,000	£108,000	£371.25	£42.48	
16	2 Bed Semi-Detached House	12 Maltings Crescent, Beeston, Nottingham NG9 1FU	July/August 2023	£270,000	£108,000	£371.25	£42.48	RESERVED
17	3 Bed Semi-Detached House	7 Maltings Crescent, Beeston, Nottingham NG9 1FU	July/August 2023	£340,000	£136,000	£467.50	£54.91	RESERVED
18	3 Bed Semi-Detached House	5 Maltings Crescent, Beeston, Nottingham NG9 1FU	July/August 2023	£340,000	£136,000	£467.50	£54.91	
19	3 Bed Semi-Detached House	3 Maltings Crescent, Beeston, Nottingham NG9 1FU	July/August 2023	£340,000	£136,000	£467.50	£54.91	
20	3 Bed Semi-Detached House	1 Maltings Crescent, Beeston, Nottingham NG9 1FU	July/August 2023	£340,000	£136,000	£467.50	£54.91	RESERVED
21	2 Bed Semi-Detached House	88 Dovecote Lane, Beeston, Nottingham NG9 1JG	July/August 2023	£270,000	£108,000	£371.25	£54.91	RESERVED
22	2 Bed Semi-Detached House	90 Dovecote Lane, Beeston, Nottingham NG9 1JG	July/August 2023	£270,000	£108,000	£371.25	£54.91	RESERVED

For further details please contact our sales team on: **0333 200 7304** or email: [sales@platformhg.com](mailto:sales@platformhg.com)

**Contact Us:**  [www.platformhomeownership.com](http://www.platformhomeownership.com) |  [facebook.com/PlatformHomeOwnership](https://facebook.com/PlatformHomeOwnership)

 [twitter.com/PlatformNewHome](https://twitter.com/PlatformNewHome) |  [instagram.com/platformhomeownership](https://instagram.com/platformhomeownership)

For details contact our sales team  
on **0333 200 7304**  
or email: **sales@platformhg.com**

**Contact Us:**

 [www.platformhomeownership.com](http://www.platformhomeownership.com)

 [facebook.com/PlatformHomeOwnership](https://facebook.com/PlatformHomeOwnership)

 [twitter.com/PlatformNewHome](https://twitter.com/PlatformNewHome)

 [instagram.com/platformhomeownership](https://instagram.com/platformhomeownership)

Scheme administered by Platform Housing Group  
1700 Solihull Parkway, Birmingham Business Park, Solihull, B37 7YD.

Part of the **platform**  
 housing group