

The Aster

Orbit Homes at Beaumont Park

Two Bedroom Home

Plots 67, 68, 69, 146, 147, 148 & 149



Your place
to thrive

orbithomes.org.uk
✉ homes@orbit.org.uk

The Aster

Orbit Homes at Beaumont Park

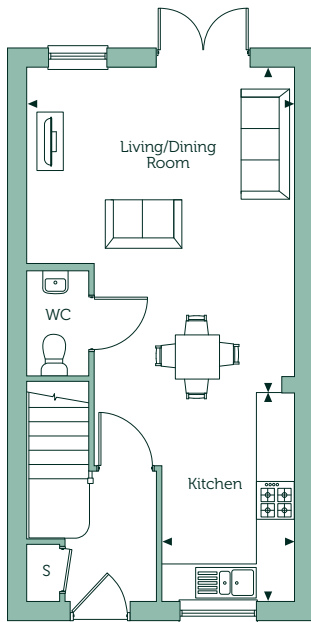

Ground Floor

Kitchen

6'9" x 11'7"

2.07m x 3.55m

Living/Dining Room

13'9" x 16'3"

4.19m x 4.97m

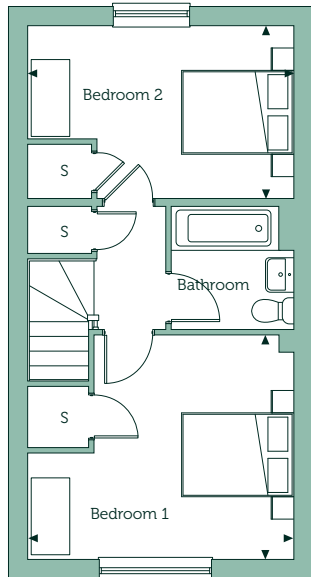

First Floor

Bedroom 1

13'9" x 9'0"

4.19m x 2.76m

Bedroom 2

13'9" x 11'8"

4.19m x 3.56m

Gross internal area

764 sq ft

71.03 sq m

Key

S Store Cupboard

Floorplans are not drawn to scale. Measurements are taken from areas marked with an arrow. They are maximum approximate dimensions and given as a guide only. These should not be used as a basis for purchasing flooring or furniture. Orbit reserve the right to alter plans, specifications, position of doors and windows and change tenure subject to demand without prior notice. External elevations vary from plot to plot. Please ask your Sales Consultant for current information when reserving your new home. Information correct at time of going to print. Computer generated image overleaf.