



Flagshaw Pastures

The Rosliston 3 bedroom house

Plots 83, 84, 85 & 86 — semi-detached
Plots 84 & 86 — handed

83.5 sq m / 898 sq ft

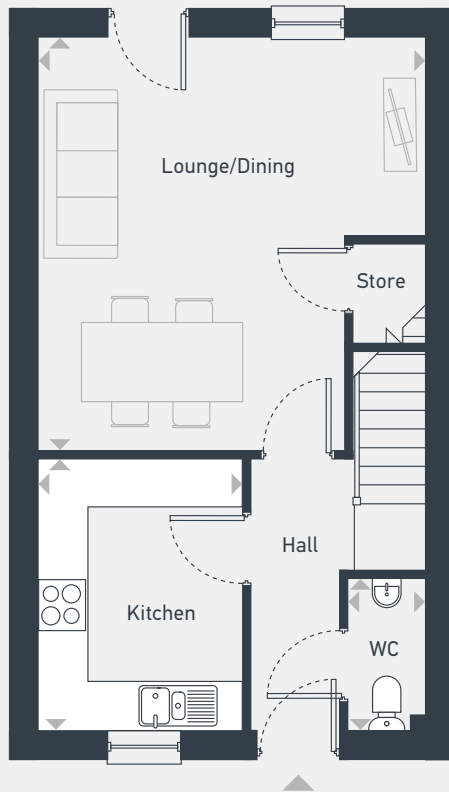

GROUND FLOOR

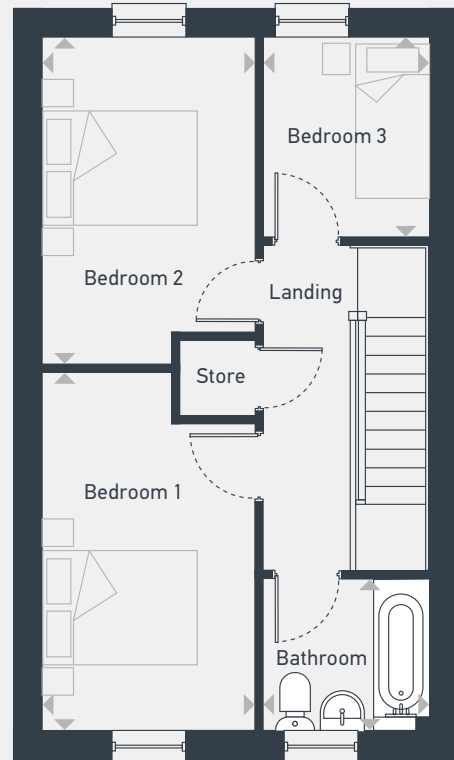

FIRST FLOOR

DIMENSIONS	m	ft
Lounge/Dining	5.16m x 4.84m	16'11" x 13'1"
Kitchen	3.40m x 2.57m	11'2" x 8'5"

DIMENSIONS	m	ft
Bedroom 1	4.64m x 2.68m	15'3" x 8'10"
Bedroom 2	3.93m x 2.53m	12'11" x 8'4"
Bedroom 3	2.84m x 2.25m	9'4" x 7'5"
Bathroom	2.01m x 1.97m	6'7" x 6'6"



07973 813 331 | southyorkshire@lslnewhomes.co.uk

Flagshaw Pastures, Ashbourne Road, Kirk Langley, Derbyshire DE6 4NS

Please note: All CGIs, layouts and floor plans, configurations, maps and information are intended for guidance only and accuracy of this information cannot be relied upon by prospective purchasers who must make their own enquiries to satisfy themselves by inspection or otherwise as to the correct detail. Sizes and dimensions approximate and subject to change.