

3 Bedroom Floor Plan

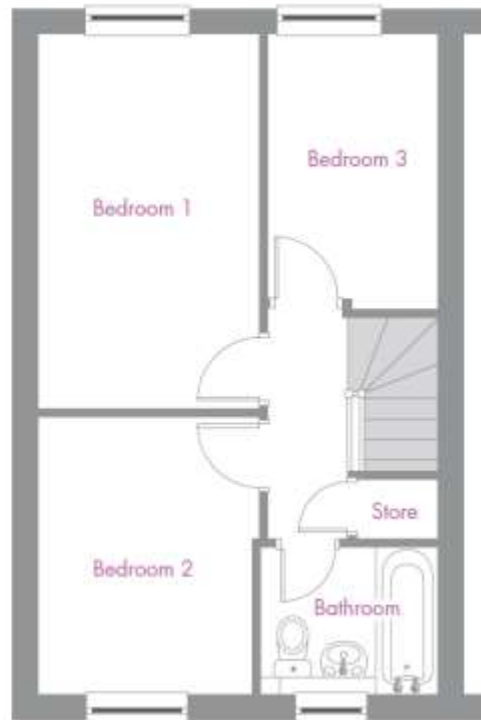

3 Bedroom Semi-Detached House

Living/kitchen	7.80m x 4.70m	25'7" x 15'5"
Bedroom 1	4.44m x 2.63m	14'7" x 8'8"
Bedroom 2	3.29m x 2.53m	10'10" x 8'4"
Bedroom 3	3.26m x 2.01m	10'8" x 6'7"
Bathroom	2.11m x 1.73m	6'11" x 5'8"

Total Floor Area: 73.32m² - 789.21 sq.ft

Please note: All dimensions are taken from the widest and longest points of each room. Some properties will be 'handed' (mirror image) to floorplan shown.