

### 3 Bedroom Floor Plan

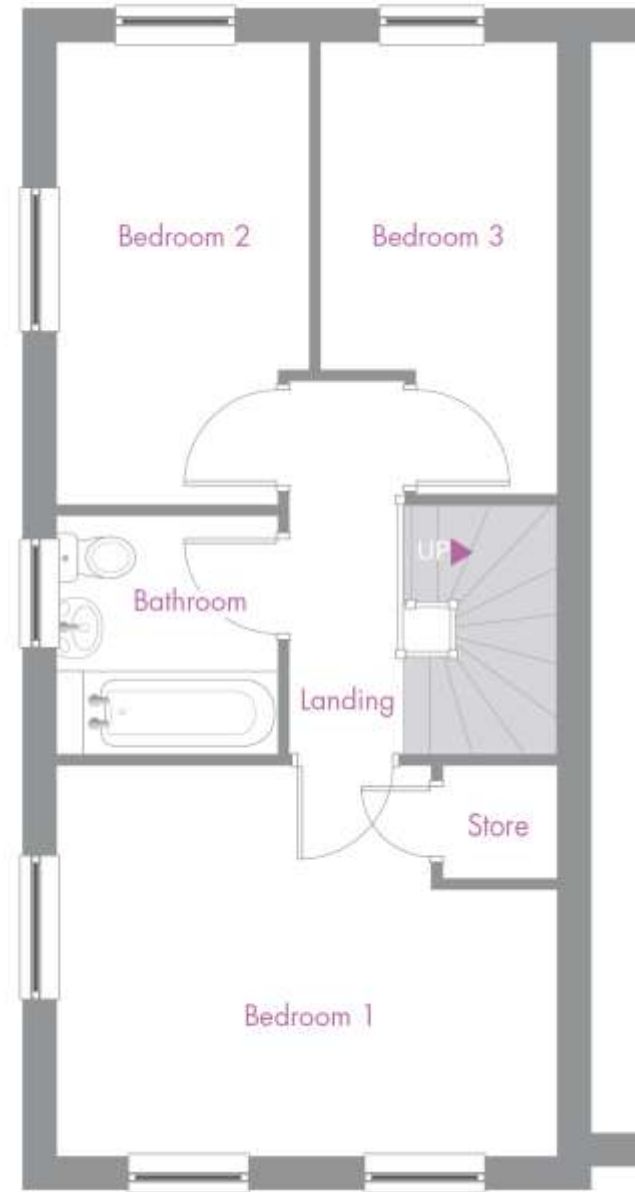

### 3 Bedroom Floor Plan

3 Bedroom Semi-Detached House		
Kitchen/Dining	4.45m x 4.04m	14'7" x 13'3"
Living	4.45m x 3.50m	14'7" x 11'6"
Bedroom 1	4.45m x 3.50m	14'7" x 11'6"
Bedroom 2	4.14m x 2.26m	13'7" x 7'5"
Bedroom 3	3.99m x 2.12m	13'1" x 6'11"
Bathroom	2.18m x 1.98m	7'2" x 6'6"

Total Floor Area: 87.8m<sup>2</sup> - 984.07 sq.ft

**Please note:** All dimensions are taken from the widest and longest points of each room. Some properties will be 'handed' (mirror image) to floorplan shown.