

3 Bedroom Floor Plan

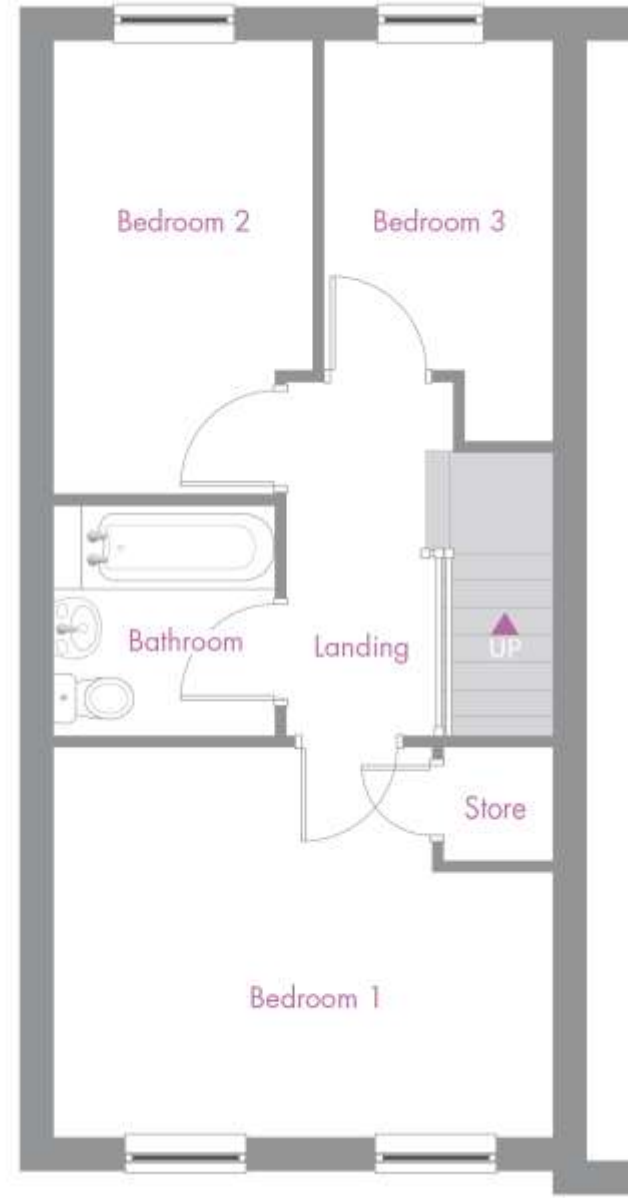

3 Bedroom Floor Plan

3 Bedroom Semi-Detached House		
Kitchen/Dining	4.47m x 3.38m	14'8" x 11'1"
Living	4.68m x 3.45m	15'4" x 11'4"
Bedroom 1	4.47m x 3.46m	14'8" x 11'4"
Bedroom 2	4.04m x 2.30m	13'3" x 7'7"
Bedroom 3	3.57m x 2.09m	11'9" x 6'10"
Bathroom	2.08m x 1.98m	6'10" x 6'6"

Total Floor Area: 85.8m² - 923.54 sq.ft

Please note: All dimensions are taken from the widest and longest points of each room. Some properties will be 'handed' (mirror image) to floorplan shown.