

The Foundry

Amberley 3 bedroom home

84.36 sq m / 908 sq ft



GROUND FLOOR

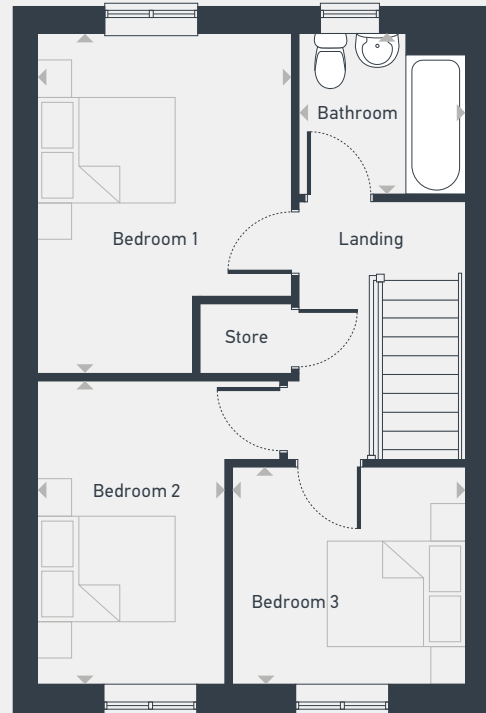

FIRST FLOOR

DIMENSIONS	m	ft
Living Room	5.15m x 2.89m	16'11" x 9'6"
Kitchen/Dining	4.98m x 2.96m	16'4" x 9'9"

DIMENSIONS	m	ft
Bedroom 1	4.15m x 3.06m	13'7" x 10'0"
Bedroom 2	3.75m x 2.26m	12'4" x 7'5"
Bedroom 3	2.82m x 2.69m	9'3" x 8'10"
Bathroom	2.00m x 1.96m	6'7" x 6'5"



01278 310 138 | foundry@placesforpeople.co.uk
Regal Walk, Kings Down, Bridgwater, Somerset, TA6 4FL

Please note: All layouts and floor plans, configurations, maps and information are intended for guidance only and accuracy of this information cannot be relied upon by prospective purchasers who must make their own enquiries to satisfy themselves by inspection or otherwise as to the correct detail. Sizes and dimensions approximate and subject to change.