

The Oak

Westwood Point, Margate (Phase 5b)

Three Bedroom Home

Plots: 210, 215(h), 227(h), 232, 244(h) & 270(h)

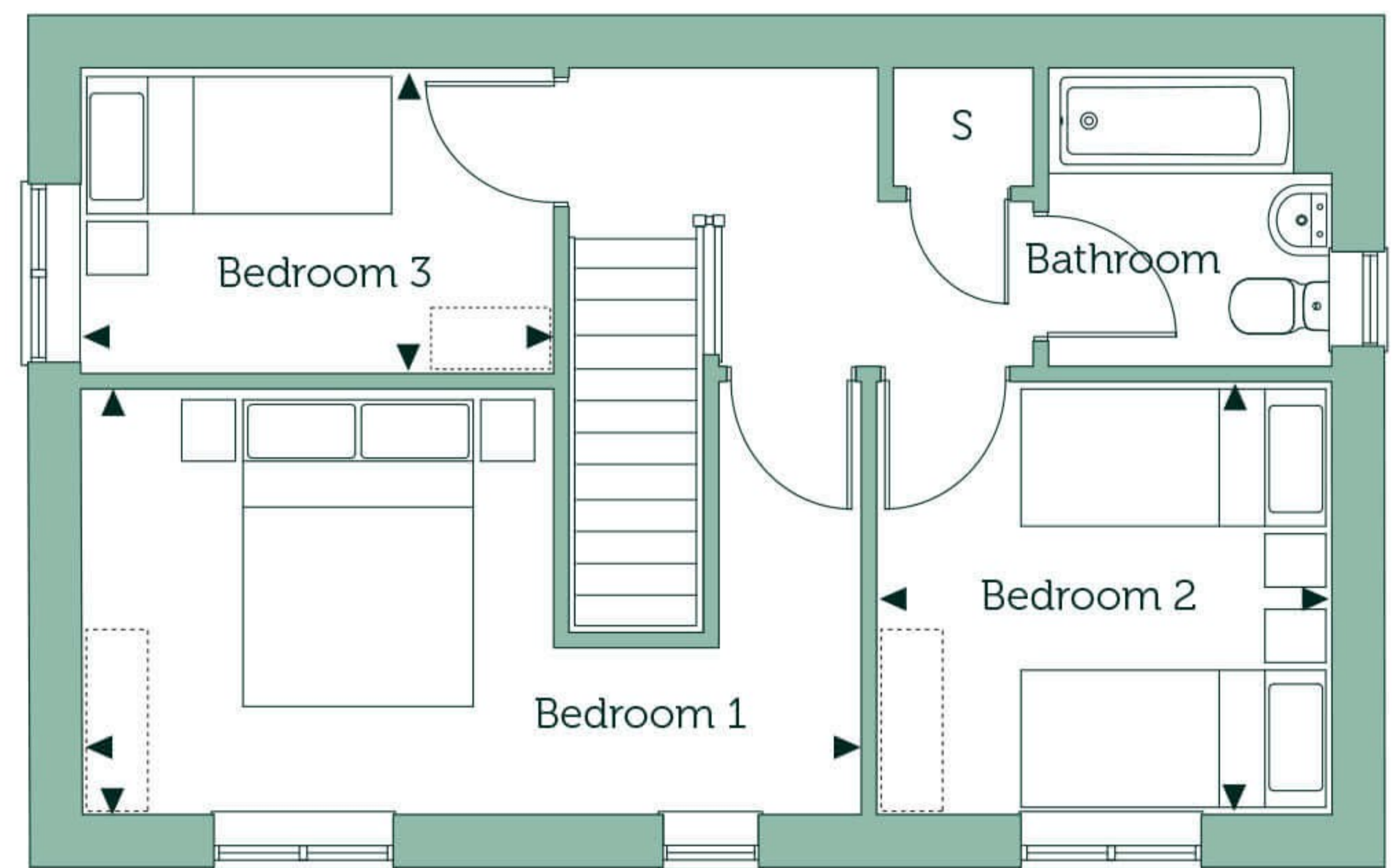
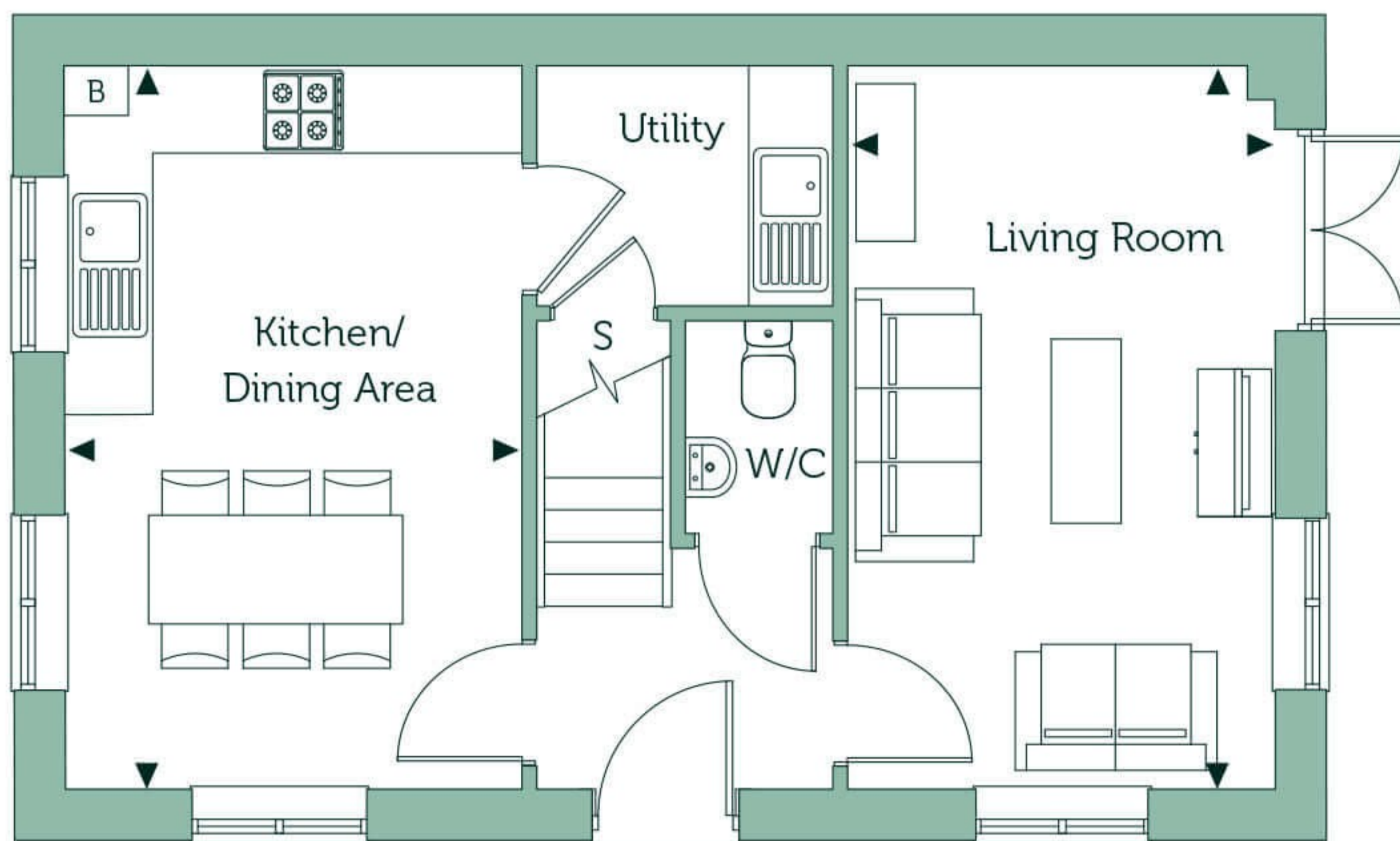

Ground Floor

Kitchen/Dining Area

16'5" x 10'5" 5.02m x 3.18m

Living Room

16'5" x 9'10" 5.02m x 3.00m

First Floor

Bedroom 1

9'5" x 17'3" 2.87m x 5.28m

Bedroom 2

9'7" x 10'1" 2.92m x 3.07m

Bedroom 3

6'9" x 10'5" 2.06m x 3.18m

Gross internal area

914 sq ft 84.9 sq m

Key

B Boiler S Store Cupboard  Wardrobe space

(h) handed plots. Floorplans are not drawn to scale. Measurements are taken from areas marked with an arrow. They are maximum approximate dimensions and given as a guide only. These should not be used as a basis for purchasing flooring or furniture. Orbit reserve the right to alter plans, specifications, position of doors and windows and change tenure subject to demand without prior notice. External elevations vary from plot to plot. Please ask your Sales Consultant for current information when reserving your new home. Information correct at time of going to print. Computer generated image overleaf.