

Type B

3 bedroom
house

Plot Address

78 11 Swan Drive

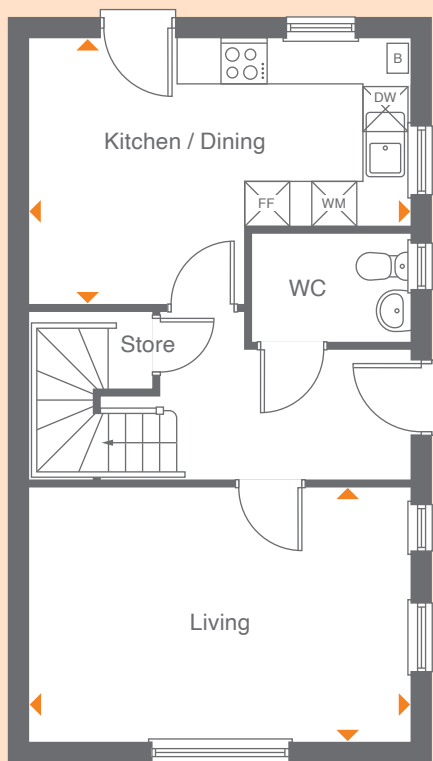

Ground Floor

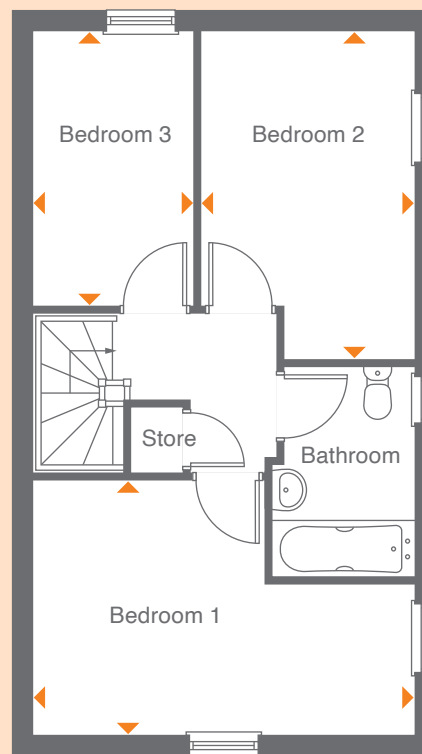

First Floor

Gross Internal

Floor Area

93 m²

1001 sq ft

Room	Metric	Imperial	
Kitchen / Dining	5.05 x 3.54 m	16'7" x 11'7"	FF Fridge/Freezer
Living Room	5.05 x 3.35 m	16'7" x 11'0"	DW Dishwasher
Bedroom 1	5.05 x 3.40 m	16'7" x 11'2"	WD Washing Machine
Bedroom 2	4.35 x 2.83 m	14'3" x 9'3"	B Boiler
Bedroom 3	3.69 x 2.16 m	12'1" x 7'1"	

All floor plans in this brochure are for general guidance only. All room dimensions are subject to a plus/minus 5% tolerance. Measurements are taken from plans representing the largest cross-section of each room - the actual build may vary. Any dimensions shown are not intended to be used for carpet sizes, appliances, spaces or items of furniture. These particulars do not constitute any part of an offer or contract with regard to the specifications.