

# Two bed house

Plots 4, 5, and 9

- Living room** 4.9m x 2.9m
- Kitchen / dining** 5.2m x 2.5m
- Bedroom one** 5.2m x 3.1m
- Bedroom two** 4.3m x 2.8m

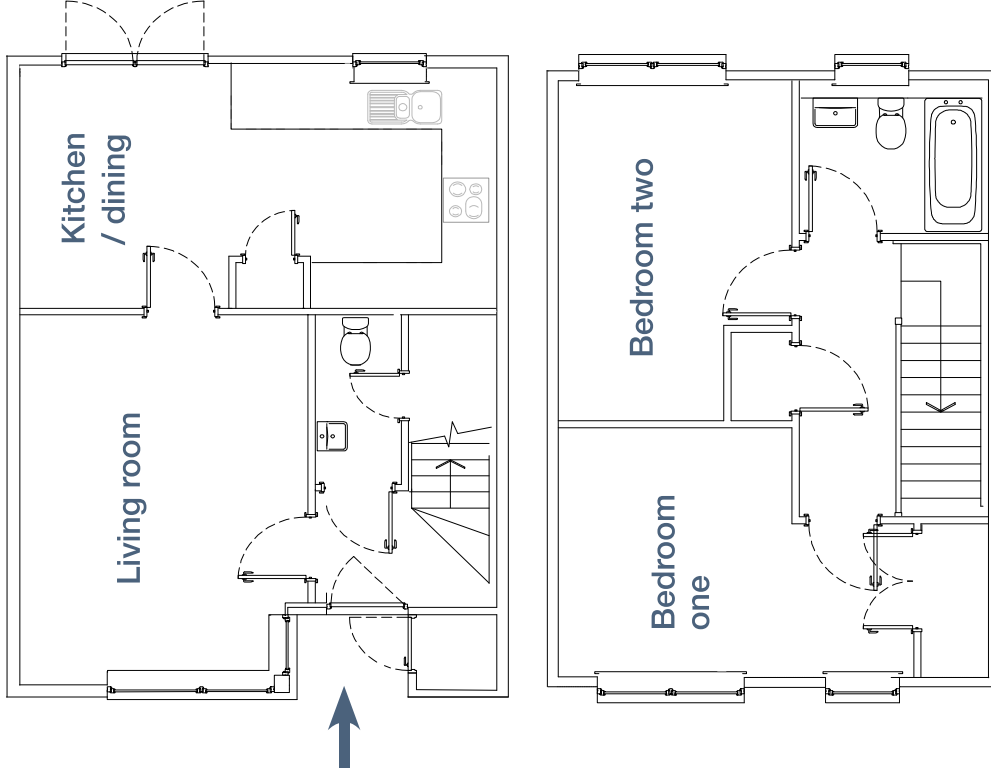

Floorplans shown are indicative only. All room sizes are approximate with maximum dimensions of finished measurements. These plans provide indicative details of the property including kitchen/bathroom layouts, balconies/gardens, etc. All dimensions indicated are approximate and should not be relied upon for carpet sizes or items of furniture. Moat reserves the right to make changes to these plans prior to exchange of contracts. \*Indicative measurement at widest point.