

Prices from  
**£75,000\***

**Hastoe**  
Group

Shared Ownership Existing Sale

# Foxglove Way, Bridport, DT6 4SQ



**Two bedroom,  
terraced house for  
sale on a shared  
ownership basis at  
40% minimum share**

- Allocated parking space
- Fitted kitchen
- Gas central heating
- Double glazing
- Over bath shower



\*This represents a 40% share of the full market value (£280,000), please see the affordability schedule for full details of costs available on our website. Please note all costs in this leaflet are intended as a guide and may differ from the actual cost at the time of sale.

**Full Market Price** £280,000

**Minimum Share** 40%

**Share Value** £112,000

**Monthly Rent** £258.47

**Service Charge PCM** £19.99  
Including buildings insurance

**Total Monthly Charge** £278.46

Next Rent Increase Due November 24

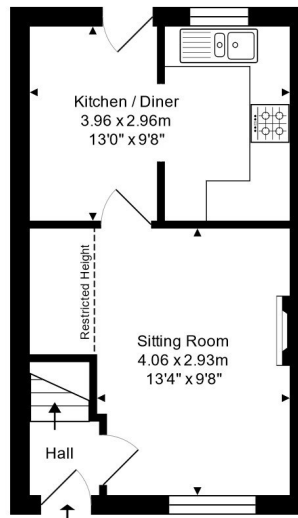

Ground Floor

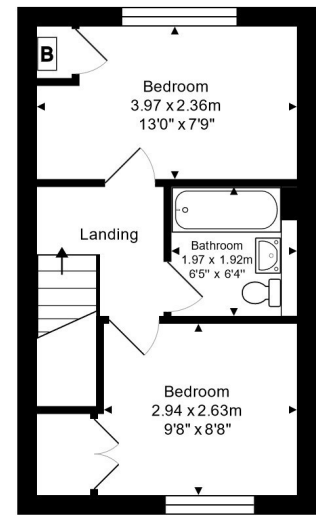

First Floor

Total Area: 56.5 m<sup>2</sup> ... 609 ft<sup>2</sup>  
 Not to scale. Measurements are  
 approximate and for guidance only.



This home is an ideal opportunity to get on to the property ladder with Hastoe. This property is being sold under the shared ownership scheme whereby you purchase a share in the property and pay a reduced rent on the remaining Hastoe equity.

## Purchaser Requirements

You must:

- Be eligible for the shared ownership scheme
- Have a local connection to the area.
- Be a first time buyer or not currently named on a mortgage.
- Demonstrate you meet the minimum Income requirements.
- Demonstrate a deposit sufficient to obtain a mortgage for the property.

**Contact Hastoe**

**sales@hastoe.com**

**Apply online at : [www.hastoesales.com](http://www.hastoesales.com)**

These particulars have been produced in good faith. They are a general guide only and do not constitute any part of an offer or contract. Property elevations and specification may vary from plot to plot; individual features such as windows, doors, heating and electrical may have changed from the details shown. Measurements provided are for guidance only and should not be used to select furnishing of fixtures. These particulars should be treated as a general guide only and cannot be relied upon as accurately describing any of the specified matters by an order made under the Property Misdescriptions Act 1991. Prices featured are correct at the time of going to print.