

Greenwood Gardens Lower Herne Village

The Aspen 2 bedroom home

Plots as drawn: 15 and 16

80.89 sq.m / 871 sq.ft

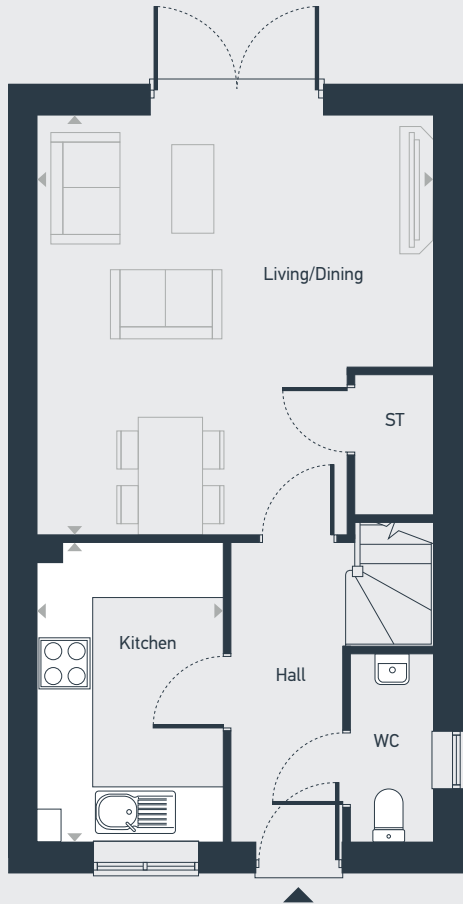

GROUND FLOOR

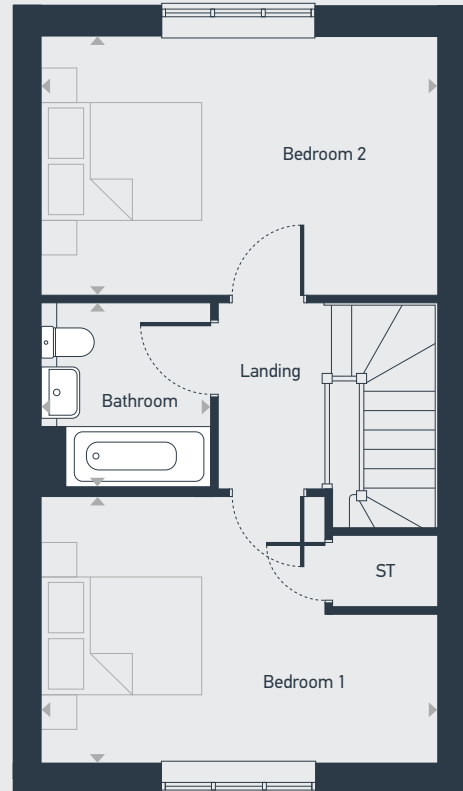

FIRST FLOOR

ST: Storage

DIMENSIONS	m	ft
Kitchen	3.53m x 2.20m	11'7" x 7'3"
Living/Dining	4.95m x 4.68m	15'4" x 16'3"

DIMENSIONS	m	ft
Bedroom 1	4.68m x 3.06m	15'4" x 10'0"
Bedroom 2	4.68m x 3.14m	10'0" x 9'11"
Bathroom	2.19m x 2.04m	7'1" x 6'6"



01227 387085 | greenwoodgardens@placesforpeople.co.uk | placesforpeople.co.uk/greenwoodgardens
Furrows Drive, Lower Herne CT6 7FH

Please note: All layouts and floor plans, configurations, maps and information are intended for guidance only and accuracy of this information cannot be relied upon by prospective purchasers who must make their own enquiries to satisfy themselves by inspection or otherwise as to the correct detail.