

Newcourt Edge

The Beech 3 bedroom home



Newcourt Edge

The Beech 3 bedroom home

Plots as drawn: 2, 52, 60, 70, 90, 94, 117
Plots handed: 3, 53, 61, 71, 89, 93

104.47 sq m / 1124 sq ft

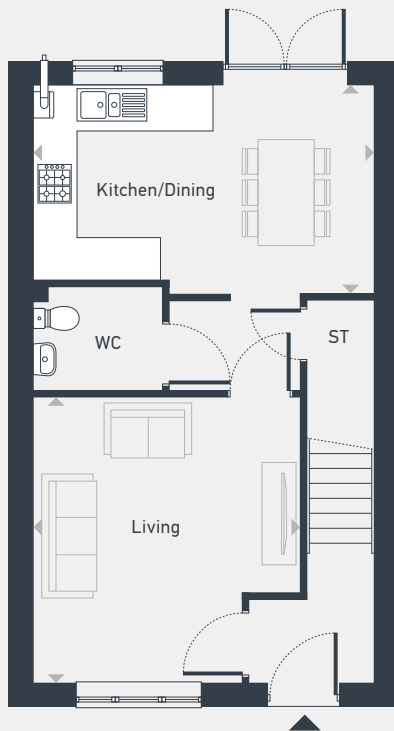

GROUND FLOOR



FIRST FLOOR



SECOND FLOOR

DIMENSIONS	m	ft
Living	3.99m x 3.72m	13'1" x 12'2"
Kitchen/Dining	4.74m x 2.91m	15'7" x 9'7"
Bedroom 1	3.62m x 3.01m	11'11" x 9'11"
En-suite	2.08m x 1.64m	6'10" x 5'5"
Dressing	2.35m x 1.90m	7'9" x 6'3"

DIMENSIONS	m	ft
Bedroom 2	4.74m x 2.62m	15'7" x 8'7"
Bedroom 3	3.39m x 2.49m	11'2" x 8'2"
Bathroom	2.15m x 1.90m	7'1" x 6'3"



01392 590 255 | placesforpeople.co.uk/newcourtedge
Newcourt Edge, Ikea Way, Exeter EX2 7RX

Please note: All layouts and floor plans, configurations, maps and information are intended for guidance only and accuracy of this information cannot be relied upon by prospective purchasers who must make their own enquiries to satisfy themselves by inspection or otherwise as to the correct detail. Sizes and dimensions approximate and subject to change.