

THE REDSTART TWO BEDROOM HOUSE

PLOTS 2, 22, 23*, 26 & 27*

*Plots are handed to the plans drawn



Ground Floor

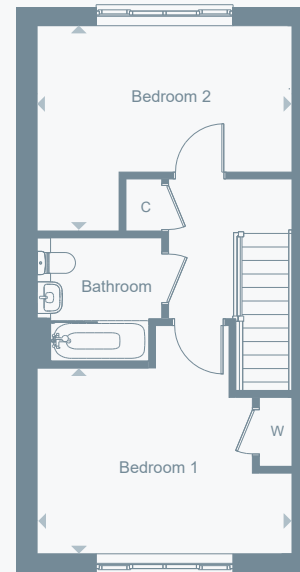

First Floor

Floor plans are not to scale and are indicative only. Location of windows, doors, kitchen units and appliances may differ. Doors may swing in the opposite direction to that shown on selected apartments. Dimensions, which are taken from the indicated points of measurement, are for guidance only and are not intended to be used to calculate space for items of furniture. Total areas are provided as gross internal areas and are subject to variance. Please speak to our Sales Consultant for further information.

DIMENSIONS

Total Area 80.9 m² 870 ft²

Living / Dining Room

4.94m x 4.42m 16' 2" x 14' 5"

Kitchen

2.85m x 2.57m 9' 3" x 8' 4"

Bedroom 1

4.42m x 3.55m 14' 5" x 11' 6"

Bedroom 2

4.42m x 3.22m 14' 5" x 10' 5"

KEY

F/F Fridge/Freezer

W Wardrobe

C Cupboard



THE REDSTART 2 Bedroom House

THE GOLDCREST 3 Bedroom House

THE GREENFINCH 3 Bedroom House

THE SKYLARK 4 Bedroom House

Affordable / Social Rent Houses



WINGS
WOOD

WOODGATE CHICHESTER

PHASE 2

THE REDSTART

2 bedroom
houses with
Shared
Ownership

0300 555 2171

sales@southernhousing.org.uk

shnewhomes.co.uk/wingswood-ph2

SOUTHERN
HOUSING

new homes