

A two bedroom house

Plots 113, 114, 115, 116, 117, 118, 124 & 130

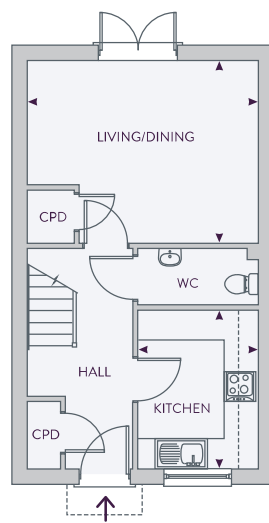

Ground Floor

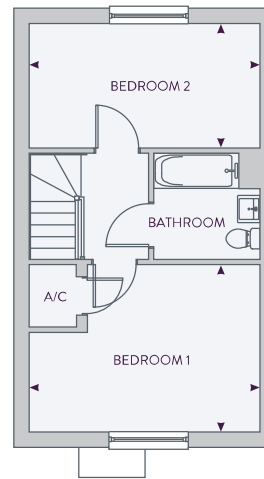

First Floor

Living/Dining
4460mm x 3630mm

Bedroom 1
4550mm x 3330mm

Kitchen
2320mm x 3170mm

Bedroom 2
4550mm x 2470mm

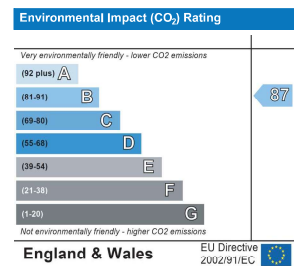
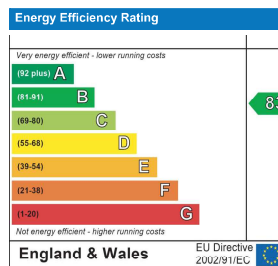

Floorplans shown are indicative only. All room sizes are approximate with maximum dimensions of finished measurements. Measurements have been taken into the kitchen units and are not intended for carpet sizes or items of furniture. Room layouts may be subject to minor modifications. Furniture, kitchen and bathroom layouts shown are indicative only.