

Gowers Place

Feltwell

SHARED OWNERSHIP



THE BRAMBLE

2 Bedroom Semi-Detached House

Plot 15

GROUND FLOOR

Kitchen/Dining Room	3.91m x 2.93m	12'10" x 9'7"
Living Room	4.83m x 2.99m	15'10" x 9'10"

FIRST FLOOR

Primary Bedroom	4.94m x 3.14m	16'2" x 10'4"
Bedroom 2	4.94m x 2.91m	16'2" x 9'7"



01603 255444
sharedownership@flagship-homes.co.uk
flagship-homes.co.uk

Gowers Place

Feltwell



GROUND FLOOR

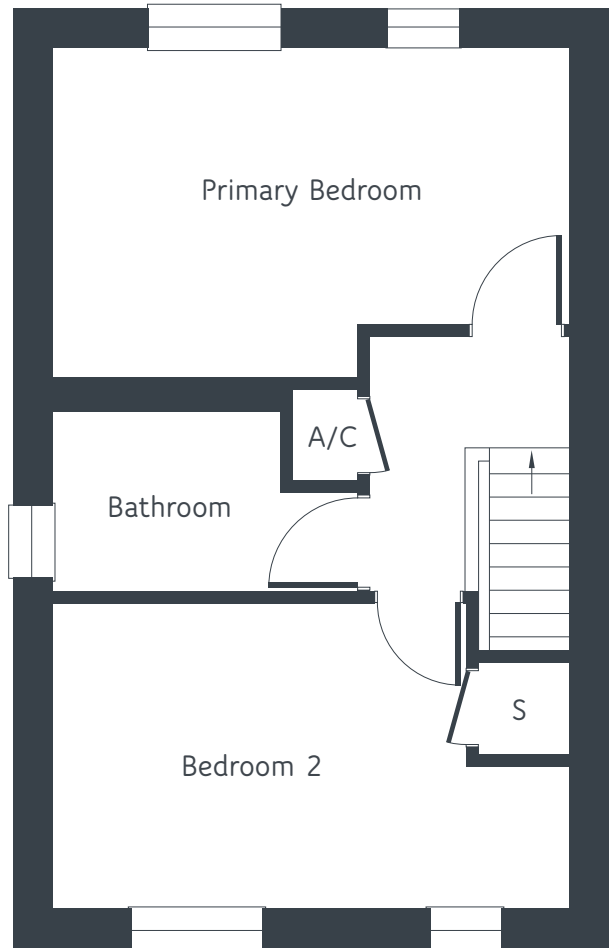

FIRST FLOOR

Total floor space: 850 sq ft / 79 sq m

Floor plans and computer generated images are indicative only and external finished may vary. Dimensions shown may vary within a tolerance of +/- 50mm and are not intended to be used for carpet sizes, appliance sizes or items of furniture. Floor plans are not shown to scale.

Gowers Place

Feltwell

SHARED OWNERSHIP



THE BRAMBLE

2 Bedroom Semi-Detached House

Plot 14

GROUND FLOOR

Kitchen/Dining Room	4.94m x 3.43m	16'2" x 11'3"
Living Room	3.98m x 3.47m	13'1" x 11'5"

FIRST FLOOR

Primary Bedroom	4.94m x 3.14m	16'2" x 10'4"
Bedroom 2	4.94m x 2.91m	16'2" x 9'7"



01603 255444
sharedownership@flagship-homes.co.uk
flagship-homes.co.uk

Gowers Place

Feltwell

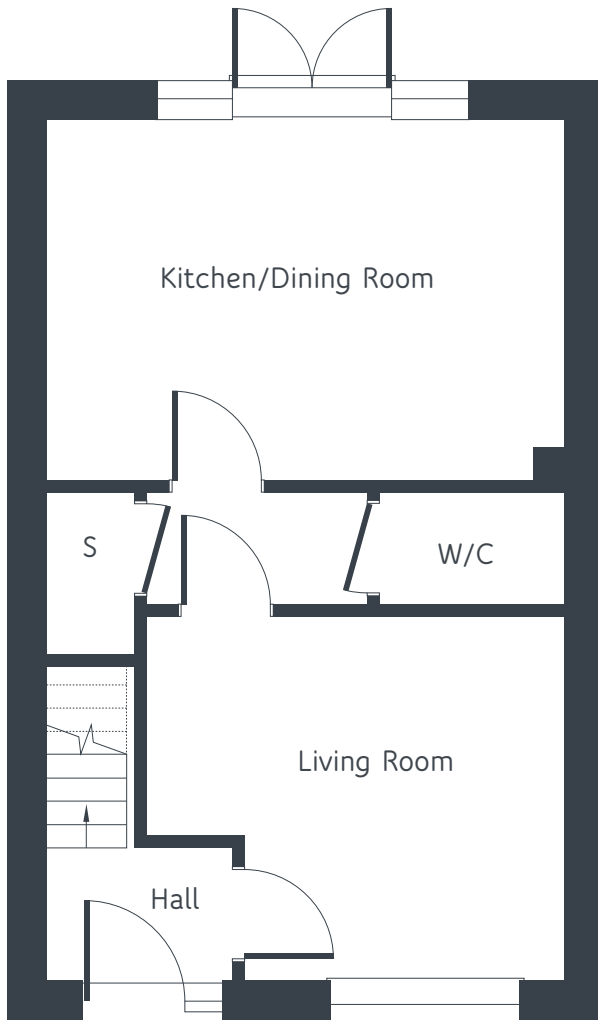

GROUND FLOOR

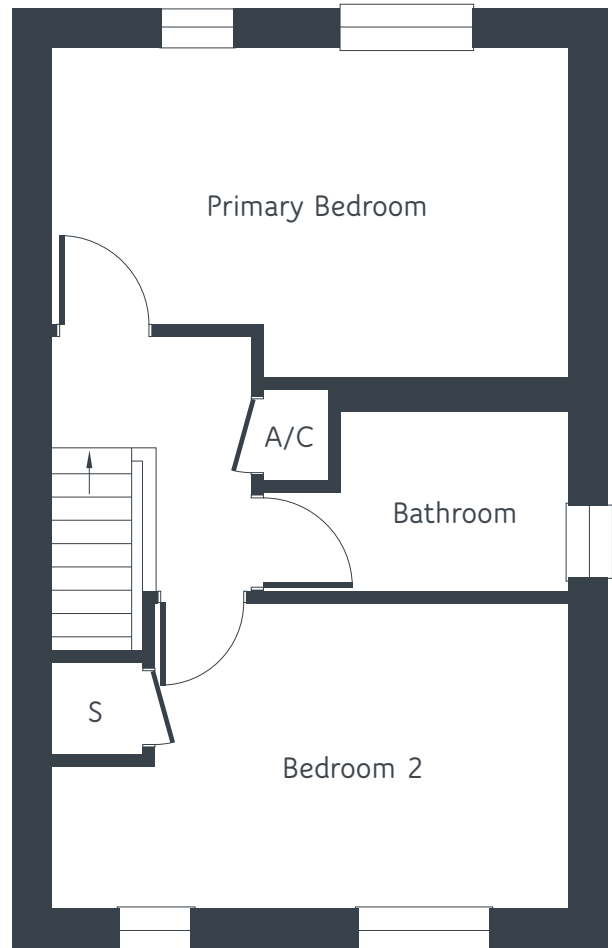

FIRST FLOOR

Total floor space: 850 sq ft / 79 sq m

Floor plans and computer generated images are indicative only and external finished may vary. Dimensions shown may vary within a tolerance of +/- 50mm and are not intended to be used for carpet sizes, appliance sizes or items of furniture. Floor plans are not shown to scale.