

B2-L02-04, B2-L03-04, B2-L04-04, B2-L05-04, B2-L06-04, B2-L07-04, B2-L08-04 & B2-L09-04

LEVELS 2, 3, 4, 5, 6, 7, 8 & 9

2 bedroom apartment

BLOCK A2

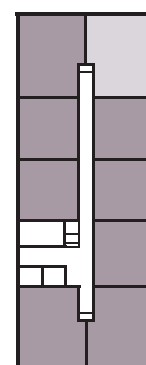

Kitchen/Living/Dining

7.95m x 3.72m

26'1" x 12'3"

Balcony

4.69m x 1.50m

15'5" x 4'11"

Bedroom 1

4.12m x 3.17m

13'6" x 10'5"

Gross Internal Area

73.46 sq m

790.72 sq ft

Bedroom 2

4.12m x 2.74m

13'6" x 9'0"

Key:

DW – Dishwasher **FF** – Fridge Freezer **FST** – Free-standing Table **HIU** – Heat Interface Unit

MVHR – Mechanical Ventilation Heat Recovery system **ST** – Storage **TU/O** – Tall Unit with integrated Oven

W – Built-in Wardrobe **WD** – Washer Dryer

The floorplans depict a typical layout of this apartment type. For exact apartment specification, details of external and internal finishes, dimensions and floorplan differences, consult your Sales Executive. Any areas, measurements or distances quoted are approximate only and should not be used when ordering floor coverings or furnishings. Floorplans are not shown to scale.

B2-L09-04	LEVEL 9
B2-L08-04	LEVEL 8
B2-L07-04	LEVEL 7
B2-L06-04	LEVEL 6
B2-L05-04	LEVEL 5
B2-L04-04	LEVEL 4
B2-L03-04	LEVEL 3
B2-L02-04	LEVEL 2
	LEVEL 1