



157 Shearwood Crescent
Crayford
Kent
DA1 4TJ



Council Tax: B
EPC Rating: D

50% Shared ownership Chain free ground floor purpose-built flat well positioned for zone 6 station and local amenities with benefits including allocated parking.

- 17' x 10' lounge
- 14' x 9' Bedroom
- No chain
- 8' x 7' fitted kitchen
- Ideal first time/Investment purchase
- Allocated parking space

50% Shared Ownership £72,500

Leasehold

ROBINSON-JACKSON
Our service will *move* you

Ground Floor

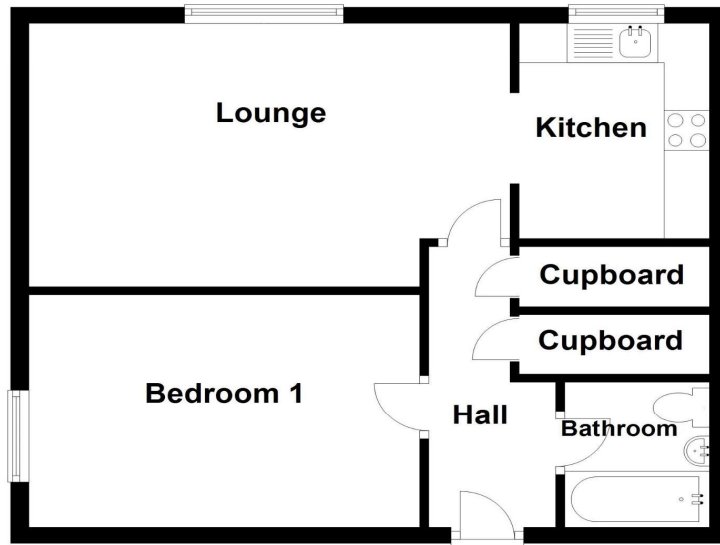

Whilst every attempt has been made to ensure the accuracy of the floorplan contained here, measurements of doors, windows and rooms are approximate and no responsibility is taken for any error, omission or mis-statement. These plans are for representation purposes only and should be used as such by any prospective purchaser/ tenant. The services systems and appliances listed in this specification have not been tested and no guarantee as to their operating ability or their efficiency can be given.
Plan produced using PlanUp.

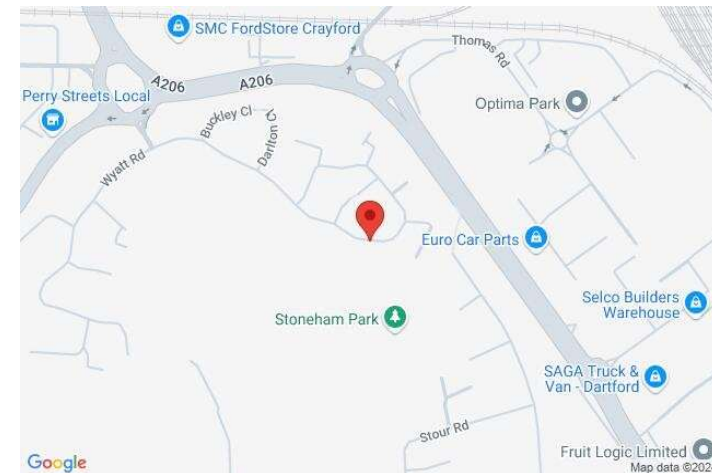

**FOR MORE INFORMATION
CONTACT US TODAY.**

01322 340000
Robinson Jackson
226 Bexley Road,
North' Heath,
Kent, DA8 3HB
northumberlandheath@robinson-jackson.com



Interior

Lounge 5.23m x 3.23m (17'2" x 10'7")

Kitchen 2.16m x 2.64m (7'1" x 8'8")

Bedroom 4.27m x 2.84m (14' x 9'4")

Bathroom 1.96m x 1.7m (6'5" x 5'7")

Exterior

Allocated Parking (to be verified by vendors solicitor)

Communal Garden

Leasehold Information

Lease Term: 99 years from 29/09/1982 (to be verified by the vendors solicitors)

Unexpired Lease: Approx 57 years remaining (to be verified by vendors solicitor)

Service Charge: £719 per annum (to be verified by vendors solicitor)

Rent: £176 pcm (to be verified by vendors solicitor)

Additional Information

Barnehurst & Bexleyheath are adjacent neighbourhoods with Bexleyheath being home to the borough's largest shopping facility, where you'll find high-street names, and supermarkets. There's a bowling alley, a cinema, Crook Log Leisure Centre, regular specialist markets, family-friendly restaurants and both neighbourhoods having mainline stations in to London too.

Families are also attracted to Barnehurst/Bexleyheath for the schooling – with two of the borough's grammars and excellent primaries close by. The Red House – an Arts & Crafts property designed for the artist and socialist William Morris - is Bexleyheath's premier cultural attraction.