



# TODDINGTON MEADOWS

2 & 3 bedroom  
shared ownership  
homes



Marketing and Sales Brand  
[domovohomes.co.uk](http://domovohomes.co.uk)

# WELCOME TO SHARED OWNERSHIP LIVING

Welcome to Toddington Meadows, an exciting new development by Domovo, offering a range of beautifully designed 2 & 3 bedroom shared ownership homes in the heart of Bedfordshire.



Perfectly situated in the charming village of Toddington, this community-focused neighbourhood provides the ideal blend of countryside tranquillity and modern convenience.

## A THRIVING COMMUNITY

The village features a variety of independent shops, cosy pubs, and inviting cafes that serve as popular gathering spots for locals. With excellent local amenities including reputable schools, healthcare facilities and recreational spaces, Toddington is designed for both convenience and community.

Surrounded by beautiful walking trails and open countryside, Toddington offers a tranquil lifestyle, whilst maintaining easy access to local amenities.

## A PLACE WITH EVERYTHING YOU NEED

Nestled in the heart of Bedfordshire, Toddington is a charming village that combines rural beauty with modern convenience, making it an ideal location for families and professionals alike.

Known for its picturesque setting and strong sense of community, Toddington offers a peaceful countryside lifestyle while keeping you well-connected; the nearby M1 provides easy access to London and Milton Keynes and Harlington train station is just a short drive away.



Dunstable Downs, Bedfordshire



Woburn and Whipsnade zoo are nearby

## CONNECTED LIVING

Toddington Meadows is perfectly positioned to make daily commuting both efficient and flexible, linking residents seamlessly to surrounding towns and city centers.

- 15 MINS\* Luton
- 20 MINS\* Luton Airport
- 25 MINS\* Milton Keynes
- 50 MINS\* London

\*Time travelled by car

# 2 & 3 BEDROOM HOMES

These homes offer flexibility for every day living, with a spacious downstairs perfect for both modern life and cosy nights in. Upstairs, enjoy the spacious bedrooms and a stylish, well-equipped bathroom.



# DEVELOPMENT LAYOUT

## KEY

- Shared ownership**  
Plots 27, 40 & 41    2 bedroom home

---

- Shared ownership**  
Plots 36 & 37    3 bedroom home

---

- bpha affordable rent**  
Plots 33, 35 & 47    1 Bedroom Maisonette  
Plots 32, 34 & 46    2 Bedroom Maisonette  
Plots 42 - 44    2 Bedroom House  
Plots 38 & 39    3 Bedroom House  
Plot 45    4 Bedroom House

---

- Developer outright sales**

---

- C/S **Cycle store**

---

- EV **Electric Charging Point**



## PLOTS 36-37 3 BEDROOM HOMES

### DIMENSIONS

Kitchen/Dining	5.42m x 4.58m 17'09" x 15'00"
Lounge*	4.01m x 3.77m 13'01" x 12'04"
Bedroom 1	4.21m x 3.15m 13'09" x 10'04"
Bedroom 2	4.41m x 2.62m 14'05" x 8'07"
Bedroom 3*	3.37m x 2.72m 11'00" x 8'11"

\*Max measurement

\*\*Please note the floorplans shown left are for plot 36. Plot 37's layout is mirrored.

### GROUND FLOOR\*\*

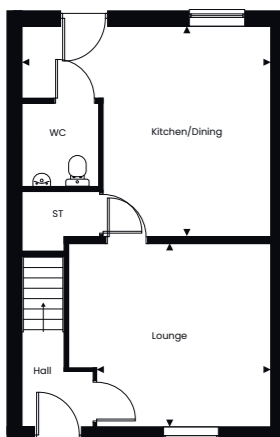

### FIRST FLOOR\*\*

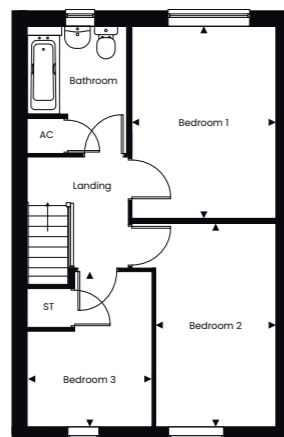

## PLOTS 40-41 2 BEDROOM HOMES

### DIMENSIONS

Kitchen/Dining	4.92m x 3.23m 16'01" x 10'07"
Lounge	4.84m x 3.27m 15'10" x 10'08"
Bedroom 1	4.92m x 3.65m 16'01" x 11'11"
Bedroom 2	4.42m x 2.65m 14'06" x 8'08"

\*Max measurement

\*\*Please note the floorplans shown right are for plot 40. Plot 41's layout is mirrored.

### GROUND FLOOR\*\*

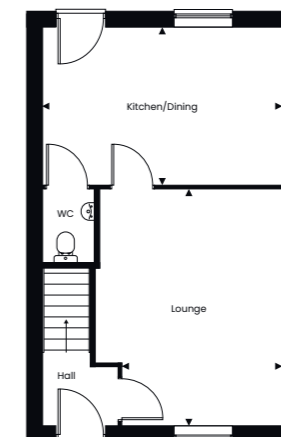

### FIRST FLOOR\*\*

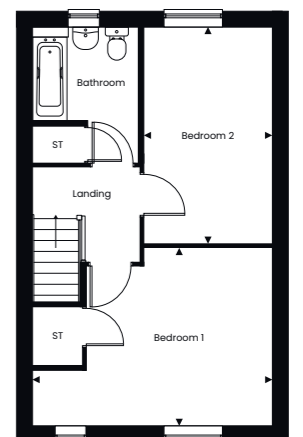

# HOMES DESIGNED FOR LIVING



## KITCHEN

Hacienda platinum kitchen cupboards

Marble siroco worktop with upstand

Built in oven, gas hob and extractor hood

Stainless steel splashback

Vinyl flooring



## BATHROOM

Shower over bath

Glass shower screen

Chrome towel rail

Wall tiling to wet areas

Vinyl flooring

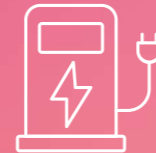

## GENERAL

PV panels

Carpet to dry areas

Gas central heating

Private garden with turf

Rotary dryer

Two car parking spaces

Electric vehicle charging point



YOU CAN BUY BETWEEN A 10-75% SHARE



MAKE MORTGAGE PAYMENTS ON THE SHARE YOU OWN



PAY RENT ON THE REMAINING SHARES



BUY MORE SHARES IN YOUR PROPERTY IN 1% INCREMENTS

## SHARED OWNERSHIP

### THE OPTION YOU NEVER KNEW EXISTED

Shared Ownership\* enables you to buy an initial share of a property and pay a subsidised rent on the rest, meaning you can get into home ownership in manageable stages and don't take on more of a financial commitment than you can afford.

Initial shares of between 10% and 75%\*\* of our properties are available, you will pay a subsidised rent on the remaining share. In the future you can purchase further shares in your home\*\*\*, or sell your share and move on.

\*Properties are offered as leasehold, with a lease term of 999 years.

\*\*Shares offered are based on the affordability determined by an Independent Mortgage Advisor.

\*\*\*Some properties are restricted to the level of share you can purchase.

## MY SHARED OWNERSHIP JOURNEY



**"BEING ABLE TO BUY THIS PROPERTY HAS TRULY CHANGED MY LIFE. I HAD STARTED TO ACCEPT THAT I MIGHT HAVE TO RENT, BUT OWNING THIS HOME HAS GIVEN ME A FRESH START AND ALLOWED ME TO MOVE FORWARD."**



After a relationship change, Lily needed a new home that could accommodate both her and her dog, Ernie. She discovered a 2 bedroom house on Rightmove through Domovo's Shared Ownership scheme and found the entire process seamless. "I registered my interest and the sales team were great. From start to finish, it only took three months – it was so quick and straightforward."

**"WHEN YOU THINK OF SHARED OWNERSHIP, YOU THINK IT'S JUST FOR FIRST-TIME BUYERS, BUT IT'S ALSO GREAT FOR SINGLE PEOPLE WHO MAY HAVE HAD TO TAKE A STEP BACKWARDS DUE TO CIRCUMSTANCES BEYOND THEIR CONTROL."**

The home itself exceeded Lily's expectations: "The rooms are spacious, well-maintained and even matched my décor style. It's the dreamiest property I could've imagined; it felt meant to be." She was also thrilled with the location, staying close to her favourite dog walking routes, gym and friends.

With an initial 35% share, Lily appreciates the flexibility Domovo offers: "Knowing I can staircase at any time helped me make the decision." Finding this home with Domovo allowed Lily to stay on the property ladder and start anew in a place she loves.



# TODDINGTON MEADOWS

Snowhill Place, Toddington, Bedfordshire, LU5 6UH

