

The Willows at Aylesham

The Haldon
2 bedroom home



The Willows at Aylesham

The Haldon 2 bedroom home

Plots 21, 22*, 37 & 38*

71.6 sq m / 771 sq ft

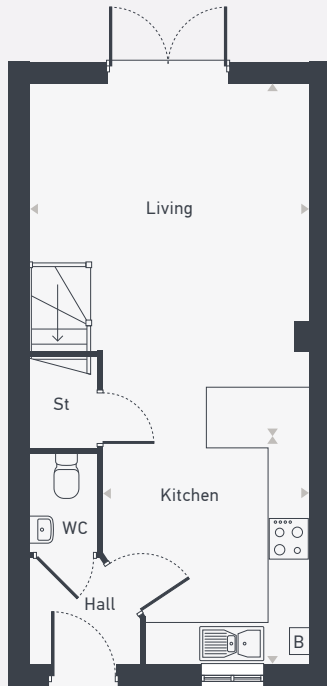

GROUND FLOOR

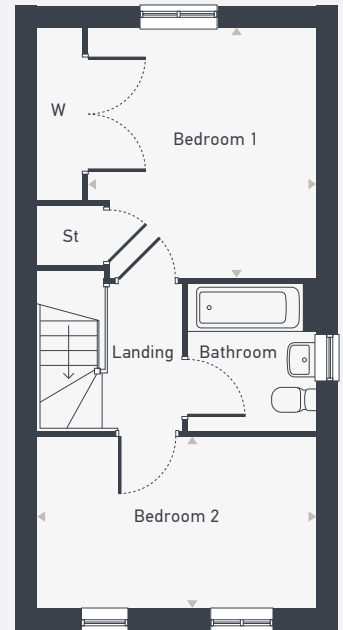

FIRST FLOOR

GROUND FLOOR	m	ft
Kitchen	4.07m x 3.03m	13'4" x 9'11"
Living	4.49m x 4.11m	14'9" x 13'6"

FIRST FLOOR	m	ft
Bedroom 1	3.66m x 3.37m	12'1" x 11'1"
Bedroom 2	4.11m x 2.58m	13'6" x 8'5"



Central Boulevard, Aylesham, Canterbury, CT3 3FF
placesforpeople.co.uk/thewillows

Please note: *Plots are handed. †No window to plot 37. All layouts and floor plans, configurations, maps and information are intended for guidance only and accuracy of this information cannot be relied upon by prospective purchasers who must make their own enquiries to satisfy themselves by inspection or otherwise as to the correct detail. Sizes and dimensions approximate and subject to change.