

Prices  
*from*  
**£141,250**

# High Leigh – Phase 2

Bishop Gardens, Hoddesdon, Hertfordshire

A brand-new development of 4 houses

available through Shared Ownership

 **ParadigmLiving**

£ Prices from **£141,250 (25% share)**

% Share available **25%-75%**

🛏 **4 bed houses**



## High Leigh – Phase 2 **KEY FEATURES**

White bathroom suite with  
thermostatic shower & heated  
towel rail

Carpet throughout living areas

Vinyl flooring in kitchen,  
bathroom & downstairs toilet

Gas central heating

Minimum of 2 allocated parking  
spaces

Fitted kitchen with integrated  
oven and induction hob, washer  
dryer, fridge freezer & dishwasher.

Enclosed garden with turf

Paradigm are pleased to offer 4 further new build properties under the Shared Ownership Scheme. The properties consist of 4-bedroom semi-detached homes located in the lovely Hertfordshire town of Hoddesdon. The properties are ideally situated just off the A10 & just a short drive into the centre of Hoddesdon with a range of local amenities.



Disclaimer: Please note that, due to varying stages of construction, photographs may be of similar properties and are intended to give an idea of the finish of the properties being built.

These particulars do not constitute any part of an offer or contract. Any intended purchasers must satisfy themselves as to the correctness of each of the statements contained in these particulars. All floor layouts may be subject to changes. The dimensions given on the plan are subject to minor variations intended for guidance only and are not to be used for carpets, appliances or items of furniture.

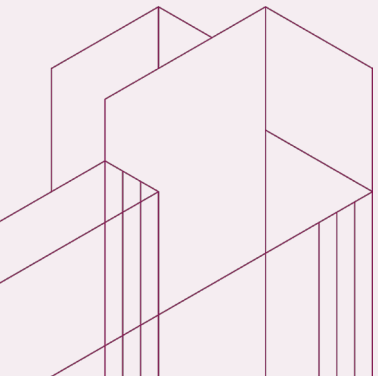



## Four Bedroom House

Plots 88, 89\*, 90, 91\*

(\* handed)

### KITCHEN

19'0" x 9'11" 5.80m x 3.03m

### LIVING ROOM

15'5" x 15'1" 4.70m x 4.60m

### BEDROOM 1

11'8" x 10'9" 3.58m x 3.28m

### BEDROOM 2

11'4" x 11'2" 3.47m x 3.42m

### BEDROOM 3

8'0" x 7'3" 2.46m x 2.23m

### BEDROOM 4

11'2" x 7'5" 3.41m x 2.28m

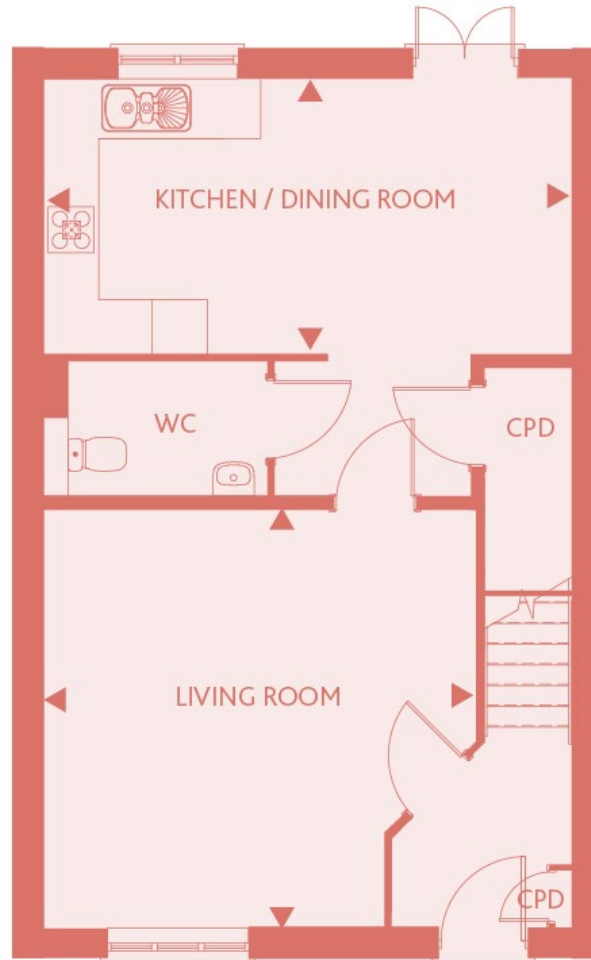

GROUND FLOOR

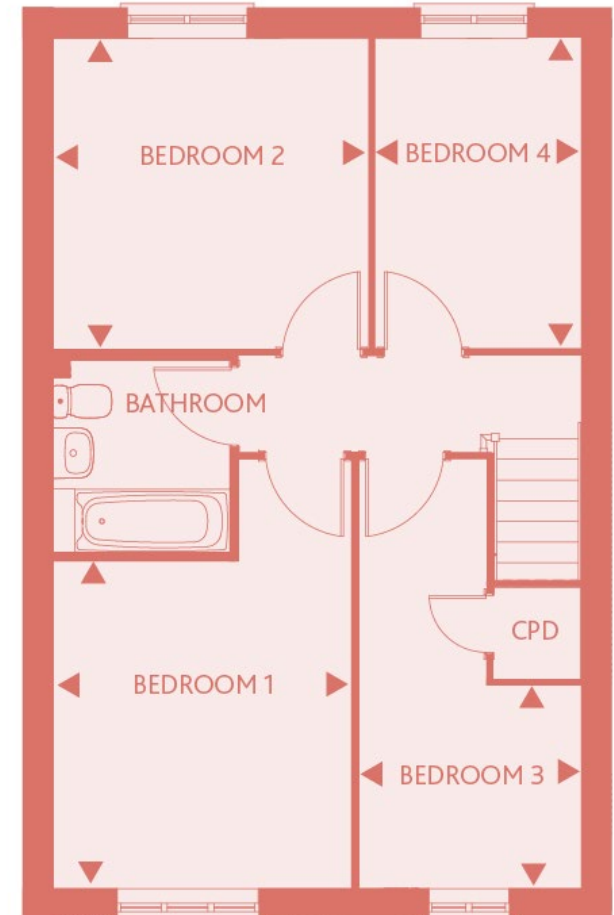

FIRST FLOOR

These particulars do not constitute any part of an offer or contract. Any intended purchasers must satisfy themselves as to the correctness of each of the statements contained in these particulars. All floor layouts may be subject to changes. The dimensions given on the plan are subject to minor variations intended for guidance only and are not to be used for carpets, appliances or items of furniture.



# SITE PLAN

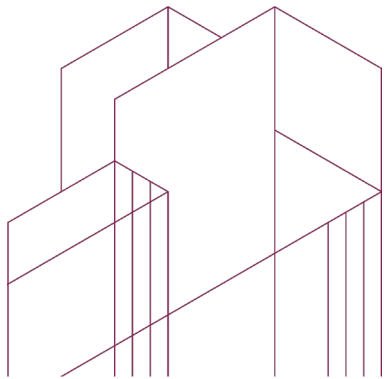

These particulars do not constitute any part of an offer or contract. Any intended purchasers must satisfy themselves as to the correctness of each of the statements contained in these particulars. All floor layouts may be subject to changes. The dimensions given on the plan are subject to minor variations intended for guidance only and are not used for carpets, appliances or items of furniture.

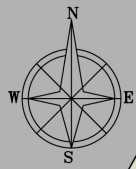

**Key**  
Affordable Properties

**////// ParadigmLiving**

**For more information**

0300 303 8046

**[www.paradigmliving.co.uk](http://www.paradigmliving.co.uk)**

These particulars do not constitute any part of an offer or contract. Any intended purchasers must satisfy themselves as to the correctness of each of the statements contained in these particulars. All floor layouts maybe subject to changes. The dimensions given on the plan are subject to minor variations intended for guidance only and are not be used for carpets, appliances or items of furniture.

