



Templer Place, Bovey Tracey, Newton Abbot
Guide Price: £108,000 (40% Share)



Apply now and unlock your home buying potential with Shared Ownership. Available to purchase at a 40% share for £108,000 with a min 5% deposit. (Full market value £270,000).

Financial Breakdown:

Full market value: £270,000

40% share value £108,000

5% deposit: £5400

Rent charged on un-owned share: £376.81 Inclusive of Service Charge & Buildings Insurance

Rent on un-owned share (60%)

Estimated monthly service charge: £25.51

This super three bedroom semi-detached home is just perfect for first time buyers or families.

This home benefits from a modern fitted kitchen to the front and separate living/dining room making it ideal to relax in with your loved ones or entertain when guests come to visit. . French doors lead off onto the private rear garden. On the ground floor there is also the bonus of a useful downstairs cloakroom. Upstairs you will find three good sized bedrooms and a stylish bathroom suite. This home also comes with a garage En-bloc.

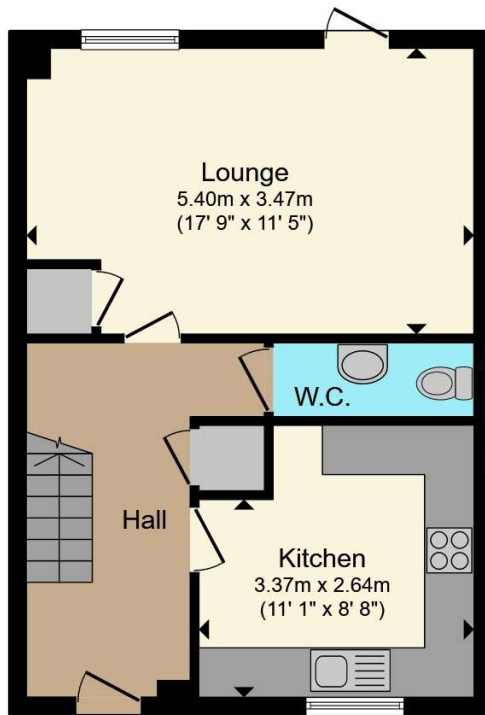

Ground Floor

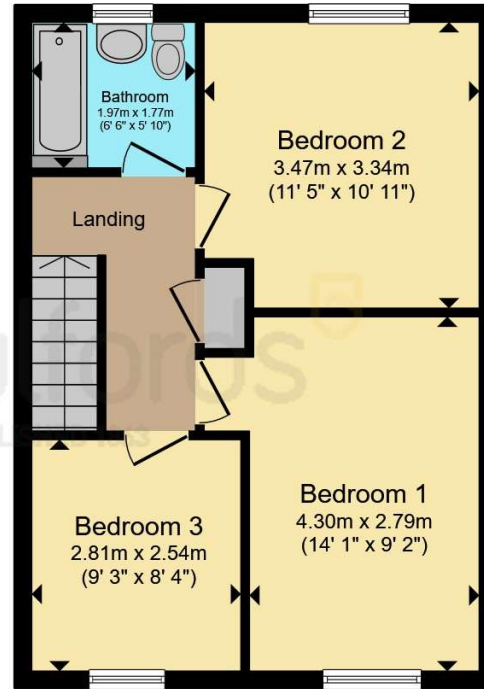

First Floor

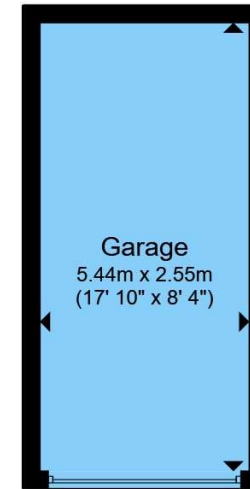

Garage

Total floor area 99.3 m² (1,069 sq.ft.) approx

This floor plan is for illustrative purposes only. It is not drawn to scale. Any measurements, floor areas (including any total floor area), openings and orientation are approximate. No details are guaranteed, they cannot be relied upon for any purpose and they do not form part of any agreement. No liability is taken for any error, omission or misstatement. A party must rely upon its own inspection(s). Powered by www.focalagent.com



Council Tax Band: **C**

Tenure: **Leasehold**

Years Left on Lease: **114**

Service Charge: **£25.51**

Viewing by appointment

T: 01626 351951

E: newtonabbot@fulfords.co.uk

1 Wolborough Street, Newton Abbot, Devon, TQ12 1JR



Interested parties should satisfy themselves, by inspection or otherwise as to the accuracy of the description given and any floor plans shown in these property details. All measurements, distances and areas listed are approximate. Fixtures, fittings and other items are NOT included unless specified in these details. Please note that any services, heating systems, or appliances have not been tested and no warranty can be given or implied as to their working order.

Fulfords is a trading name of Countrywide Estate Agents, Registered in England Number 00789476. Registered Office Greenwood House, 1st Floor, 91-99 New London Road, Chelmsford, Essex, CM2 0PP. VAT number 500 2481 05

Code: NEW_NEW250002_R4PL_8

