



## Three bedroom semi-detached house

4 Barley Drive, Chestfield, Whitstable, Kent, CT5 3PN



ASHP = Air source heat pump

Please speak to the sales executive for more information

Total Internal Area	94 sq m
Kitchen	5.0m x 2.6m
Living / Dining area	4.0m x 5.7m
Bedroom 1	3.3m x 3.6m
Bedroom 2	3.1m x 2.9m
Bedroom 3	3.3m x 2.5m

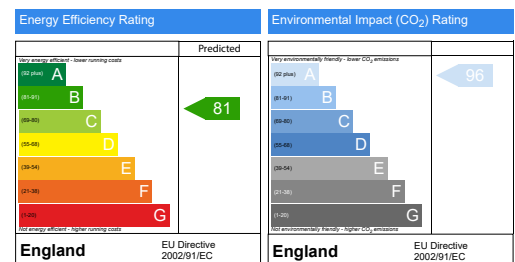

Cup'd = Cupboard, WC = Water Closet, HWC = Hot Water Cylinder, FF = Fridge Freezer, WM = Washing Machine, DW = Dishwasher, DO = Double Oven

Floor plans shown are indicative only. All room sizes are approximate with maximum dimensions of finished items of furniture. Room layouts may be subject to minor modifications. Furniture, kitchen and bathroom layouts shown are indicative only. Measurement at widest point.



# Three bedroom semi-detached house

2 Barley Drive, Chestfield, Whitstable, Kent, CT5 3PN

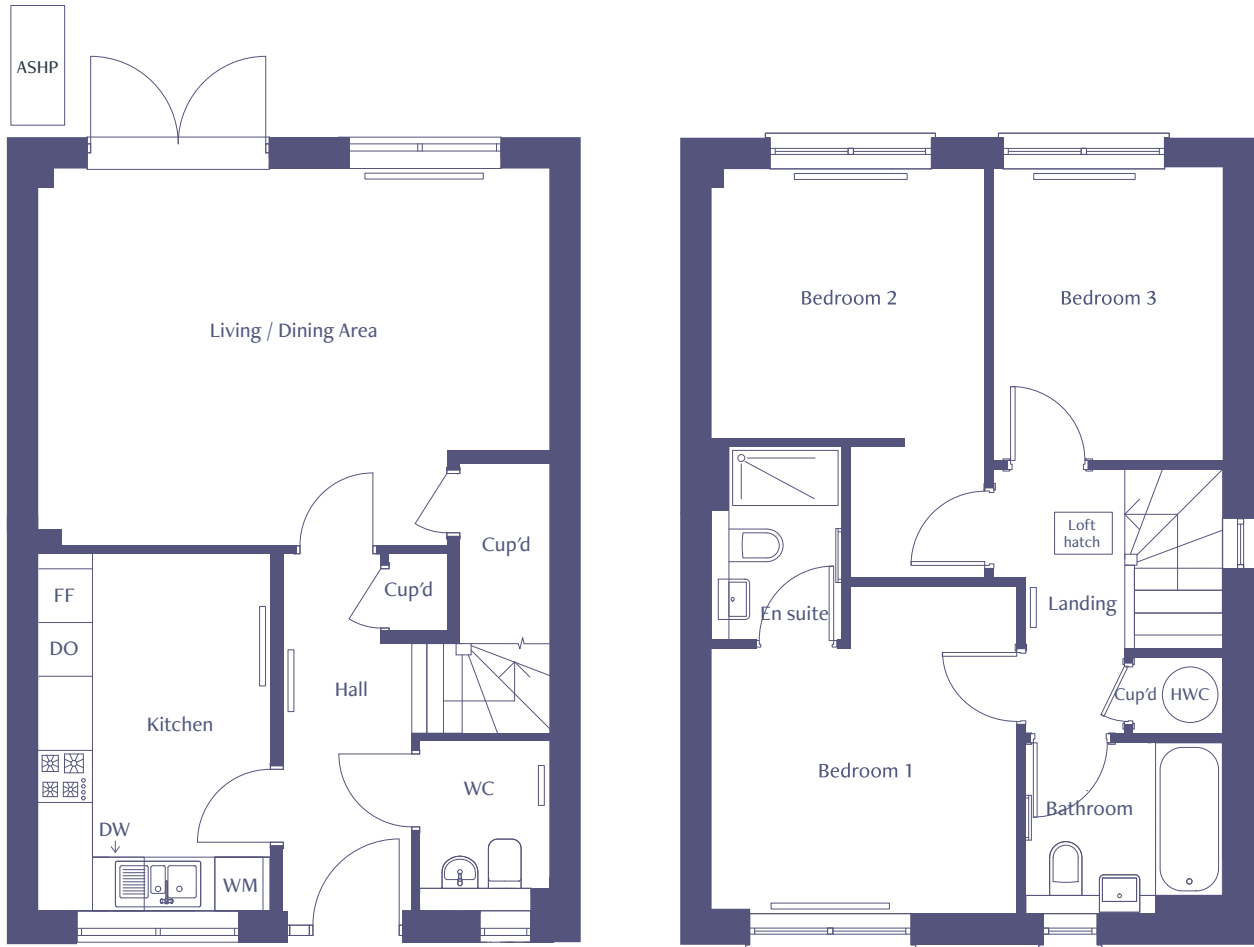

ASHP = Air source heat pump

Please speak to the sales executive for more information

Total Internal Area	94 sq m
Kitchen	5.0m x 2.6m
Living / Dining area	4.0m x 5.7m
Bedroom 1	3.3m x 3.6m
Bedroom 2	3.1m x 2.9m
Bedroom 3	3.3m x 2.5m

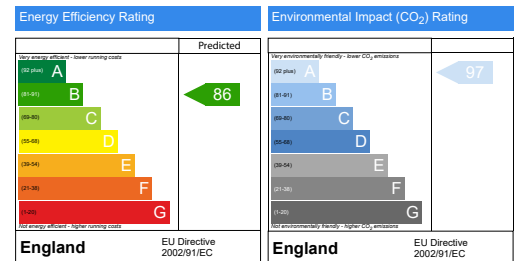

Cup'd = Cupboard, WC = Water Closet, HWC = Hot Water Cylinder, FF = Fridge Freezer, WM = Washing Machine, DW = Dishwasher, DO = Double Oven

Floor plans shown are indicative only. All room sizes are approximate with maximum dimensions of finished items of furniture. Room layouts may be subject to minor modifications. Furniture, kitchen and bathroom layouts shown are indicative only. Measurement at widest point.



# Three bedroom semi-detached house

70 Maize Crescent, Chestfield, Whitstable, Kent, CT5 3RQ



ASHP = Air source heat pump  
Please speak to the sales executive for more information

<b>Total Internal Area</b>	<b>94 sq m</b>
Kitchen	5.0m x 2.6m
Living / Dining area	4.0m x 5.7m
Bedroom 1	3.3m x 3.6m
Bedroom 2	3.1m x 2.9m
Bedroom 3	3.3m x 2.5m

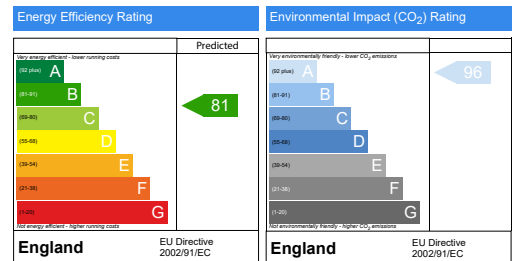

Cup'd = Cupboard, WC = Water Closet, HWC = Hot Water Cylinder, FF = Fridge Freezer, WM = Washing Machine, DW = Dishwasher, DO = Double Oven

Floor plans shown are indicative only. All room sizes are approximate with maximum dimensions of finished items of furniture. Room layouts may be subject to minor modifications. Furniture, kitchen and bathroom layouts shown are indicative only. Measurement at widest point.



## Three bedroom semi-detached house

77 Maize Crescent, Chestfield, Whitstable, Kent, CT5 3RQ



ASHP = Air source heat pump

Please speak to the sales executive for more information

Total Internal Area	94 sq m
Kitchen	5.0m x 2.6m
Living / Dining area	4.0m x 5.7m
Bedroom 1	3.3m x 3.6m
Bedroom 2	3.1m x 2.9m
Bedroom 3	3.3m x 2.5m

Energy Efficiency Rating	Environmental Impact (CO <sub>2</sub> ) Rating
<p><b>85</b></p>	<p><b>97</b></p>
<p><b>England</b></p> <p>EU Directive 2002/91/EC</p>	<p><b>England</b></p> <p>EU Directive 2002/91/EC</p>

Cup'd = Cupboard, WC = Water Closet, HWC = Hot Water Cylinder, FF = Fridge Freezer, WM = Washing Machine, DW = Dishwasher, DO = Double Oven

Floor plans shown are indicative only. All room sizes are approximate with maximum dimensions of finished items of furniture. Room layouts may be subject to minor modifications. Furniture, kitchen and bathroom layouts shown are indicative only. Measurement at widest point.



## Three bedroom semi-detached house

79 Maize Crescent, Chestfield, Whitstable, Kent, CT5 3RQ

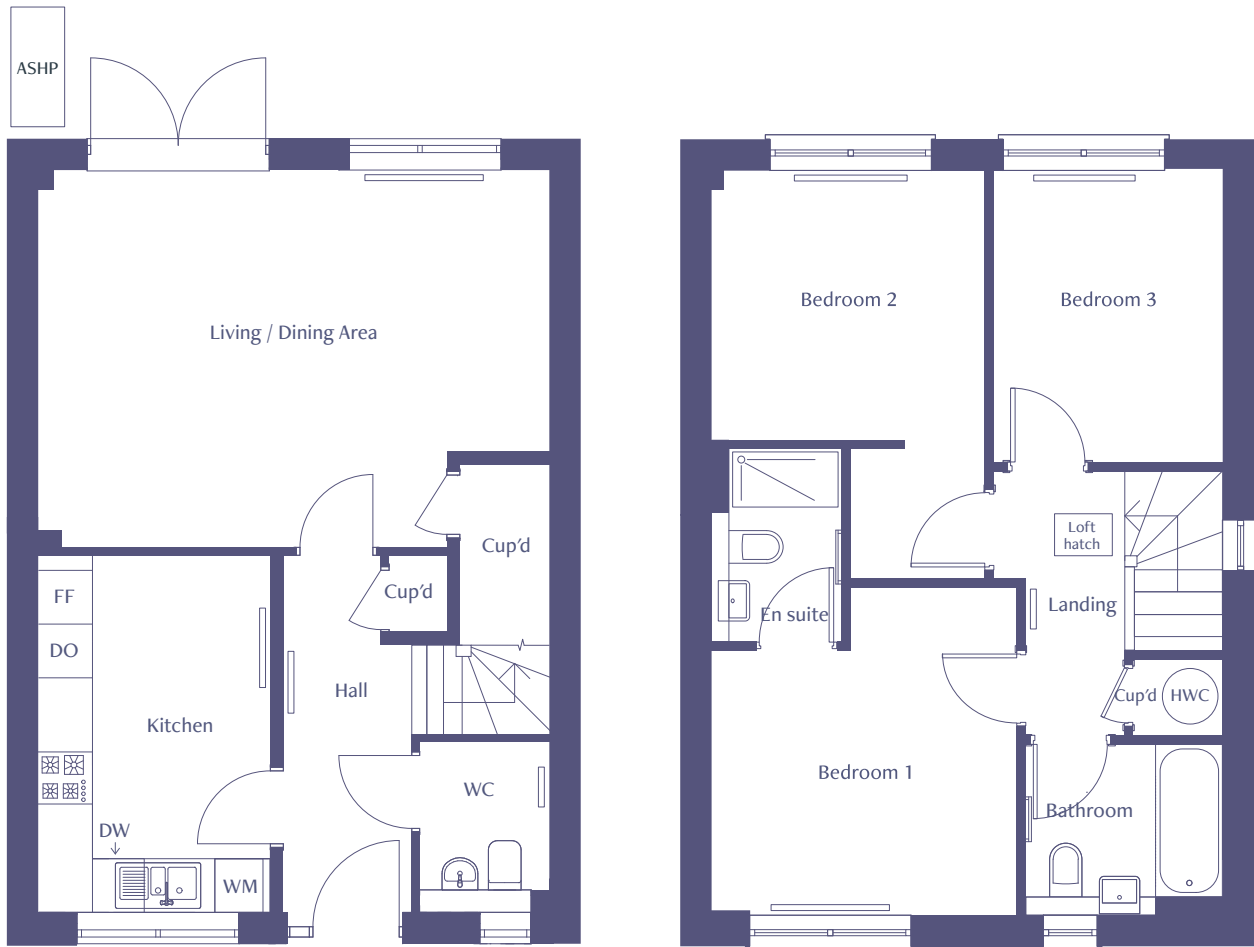

ASHP = Air source heat pump

Please speak to the sales executive for more information

**Total Internal Area** 94 sq m

Kitchen	5.0m x 2.6m
Living / Dining area	4.0m x 5.7m
Bedroom 1	3.3m x 3.6m
Bedroom 2	3.1m x 2.9m
Bedroom 3	3.3m x 2.5m

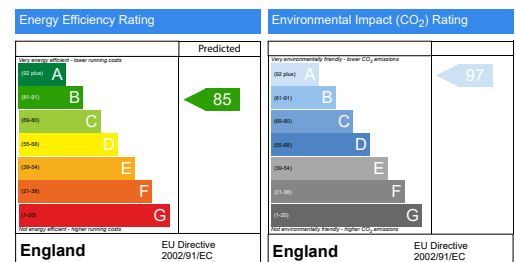

Cup'd = Cupboard, WC = Water Closet, HWC = Hot Water Cylinder, FF = Fridge Freezer, WM = Washing Machine, DW = Dishwasher, DO = Double Oven

Floor plans shown are indicative only. All room sizes are approximate with maximum dimensions of finished items of furniture. Room layouts may be subject to minor modifications. Furniture, kitchen and bathroom layouts shown are indicative only. Measurement at widest point.



# Three bedroom semi-detached house

68 Maize Crescent, Chestfield, Whitstable, Kent, CT5 3RQ



ASHP = Air source heat pump

Please speak to the sales executive for more information

Total Internal Area	94 sq m
Kitchen	5.0m x 2.6m
Living / Dining area	4.0m x 5.7m
Bedroom 1	3.3m x 3.6m
Bedroom 2	3.1m x 2.9m
Bedroom 3	3.3m x 2.5m

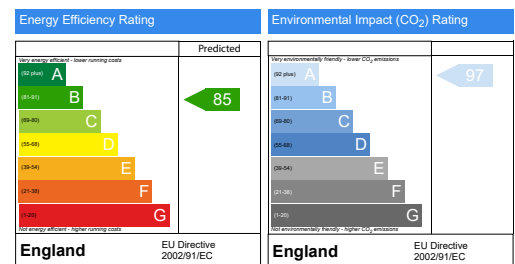

Cup'd = Cupboard, WC = Water Closet, HWC = Hot Water Cylinder, FF = Fridge Freezer, WM = Washing Machine, DW = Dishwasher, DO = Double Oven

Floor plans shown are indicative only. All room sizes are approximate with maximum dimensions of finished items of furniture. Room layouts may be subject to minor modifications. Furniture, kitchen and bathroom layouts shown are indicative only. Measurement at widest point.



# Four bedroom detached house

66 Maize Crescent, Chestfield, Whitstable, Kent, CT5 3RQ



ASHP = Air source heat pump  
Please speak to the sales executive for more information

Low ceiling

Roof light

<b>Total Internal Area</b>	<b>151 sq m</b>
Kitchen	3.6m x 2.6m
Living / Dining area	6.2m x 5.3m
Bedroom 1	3.7m x 5.3m
Bedroom 2	4.0m x 4.2m
Bedroom 3	4.1m x 2.6 m
Bedroom 4	3.3m x 2.9m
Study	4.1m x 2.6m

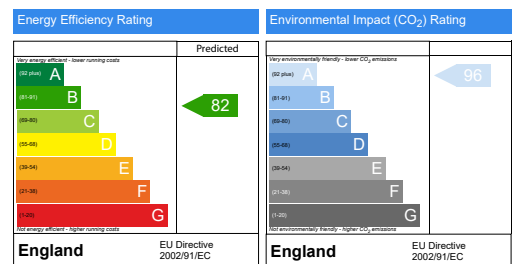

Cup'd = Cupboard, WC = Water Closet, DO = Double Oven, FF = Fridge Freezer, WM = Washing Machine, DW = Dishwasher, HWC = Hot Water Cylinder

Floor plans shown are indicative only. All room sizes are approximate with maximum dimensions of finished items of furniture. Room layouts may be subject to minor modifications. Furniture, kitchen and bathroom layouts shown are indicative only. Measurement at widest point.



## Three bedroom semi-detached house

64 Maize Crescent, Chestfield, Whitstable, Kent, CT5 3RQ



ASHP = Air source heat pump

Please speak to the sales executive for more information

Total Internal Area	94 sq m
Kitchen	5.0m x 2.6m
Living / Dining area	4.0m x 5.7m
Bedroom 1	3.3m x 3.6m
Bedroom 2	3.1m x 2.9m
Bedroom 3	3.3m x 2.5m

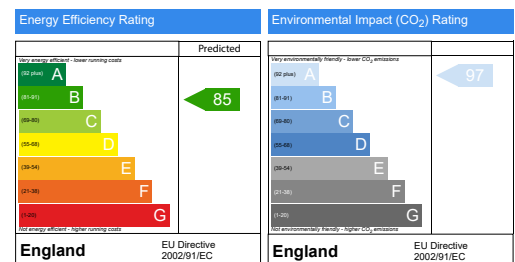

Cup'd = Cupboard, WC = Water Closet, HWC = Hot Water Cylinder, FF = Fridge Freezer, WM = Washing Machine, DW = Dishwasher, DO = Double Oven

Floor plans shown are indicative only. All room sizes are approximate with maximum dimensions of finished items of furniture. Room layouts may be subject to minor modifications. Furniture, kitchen and bathroom layouts shown are indicative only. Measurement at widest point.



160



MOAT AT  
GRASMERE GARDENS  
WHITSTABLE

# Two bedroom mid-terrace house

62 Maize Crescent, Chestfield, Whitstable, Kent, CT5 3RQ



ASHP = Air source heat pump  
Please speak to the sales executive for more information

<b>Total Internal Area</b>	<b>80 sq m</b>
Kitchen	3.9m x 2.2m
Living / Dining area	4.9m x 4.4m
Bedroom 1	3.6m x 3.2m
Bedroom 2	4.4m x 2.9m

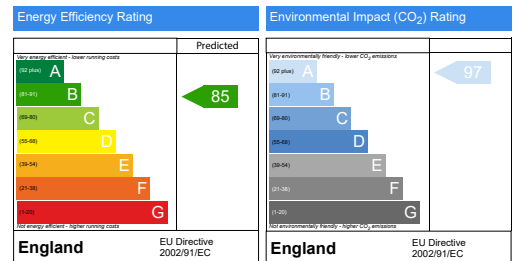

Cup'd = Cupboard, WC = Water Closet, HWC = Hot Water Cylinder, FF = Fridge Freezer, WM = Washing Machine

Floor plans shown are indicative only. All room sizes are approximate with maximum dimensions of finished items of furniture. Room layouts may be subject to minor modifications. Furniture, kitchen and bathroom layouts shown are indicative only. Measurement at widest point.



# Two bedroom semi-detached house

60 Maize Crescent, Chestfield, Whitstable, Kent, CT5 3RQ



ASHP = Air source heat pump  
Please speak to the sales executive for more information

<b>Total Internal Area</b>	<b>80 sq m</b>
Kitchen	3.9m x 2.2m
Living / Dining area	4.9m x 4.4m
Bedroom 1	3.6m x 3.2m
Bedroom 2	4.4m x 2.9m

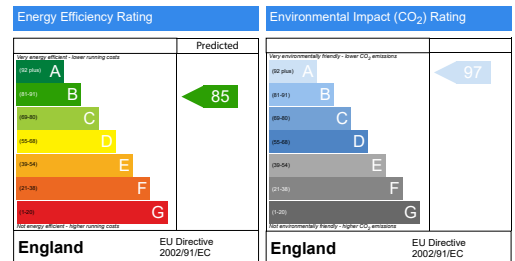

Cup'd = Cupboard, WC = Water Closet, HWC = Hot Water Cylinder, FF = Fridge Freezer, WM = Washing Machine

Floor plans shown are indicative only. All room sizes are approximate with maximum dimensions of finished items of furniture. Room layouts may be subject to minor modifications. Furniture, kitchen and bathroom layouts shown are indicative only. Measurement at widest point.



## Three bedroom semi-detached house

58 Maize Crescent, Chestfield, Whitstable, Kent, CT5 3RQ



ASHP = Air source heat pump

Please speak to the sales executive for more information

Total Internal Area	94 sq m
Kitchen	5.0m x 2.6m
Living / Dining area	4.0m x 5.7m
Bedroom 1	3.3m x 3.6m
Bedroom 2	3.1m x 2.9m
Bedroom 3	3.3m x 2.5m

Energy Efficiency Rating	Environmental Impact (CO <sub>2</sub> ) Rating
<p>England</p> <p>EU Directive 2002/91/EC</p>	<p>England</p> <p>EU Directive 2002/91/EC</p>

Cup'd = Cupboard, WC = Water Closet, HWC = Hot Water Cylinder, FF = Fridge Freezer, WM = Washing Machine, DW = Dishwasher, DO = Double Oven

Floor plans shown are indicative only. All room sizes are approximate with maximum dimensions of finished items of furniture. Room layouts may be subject to minor modifications. Furniture, kitchen and bathroom layouts shown are indicative only. Measurement at widest point.



# Four bedroom detached house

56 Maize Crescent, Chestfield, Whitstable, Kent, CT5 3RQ



ASHP = Air source heat pump  
Please speak to the sales executive for more information

Low ceiling

Roof light

<b>Total Internal Area</b>	<b>151 sq m</b>
Kitchen	3.6m x 2.6m
Living / Dining area	6.2m x 5.3m
Bedroom 1	3.7m x 5.3m
Bedroom 2	4.0m x 4.2m
Bedroom 3	4.1m x 2.6 m
Bedroom 4	3.3m x 2.9m
Study	4.1m x 2.6m

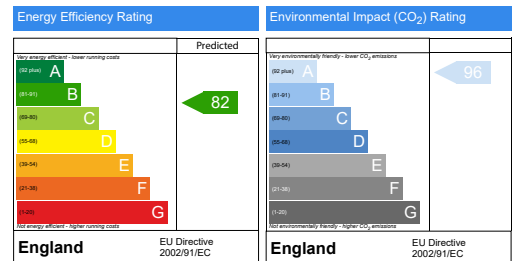

Cup'd = Cupboard, WC = Water Closet, DO = Double Oven, FF = Fridge Freezer, WM = Washing Machine, DW = Dishwasher, C = Hot Water Cylinder

Floor plans shown are indicative only. All room sizes are approximate with maximum dimensions of finished items of furniture. Room layouts may be subject to minor modifications. Furniture, kitchen and bathroom layouts shown are indicative only. Measurement at widest point.



## Three bedroom semi-detached house

54 Maize Crescent, Chestfield, Whitstable, Kent, CT5 3RQ



ASHP = Air source heat pump

Please speak to the sales executive for more information

Total Internal Area	94 sq m
Kitchen	5.0m x 2.6m
Living / Dining area	4.0m x 5.7m
Bedroom 1	3.3m x 3.6m
Bedroom 2	3.1m x 2.9m
Bedroom 3	3.3m x 2.5m

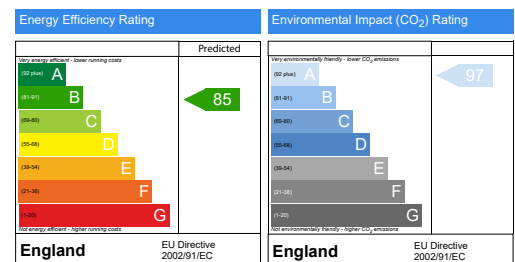

Cup'd = Cupboard, WC = Water Closet, HWC = Hot Water Cylinder, FF = Fridge Freezer, WM = Washing Machine, DW = Dishwasher, DO = Double Oven

Floor plans shown are indicative only. All room sizes are approximate with maximum dimensions of finished items of furniture. Room layouts may be subject to minor modifications. Furniture, kitchen and bathroom layouts shown are indicative only. Measurement at widest point.

144



MOAT AT  
GRASMERE GARDENS  
WHITSTABEE

# Two bedroom semi-detached house

14 Darnel Avenue, Chestfield, Whitstable, Kent, CT5 3RR



ASHP = Air source heat pump  
Please speak to the sales executive for more information

<b>Total Internal Area</b>	<b>82 sq m</b>
Kitchen / Living / Dining area	5.6m x 7.4m
Bedroom 1	3.3m x 3.8m
Bedroom 2	4.0m x 3.3 m

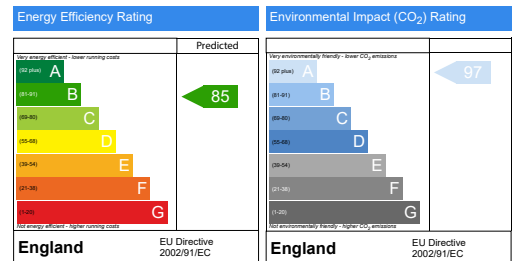

Cup'd = Cupboard, WC = Water Closet, B = HWC = Hot Water Cylinder = Fridge Freezer, WM = Washing Machine

Floor plans shown are indicative only. All room sizes are approximate with maximum dimensions of finished items of furniture. Room layouts may be subject to minor modifications. Furniture, kitchen and bathroom layouts shown are indicative only. Measurement at widest point.





# Two bedroom semi-detached house

16 Darnel Avenue, Chestfield, Whitstable, Kent, CT5 3RR



ASHP = Air source heat pump  
Please speak to the sales executive for more information

Total Internal Area	80 sq m
Kitchen	3.9m x 2.2m
Living / Dining area	4.9m x 4.4m
Bedroom 1	3.6m x 3.2m
Bedroom 2	4.4m x 2.9m

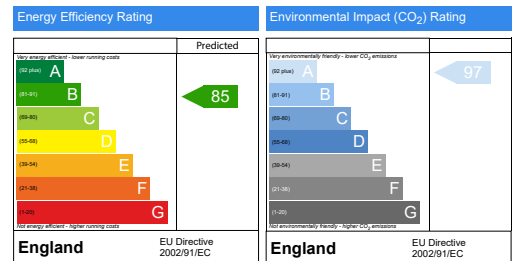

Cup'd = Cupboard, WC = Water Closet, HWC = Hot Water Cylinder, FF = Fridge Freezer, WM = Washing Machine

Floor plans shown are indicative only. All room sizes are approximate with maximum dimensions of finished items of furniture. Room layouts may be subject to minor modifications. Furniture, kitchen and bathroom layouts shown are indicative only. Measurement at widest point.