

# The Bourne

## 3 Bedroom House

Kitchen/dining	4.83m x 3.95m	15'10" x 12'11"
Living	4.80m x 3.77m	15'9" x 12'4"
Bedroom 1	4.83m x 2.74m	15'10" x 8'12"
Bedroom 2	4.01m x 2.38m	13'2" x 7'10"
Bedroom 3	3.61m x 2.39m	11'10" x 7'10"
Bathroom	2.59m x 1.97m	8'6" x 6'5"

Total Floor Area: 85.30m<sup>2</sup> - 918.21sq.ft

**Please note:** All dimensions are taken from the widest and longest points of each room. Some properties will be 'handed' (mirror image) to floorplan shown.

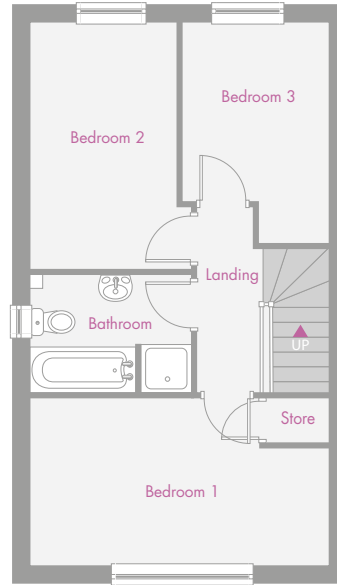
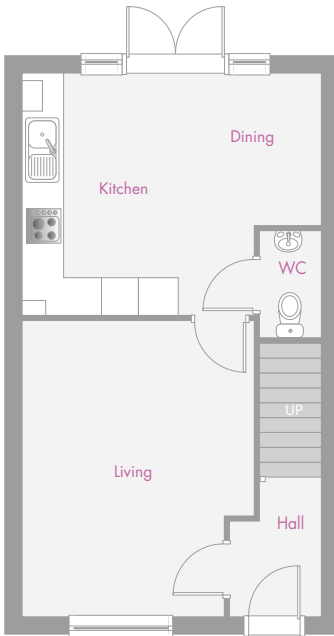

## Specification

- Fitted kitchen with oven, hob & extractor
- Bathroom with separate shower
- Double glazed windows
- Carpets & flooring throughout
- Gas central heating
- Turfed rear garden
- Parking
- NHBC warranty

Please note CGI's are for illustrative purposes only; external finishes including roof tile colours, brick, stone, render and landscaping may vary between plots. Properties may also be built 'handed' (mirror image) of those illustrated. Midland Heart reserves the right to alter and change certain aspects of a property – therefore it is recommended that you speak to a sales consultant for further details. All dimensions are taken from the widest and longest points of each room; they are approximate and should not be used for carpet sizes, appliance spaces and furniture. These particulars do not form part of a contract or warranty.

For further details contact  
our sales team on:

**0800 44 55 67**

or email:

[sales@midlandheart.org.uk](mailto:sales@midlandheart.org.uk)

**midland**  
heart