

Type 4B

2 bedroom apartment

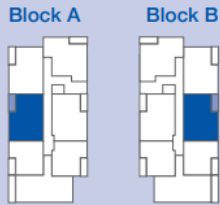

Plots	Floor
Block A	
08	First
15	Second
Block B*	
22	Ground
29	First
36	Second

* Plots are handed



Gross Internal Floor Area

74.6 m²
803 sq ft

Room	Metric	Imperial
Kitchen / Dining / Living	6.0 x 3.9 m	19'11" x 13'1"
Bedroom 1	4.2 x 2.8 m	13'10" x 9'6"
Bedroom 2	4.2 x 3.4 m	13'10" x 11'2"
Balcony*	3.5 x 1.1 m	11'9" x 3'8"

*Balcony to 1st & 2nd Floors only

FF	Fridge/Freezer
DW	Dishwasher
WD	Washer/Dryer
B	Boiler

All floor plans in this brochure are for general guidance only. All room dimensions are subject to a plus/minus 5% tolerance. Measurements are taken from plans representing the largest cross-section of each room - the actual build may vary. Any dimensions shown are not intended to be used for carpet sizes, appliances, spaces or items of furniture. These particulars do not constitute any part of an offer or contract with regard to the specifications.