

# The Chaddock Kiln Nook

Three-bedroom home, sleeps five

3 | 

2 | 

1 | 



## Key features

- Two double bedrooms
- Downstairs W.C.
- En-suite from master bedroom
- Open plan kitchen and dining room
- Separate living room
- Driveway parking



## The Chaddock

Available plots

Shared ownership

1

Rent to Buy

10 or 21

Woodbank Street, Burslem, ST6 3AZ

A collection of 43 beautifully designed new homes

# The Chaddock Kiln Nook

Three-bedroom home, sleeps five

Ground floor

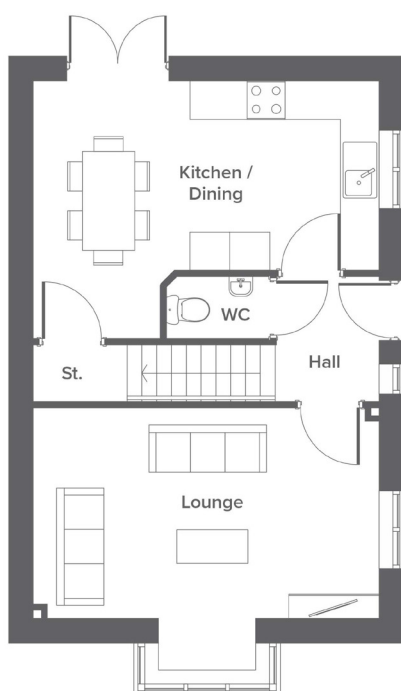

First floor

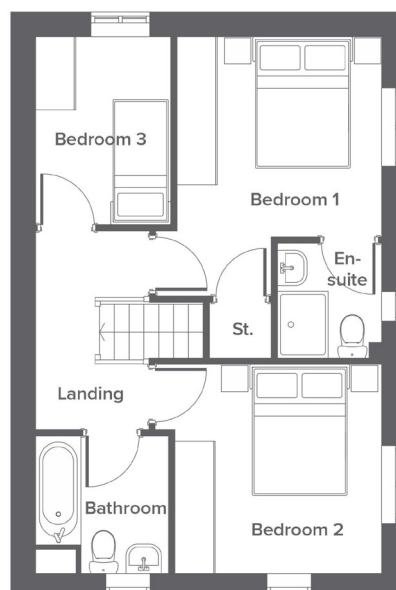

Room	Metric	Imperial
Kitchen/Dining	5.3 x 3.9	17'5" x 11'11"
Lounge	5.3 x 3.2	17'5" x 10'7"
W.C.	1.6 x 0.9	5'2" x 3'2"

Room	Metric	Imperial
Bedroom 1	3.1 x 3.9	10'4" x 12'11"
Bedroom 2	3.1 x 3.2	10'4" x 10'7"
Bedroom 3	2.0 x 2.8	6'9" x 9'4"
Bathroom	2.0 x 2.1	6'8" x 7'0"
En-suite	1.6 x 1.75	5'2" x 5'8"

Total size **90m<sup>2</sup> / 968.8ft<sup>2</sup>**

## Get in touch

 01782 491464

 [yourhousinggroup.co.uk](https://yourhousinggroup.co.uk)

 @yourhousing

 yourhousinggroup

 [youtube.com/yhgtv](https://youtube.com/yhgtv)