

Abbeville Park

The Thetford 3 bedroom home



Abbeville Park

The Thetford 3 bedroom home

104 sq m / 1,122 sq ft

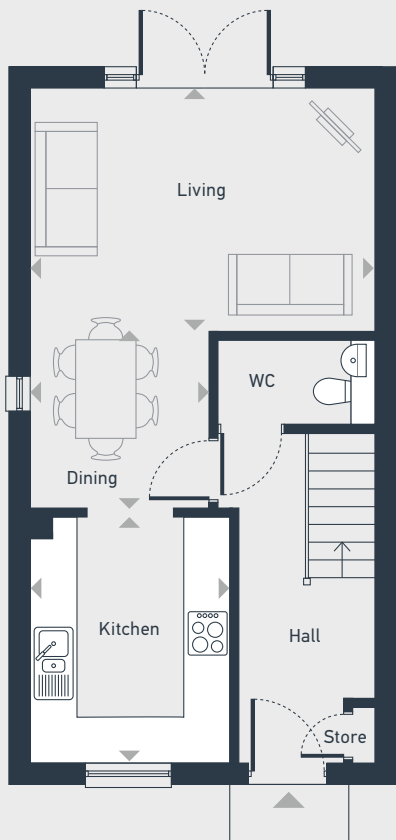

GROUND FLOOR

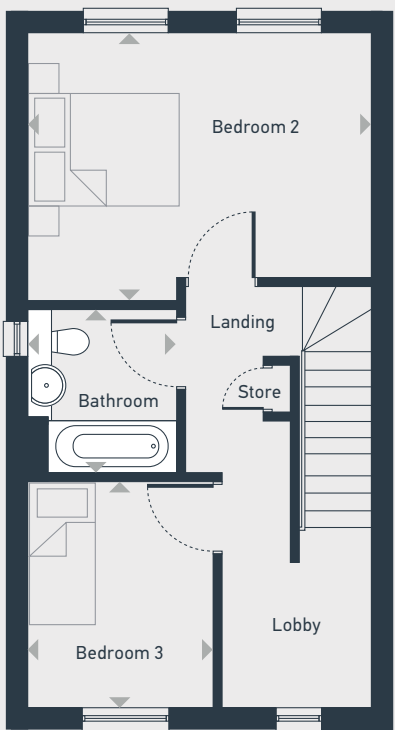

FIRST FLOOR

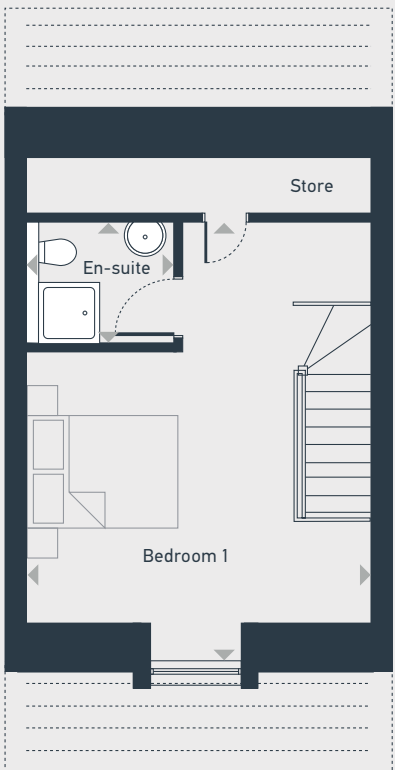

SECOND FLOOR

GROUND FLOOR	m	ft	FIRST FLOOR	m	ft	SECOND FLOOR	m	ft
Living	4.53m x 3.24m	14'10" x 10'8"	Bedroom 2	4.53m x 3.52m	14'10" x 11'7"	Bedroom 1	5.86m x 4.24m	19'3" x 13'11"
Kitchen	3.27m x 2.64m	10'9" x 8'8"	Bedroom 3	3.03m x 2.47m	9'11" x 8'1"	Bedroom 3	3.03m x 2.47m	6'6" x 5'4"
Dining	2.37m x 2.32m	7'9" x 7'7"	Bathroom	2.15m x 1.95m	7'1" x 6'5"			



01444 360 065 | placesforpeople.co.uk/abbevillepark
Abbeville Park, Fairbridge Way, Burgess Hill, West Sussex RH15 8BF

Please note: All layouts and floor plans, configurations, maps and information are intended for guidance only and accuracy of this information cannot be relied upon by prospective purchasers who must make their own enquiries to satisfy themselves by inspection or otherwise as to the correct detail. Sizes and dimensions approximate and subject to change.