



6, 8 & 10 PLEASANTS AVENUE
PORINGLAND



KEY FEATURES

- Shares from 40%
- 2 Bedrooms
- 2 Parking Spaces
- Option to Staircase to 100%

SHARED OWNERSHIP

DISCOVER YOUR NEW HOME

6, 8 & 10 Pleasants Avenue are a selection of 2 bedroom homes on the popular Norfolk Homes development in Poringland. These 2 bedroom homes have a kitchen/diner, separate lounge, family bathroom, two parking spaces and private garden. Initial shares start from 40% - 75% with the option to 100% staircase in the future.



01603 750150

Monday - Friday



sales@broadlandgroup.org

SHARE EXAMPLE

Full Market Value

6, 8 & 10 Pleasants Avenue

£265,000

Service Charge

£25.00pm (25/26 estimate)

Includes buildings insurance

Share	Rent
40% £106,000	£364.38pm
50% £132,500	£303.65pm
60% £159,000	£242.92pm
75% £198,750	£151.82pm

FLOOR PLAN

All measurements are approximate and should be used as a guide only. It is recommended that buyers take their own measurements for the purposes of ordering furniture, blinds or flooring.

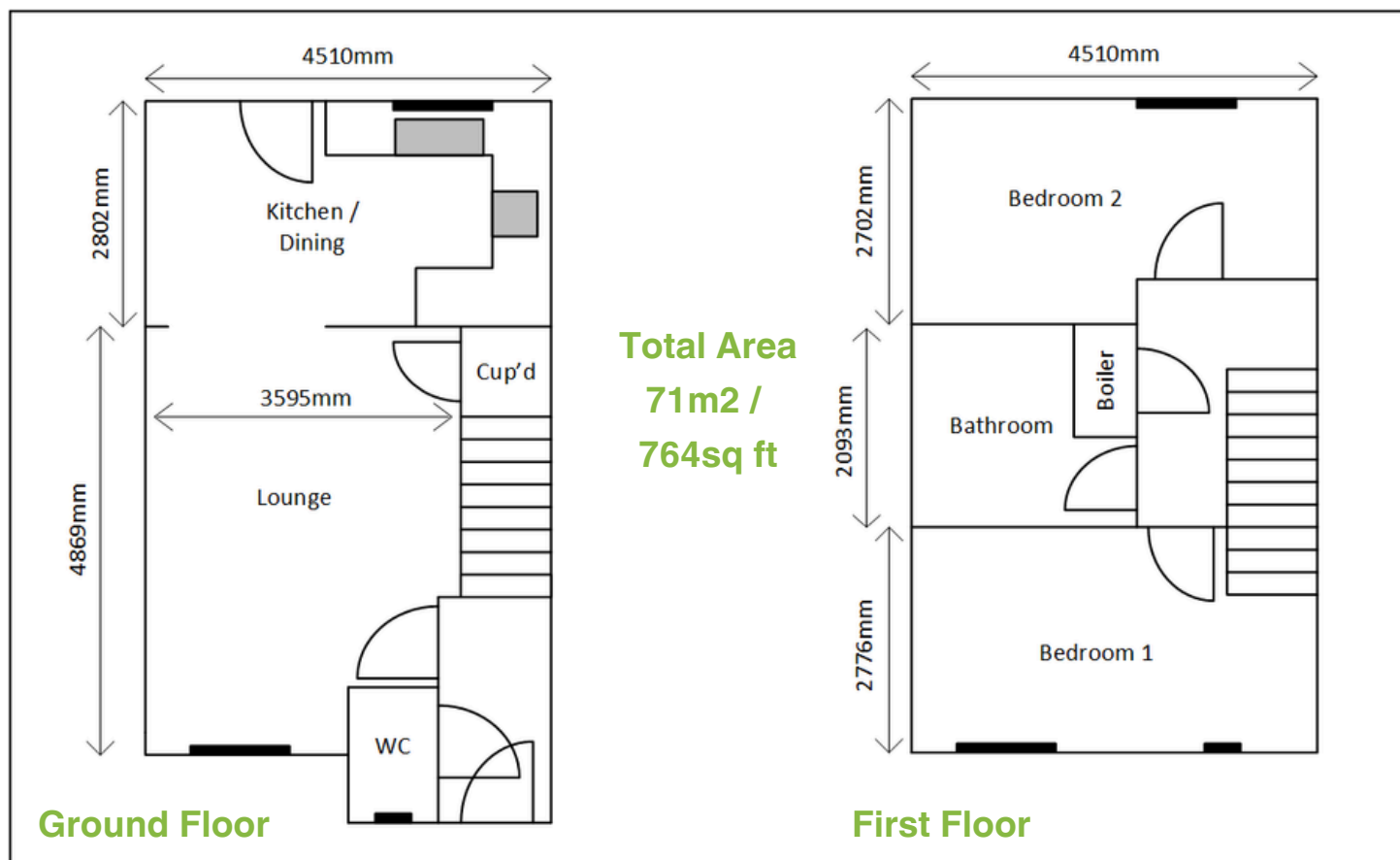

01603 750150

Monday - Friday



sales@broadlandgroup.org