



**42 & 44 PONSONBY WAY
PORINGLAND**



KEY FEATURES

- Shares from 40%
- 3 Bedrooms
- 2 Parking Spaces
- Option to Staircase to 100%

SHARED OWNERSHIP

DISCOVER YOUR NEW HOME

42 & 44 Ponsonby Way are a pair of 3 bedroom homes on the popular Norfolk Homes development in Poringland. These 3 bedroom homes have a kitchen/diner, separate lounge, family bathroom, two parking spaces and private garden. Initial shares start from 40% - 75% with the option to 100% staircase in the future.



01603 750150

Monday - Friday



sales@broadlandgroup.org

SHARE EXAMPLE

Service Charge
£25.00pm (25/26 estimate)
Includes buildings insurance

Full Market Value
42 Ponsonby Way
£295,000

Share	Rent
40% £118,000	£405.63pm
50% £147,500	£338.02pm
60% £177,000	£270.42
75% £221,250	£169.01pm

Full Market Value
44 Ponsonby Way
£285,000

Share	Rent
40% £114,000	£391.88pm
50% £142,500	£326.56pm
60% £171,000	£261.25
75% £213,750	£163.28pm

FLOOR PLAN

All measurements are approximate and should be used as a guide only. It is recommended that buyers take their own measurements for the purposes of ordering furniture, blinds or flooring.

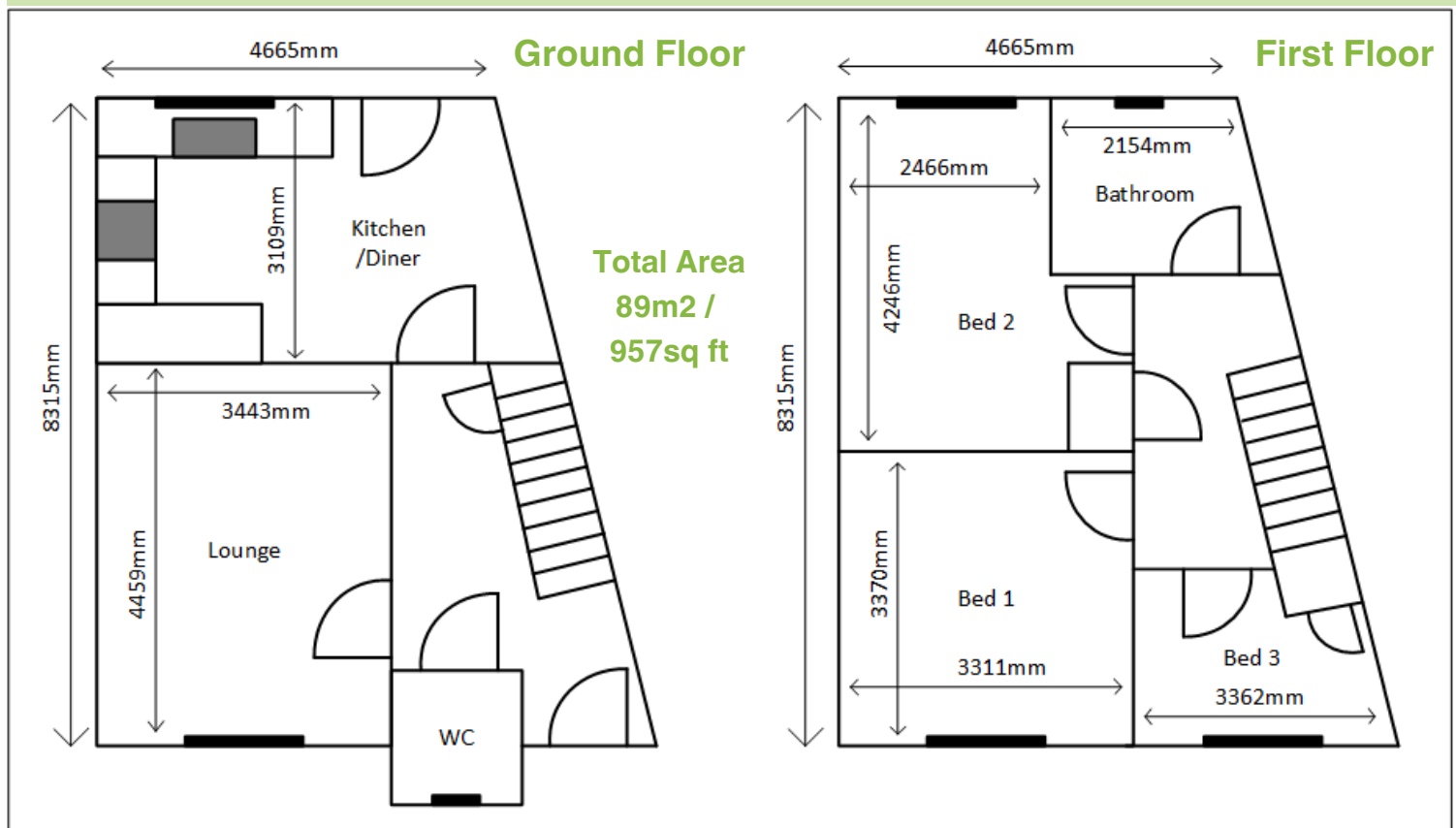

01603 750150

Monday - Friday



sales@broadlandgroup.org