



BANBURY RISE

A STUNNING COLLECTION OF 3 BEDROOM
SHARED OWNERSHIP HOMES



Marketing and Sales Brand
domovohomes.co.uk

UNCOVER A NEW WAY TO LIVE

Discover Banbury Rise, an inspiring new development on the outskirts of Banbury, offering a stunning collection of 3 bedroom shared ownership homes.

Banbury Rise perfectly blends modern comfort with the charm of the Oxfordshire countryside. Whether you're taking your first step onto the property ladder or looking to put down roots, shared ownership makes homeownership more accessible and achievable.



**PERFECTLY
BLENDS MODERN
COMFORT WITH
THE CHARM OF
THE OXFORDSHIRE
COUNTRYSIDE.**

SEAMLESS COMMUTING CONNECTIONS

Banbury Rise offers excellent transport links, making it easy to stay connected whether you're commuting for work or exploring further afield.

Banbury train station provides direct services to London Marylebone, Birmingham, and Oxford, while the nearby M40 ensures quick access to major road networks.

With reliable bus routes and cycle-friendly paths, getting around is effortless - allowing you to experience the perfect balance of countryside living with city convenience.



IMMERSE YOURSELF IN A VIBRANT COMMUNITY

Banbury Rise offers more than just a home - it's a place where connections are made, and a true sense of belonging thrives.

Stroll through the local shops, relax in welcoming cafés, and enjoy the open green spaces that bring people together.

With excellent schools, healthcare facilities, and a variety of leisure options close by, everything you need is within easy reach. Whether you're exploring scenic countryside trails, uncovering hidden gems at the local markets, or simply soaking up the friendly atmosphere, you'll find yourself right at home in this inspiring community.



- Castle Quay Shopping Centre
1.8 MILES
- Aldi
1.8 MILES
- Banbury Train Station
2 MILES
- Oxford
33 MILES



- Birmingham Moor Street*
53 MINS
- London Marylebone*
1 HR 5 MINS
- Bournemouth*
2 HR 18 MINS
- Manchester Piccadilly*
2 HR 31 MINS



- Cush Park
0.7 MILES
- Pure Gym Banbury
1.8 MILES
- Spiceball Leisure Centre
1.8 MILES



- Trinity Park
0.2 MILES
- Orchard Fields Community Primary
0.7 MILES
- Orchard Park
1.1 MILES
- Tesco Extra
1.6 MILES

Distance calculated by Google Maps. *Times taken from Trainline.

3 BEDROOM HOMES

Our homes offer flexibility for every day living, with a spacious downstairs perfect for both modern life and cosy nights in. Upstairs, enjoy the spacious bedrooms and a stylish, well-equipped bathroom.



PLOT 495

DIMENSIONS

Kitchen/Dining*	4.75m x 2.84m 15'07" x 9'04"
Lounge	4.75m x 3.67m 15'07" x 12'01"
Bedroom 1*	4.75m x 2.84m 15'07" x 9'04"
Bedroom 2*	3.67m x 2.70m 12'01" x 8'10"
Bedroom 3*	3.73m x 1.97m 12'03" x 6'06"

GROUND FLOOR

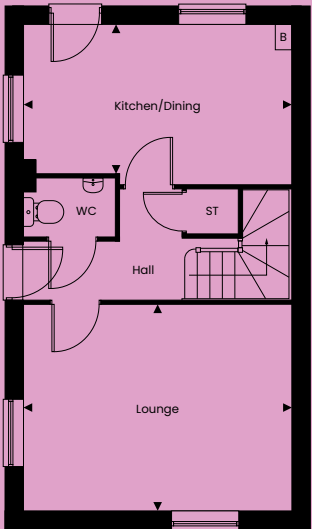

FIRST FLOOR

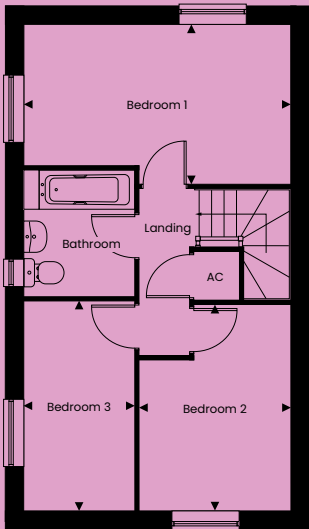

GROUND FLOOR

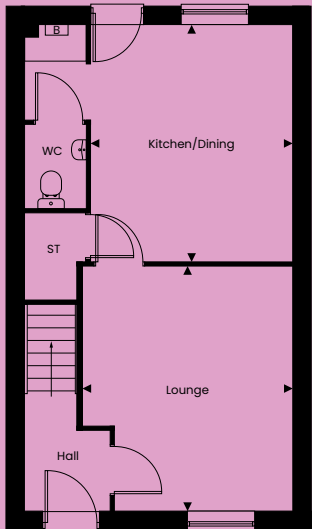

FIRST FLOOR

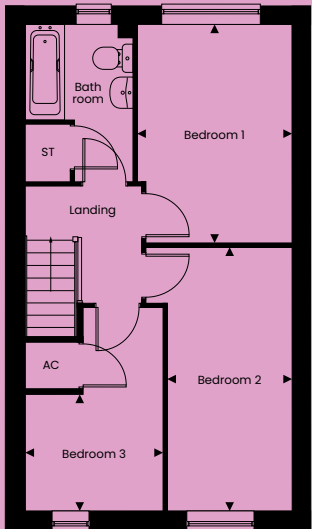

PLOT 496

DIMENSIONS

Kitchen/Dining	4.22m x 3.60m 13'10" x 11'10"
Lounge*	4.35m x 3.74m 14'04" x 12'03"
Bedroom 1*	3.88m x 2.65m 12'09" x 8'08"
Bedroom 2	4.69m x 2.22m 15'05" x 7'04"
Bedroom 3	2.44m x 2.07m 8'00" x 6'10"

Max measurements taken. CGI's are intended for illustrative purposes only.

DEVELOPMENT LAYOUT

	Shared Ownership Plots 495 & 496	3 Bedroom Home
	bpha Affordable Rent Plots 505-510 Plots 491, 492, 501 & 502 Plots 503, 504 Plots 498-500, 511-513 Plot 497	1 Bedroom Apartment 1 Bedroom Maisonette 2 Bedroom House 3 Bedroom House 4 Bedroom House
	Developer Buying Scheme	
	Developer Outright Sales	
	Cycle Store	



HOMES DESIGNED FOR LIVING



KITCHEN

Hacienda platinum kitchen cupboards

Marble Sirocco worktop with upstand

Built in oven, gas hob and extractor hood

Stainless steel splashback

Vinyl flooring



BATHROOM

Shower over bath

Glass shower screen

Chrome towel rail

Wall tiling to wet areas

Vinyl flooring



GENERAL

PV panels

Carpet to dry areas

Gas central heating

Private garden with turf

Rotary dryer

Two car parking spaces

Electric vehicle charging point

Speak to Sales Advisor for more information

Specification subject to change

SHARED OWNERSHIP THE OPTION YOU NEVER KNEW EXISTED

Shared Ownership* enables you to buy an initial share of a property and pay a subsidised rent on the rest, meaning you can get into home ownership in manageable stages and don't take on more of a financial commitment than you can afford.

Initial shares of between 10% and 75%** of our properties are available, you will pay a subsidised rent on the remaining share. In the future you can purchase further shares in your home***, or sell your share and move on.

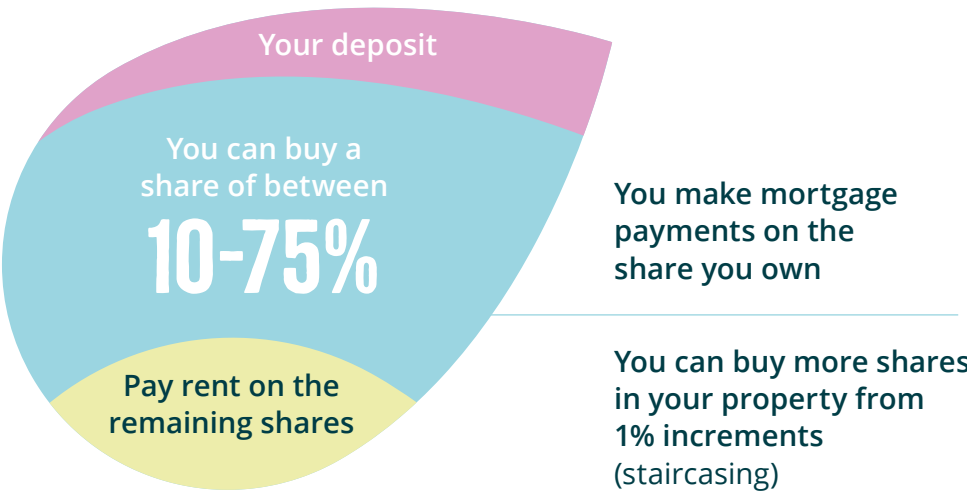

VIEW OUR GUIDE TO
SHARED OWNERSHIP
BROCHURE



FIND OUT MORE ABOUT
BPHA STAIRCASING

* Properties are offered as leasehold, with a lease term of 999 years.
** Shares offered are based on the affordability determined by an Independent Mortgage Advisor.
*** Some properties are restricted to the level of share you can purchase.



MY SHARED OWNERSHIP JOURNEY

LILY

After a relationship change, Lily needed a new home that could accommodate both her and her dog, Ernie.

She discovered a 2 bedroom house on Rightmove through Domovo's Shared Ownership scheme and found the entire process seamless. "I registered my interest and the sales team were great. From start to finish, it only took three months – it was so quick and straightforward.

"When you think of shared ownership, you think it's just for first-time buyers, but it's also great for single people who may have had to take a step backwards due to circumstances beyond their control."

The home itself exceeded Lily's expectations: "The rooms are spacious, well-maintained and even matched my décor style. It's the dreamiest property I could've imagined; it felt meant to be."

She was also thrilled with the location, staying close to her favourite dog walking routes, gym and friends.



With an initial 35% share, Lily appreciates the flexibility Domovo offers: "Knowing I can staircase at any time helped me make the decision."

Finding this home with Domovo allowed Lily to stay on the property ladder and start a new in a place she loves.



READ LILY'S
FULL STORY



BANBURY RISE



bpha is a Housing Association located in the Oxford to Cambridge arc, which is committed to providing its customers with high quality, energy efficient, sustainable and affordable housing. Our vision is to build quality homes and connected communities whilst delivering a great service and value to customers. We are proud to be delivering these homes in partnership with Bloor Homes.

sales@domovohomes.co.uk

01234 674070

Banbury Rise, Bedlow Close, Banbury, OX16 1LT

A development by
bpha.org.uk



Marketing and
Sales Brand
domovohomes.co.uk



Whilst we endeavour to make our property details accurate and reliable, these particulars are set out as a general outline only for the guidance of intended purchasers or lessees and do not constitute as a full or part offer or contract. Other details are given without responsibility and intending purchasers or tenants should not rely on them as statements or representations of fact but must satisfy themselves by inspection or otherwise as to the correctness of them. The purchaser is advised to obtain verification from their Solicitor or Surveyor to their own satisfaction.