



Lidlington GARDENS

A selection of 2, 3 & 4 bedroom homes
in Bedfordshire

Enjoy country living with big-city access



Marketing and Sales Brand
domovohomes.co.uk





Looking for countryside living with big-city access?

Our homes offer thoughtful layout and distinctive design in the heart of the Bedfordshire countryside, with three major towns and cities close by.

With spacious living areas designed for everyday comfort, thoughtfully designed bedrooms for restful nights, and stylish bathrooms that feel like a retreat, Lidlington Gardens offers the perfect space to live life your way.

Lidlington Gardens offers a charming collection of two, three and four-bedroom homes boasting classic design for modern living. Perfect for couples, families and those wishing to downsize.

Live life your way

Lidlington Gardens offers an exciting opportunity for a village lifestyle without feeling disconnected.



CGI's for illustrative purposes only.
Gradient not to scale

Enjoy village life

Village life is on your doorstep in Lidlington: surrounded by picturesque scenery, the village features key amenities such as a village shop and pub, plus plenty of woodland walks and easy access to the local lake, popular for birdwatching, fishing and windsurfing.

Just over a mile away, Marston Vale Millennium Country park also provides plenty of trails, with a much-loved community wild-flower garden overlooking the lake, popular for birdwatching, fishing and windsurfing. There's even a local viewpoint overlooking the green fields!

For those looking to get stuck into village life, Lidlington has a village hall, sports pavilion and plenty of parks. Just over a mile away.



Those looking to keep their fingers on the pulse will enjoy the accessibility of thriving Milton Keynes and charming market town Bedford. These bustling hubs, shopping trips and nights out offer plenty of cultural highlights.

Close to city lights!

For commuters, Lidlington is well-positioned at just 3 ½ miles from the M1 and even boasts its own train station on the Bedford-Bletchley line travelling east to west. Convenient access to London via Flitwick train station on the north to south line.



From Lidlington Gardens

Milton Keynes

11 Miles

Woburn Safari Park

2.9 Miles

Centre Parcs

3 Miles

Bedford

12 Miles

Luton

17 Miles

Whipsnade Zoo

18 Miles



From Flitwick Station*

Luton

13mins

St Albans

26mins

Luton airport

30min

St Pancras

51mins

Distance calculated by Google Maps.

*times taken from London Northwestern Railway

Site Layout



Disclaimer: Whilst we endeavour to make our property details accurate and reliable these particulars are set out as a general outline only for guidance of intended purchasers or lessees and do not constitute as a full or part offer or contract. Other details are given without responsibility and intending purchasers or tenants should not only rely on them as statements or representations of fact but must satisfy themselves by inspection or otherwise as to the correctness of them. The purchaser is advised to obtain verification from their Solicitor or Surveyor to their own satisfaction. Retaining walls and gradients not shown.



CGI's for illustrative purposes only. Gradient not to scale

Two Bedroom House

Plots 1, 2*, 3 & 4*

*Plots 2 & 4 are mirrored to layout shown

dimensions

| | | |
|------------|---------------|-----------------|
| Kitchen | 4.54m x 2.46m | 14'10" x 8'00" |
| Lounge | 4.56m x 3.20m | 14'11" x 10'05" |
| Bedroom 1* | 4.56m x 3.17m | 14'11" x 10'04" |
| Bedroom 2* | 4.56m x 3.51m | 14'11" x 11'06" |

*max measurement taken

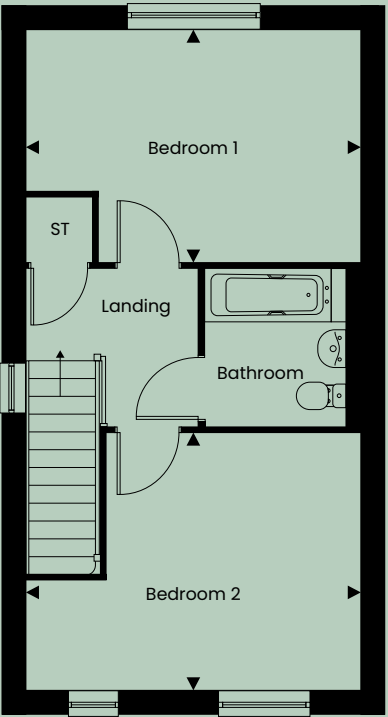
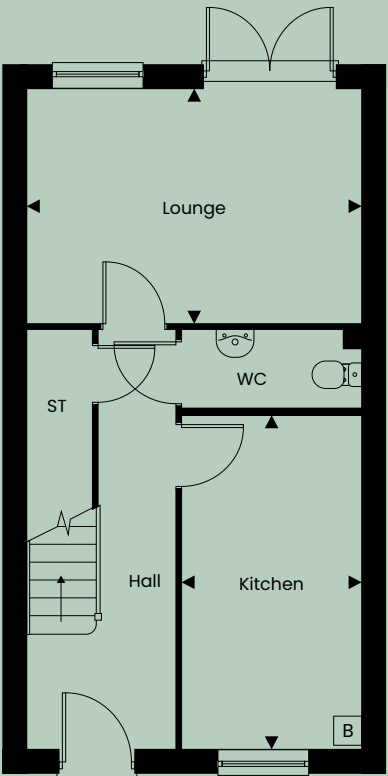



CGI's for illustrative purposes only. Gradient not to scale

Three Bedroom House

Plots 5, 6*, 7*, 38, 39 & 40*

*Plots 6, 7 & 40 are mirrored to layout shown

dimensions

| | | |
|----------------|---------------|-----------------|
| Kitchen/Dining | 5.46m x 3.24m | 17'10" x 10'07" |
| Lounge | 3.68m x 3.33m | 12'00" x 10'11" |
| Bedroom 1 | 4.36m x 2.79m | 14'03" x 9'01" |
| Bedroom 2* | 3.12m x 2.95m | 10'02" x 9'08" |
| Bedroom 3 | 3.22m x 2.28m | 10'06" x 7'05" |

*max measurement taken

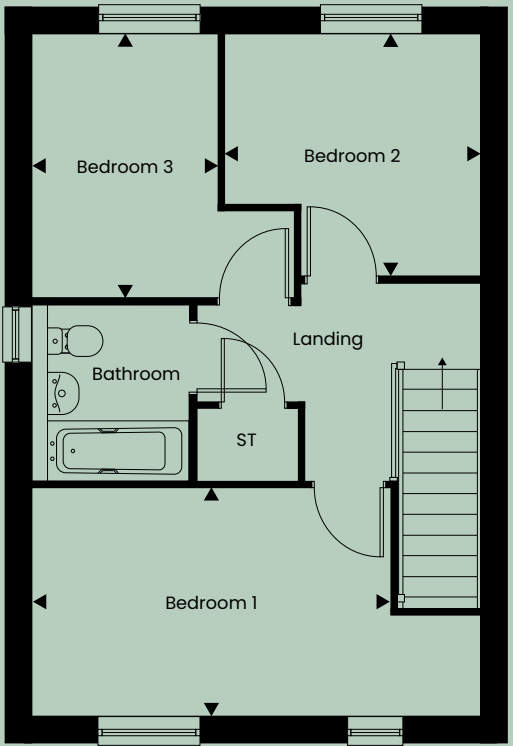
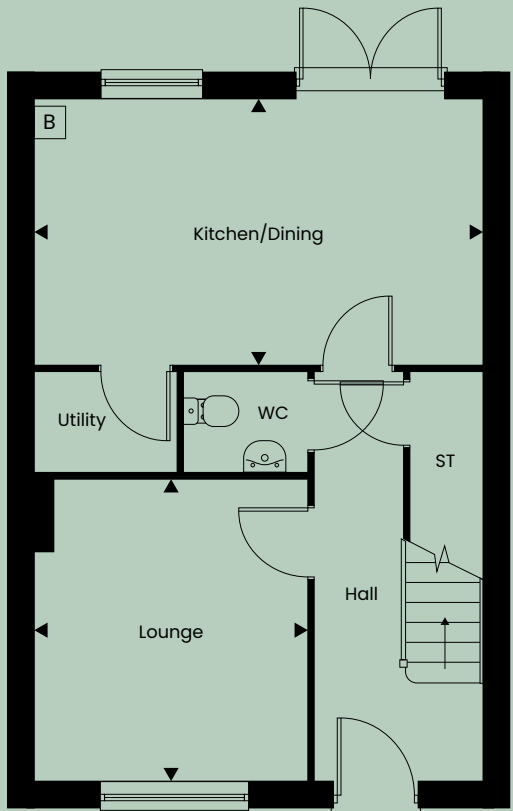



CGI's for illustrative purposes only. Gradient not to scale

Three Bedroom House

Plot 10

dimensions

| | |
|-----------------|----------------------------------|
| Kitchen/Dining* | 5.47m x 3.14m 17'11" x 10'03" |
| Lounge | 4.50m x 3.37m 14'09" x 11'00" |
| Bedroom 1 | 4.38m x 3.03m 14'04" x 9'11" |
| Bedroom 2 | 3.76m x 3.16m 12'04" x 10'04" |
| Bedroom 3 | 3.76m x 2.26m 12'04" x 7'04" |

*max measurement taken

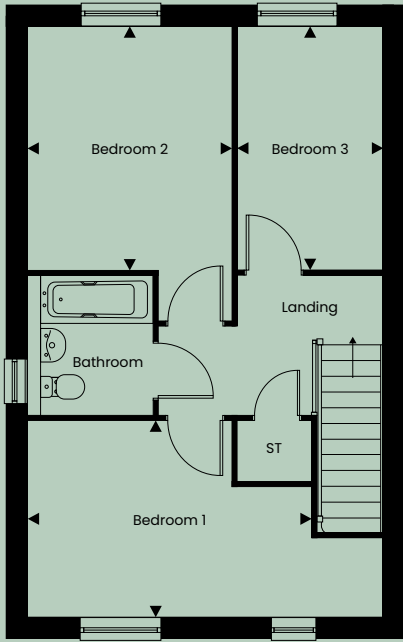
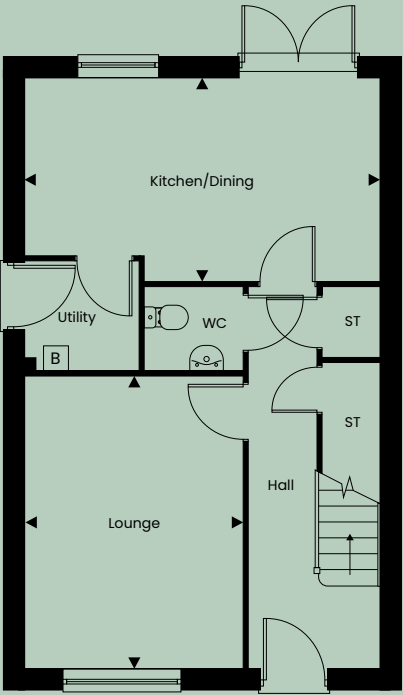

CGI's for illustrative purposes only. Gradient not to scale

Three Bedroom House

Plot 11

dimensions

| | |
|-----------------|----------------------------------|
| Kitchen/Dining* | 5.91m x 3.08m 19'04" x 10'01" |
| Lounge | 5.91m x 2.96m 19'04" x 9'08" |
| Bedroom 1 | 3.40m x 3.40m 11'01" x 11'01" |
| Bedroom 2 | 5.05m x 2.54m 16'06" x 8'04" |
| Bedroom 3 | 3.13m x 2.45m 10'03" x 8'00" |

*max measurement taken

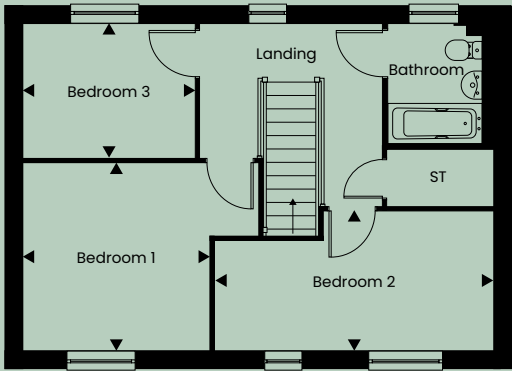
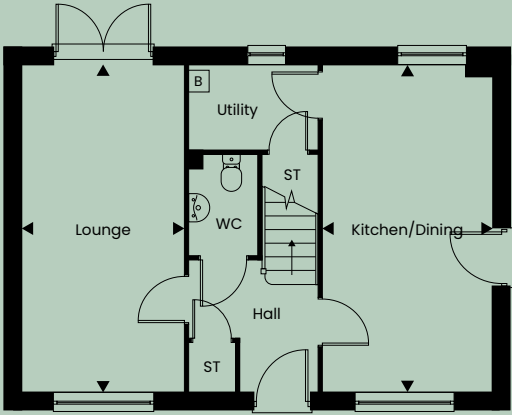



CGI's for illustrative purposes only. Gradient not to scale

Three Bedroom House

Plots 14, 15*, 20, 21*, 34, 35*, 36 & 37*

*Plots 15, 21, 35 & 37 are mirrored to layout shown

dimensions

| | |
|-----------------|----------------------------------|
| Kitchen/Dining* | 5.47m x 3.14m 17'11" x 10'03" |
| Lounge | 4.50m x 3.37m 14'09" x 11'00" |
| Bedroom 1 | 4.38m x 3.03m 14'04" x 9'11" |
| Bedroom 2 | 3.76m x 3.16m 12'04" x 10'04" |
| Bedroom 3 | 3.76m x 2.26m 12'04" x 7'04" |

*max measurement taken

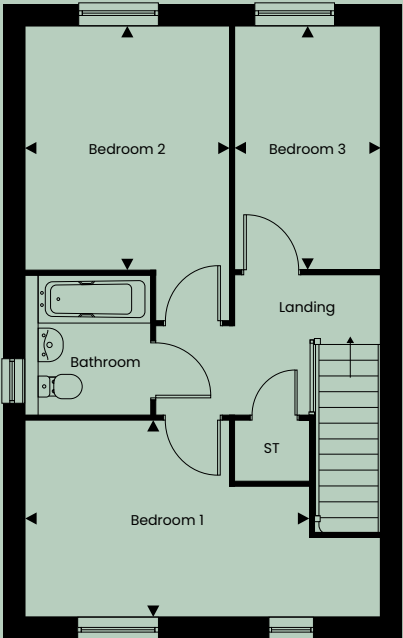
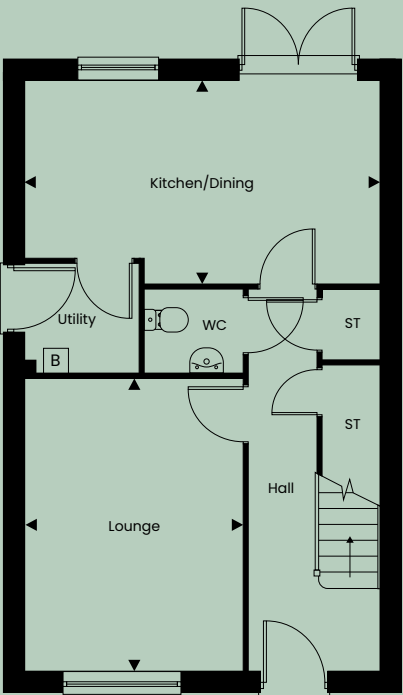

CGI's for illustrative purposes only. Gradient not to scale

Three Bedroom House

Plots 16*, 17, 18* & 19

*Plots 16 & 18 are mirrored to layout shown

dimensions

| | |
|----------------|----------------------------------|
| Kitchen/Dining | 5.46m x 3.24m 17'10" x 10'07" |
| Lounge | 3.68m x 3.33m 12'00" x 10'11" |
| Bedroom 1 | 4.37m x 2.95m 14'04" x 9'08" |
| Bedroom 2 | 3.05m x 2.34m 10'00" x 7'08" |
| Bedroom 3* | 3.07m x 3.05m 10'00" x 10'00" |

*max measurement taken

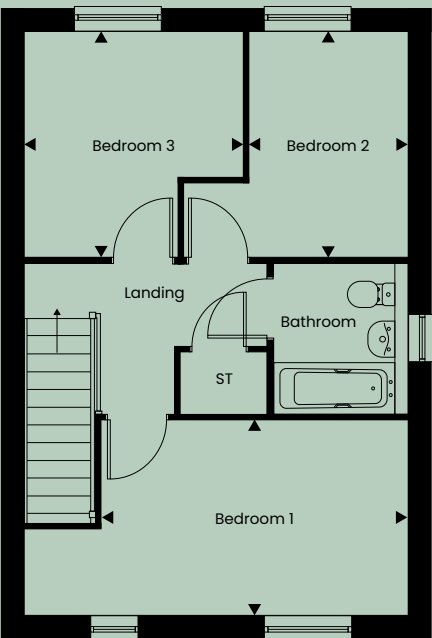
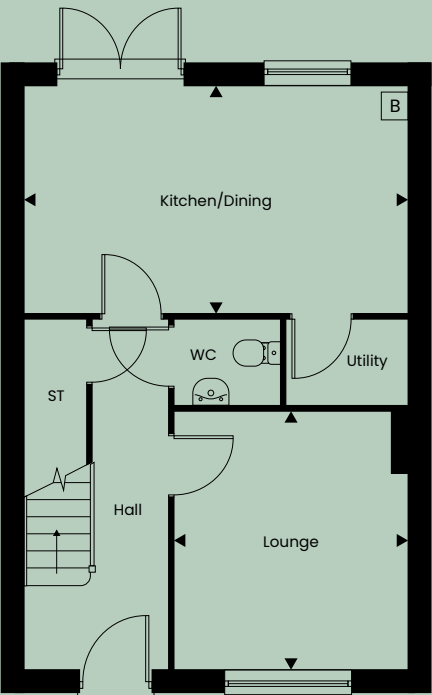



CGI's for illustrative purposes only. Gradient not to scale

Four Bedroom House

Plots 8 & 9*

*Plots 9 are mirrored to layout shown

dimensions

| | |
|----------------|----------------------------------|
| Kitchen/Dining | 5.79m x 4.13m 18'11" x 13'06" |
| Lounge | 4.61m x 3.38m 15'01" x 11'01" |
| Bedroom 1 | 3.70m x 3.34m 12'01" x 10'11" |
| Bedroom 2* | 4.10m x 2.96m 13'05" x 9'08" |
| Bedroom 3 | 3.02m x 2.78m 9'10" x 9'01" |
| Bedroom 4 | 3.34m x 2.40m 10'11" x 7'10" |

*max measurement taken

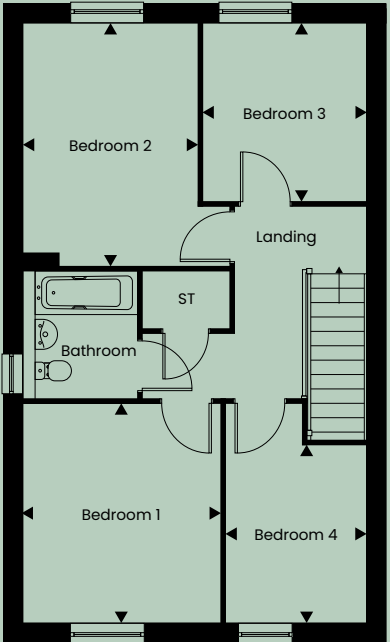
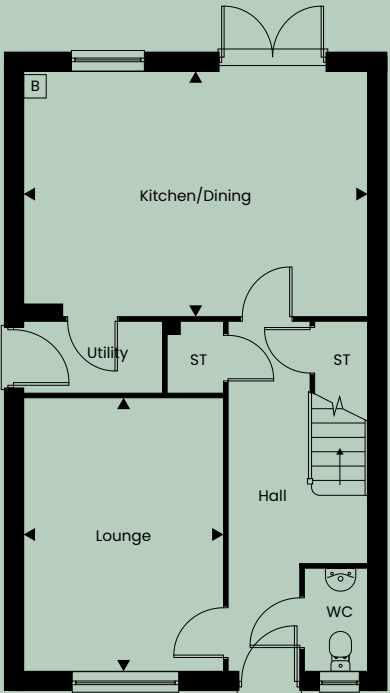

CGI's for illustrative purposes only. Gradient not to scale

Four Bedroom House

Plots 12 & 13*

*Plots 13 are mirrored to layout shown

dimensions

| | |
|-----------------|----------------------------------|
| Kitchen/Dining* | 6.58m x 3.18m 21'07" x 10'05" |
| Lounge | 4.67m x 3.59m 15'03" x 11'09" |
| Study | 3.59m x 1.86m 11'09" x 6'01" |
| Bedroom 1 | 3.59m x 3.45m 11'09" x 11'03" |
| Bedroom 2 | 3.45m x 3.18m 11'03" x 10'05" |
| Bedroom 3* | 3.60m x 2.38m 11'09" x 7'09" |
| Bedroom 4 | 3.07m x 2.91m 10'00" x 9'06" |

*max measurement taken

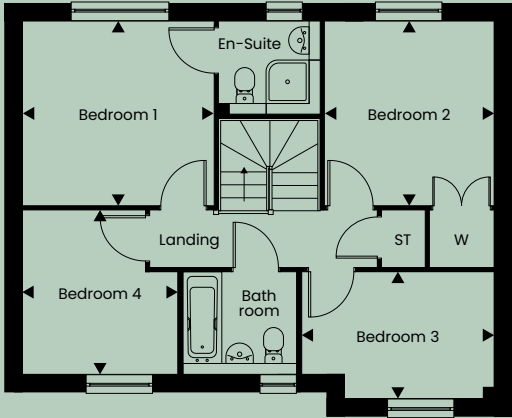
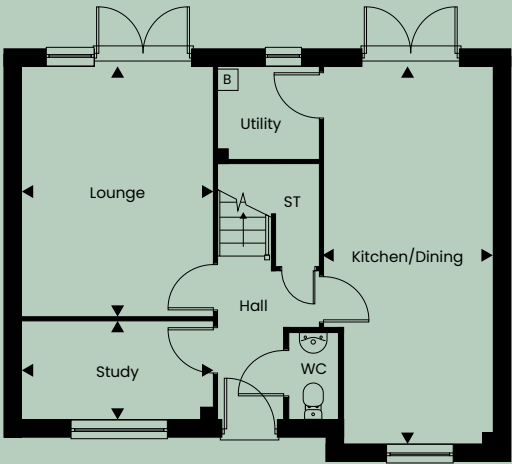

Specification



Kitchen

- Woodbury White kitchen cupboards
- Matt nickel wide bow handle HPK671
- Carbon steel worktop
- White gloss wall tiles
- Oven, hob and cooker hood provided
- Integrated dishwasher, washing machine and fridge freezer
- Granary Oak Amtico Spacia Vinyl flooring

Bathroom

- 'Blanco' wall tile to wet areas
- Thermostatic shower over bath
- Granary Oak Amtico Spacia Vinyl flooring
- Ensuite to selected plots

General*

- Carpets 'Skyline Steel' – Apollo Elite
- Gas central heating
- Private garden with turf
- Minimum two car parking spaces per plot

*Specification subject to change

Shared Ownership

the option you never knew existed

Shared Ownership* enables you to buy an initial share of a property and pay a subsidised rent on the rest, meaning you can get into home ownership in manageable stages and don't take on more of a financial commitment than you can afford.

Initial shares of between 10% and 75%** of our properties are available, you will pay a subsidised rent on the remaining share. In the future you can purchase further shares in your home***, or sell your share and move on.

Wondering if Shared Ownership is right for you?



YOU CAN BUY BETWEEN A 10-75% SHARE



MAKE MORTGAGE PAYMENTS ON THE SHARE YOU OWN



PAY RENT ON THE REMAINING SHARES



BUY MORE SHARES IN YOUR PROPERTY FROM 1% INCREMENTS



*Properties are offered as leasehold, with a lease term of 999 years.

**Shares offered are based on the affordability determined by an Independent Mortgage Advisor.

***Some properties are restricted to the level of share you can purchase.

The right time to buy



Charlotte

When her Sales Advisor went on paternity leave, he ensured a smooth handover, though no extra support was needed.

“My sales advisor was a godsend—he went above and beyond.”

Just before completion, Charlotte learned she was four months pregnant. The timing was perfect, and they moved in April 2024, welcoming baby Arlo in September.

Now, Charlotte and her family love their spacious home, with a separate kitchen, utility area, and a garden with double doors. The two-car driveway is a huge improvement over their previous single parking space.

Working from home is now much easier with more space, and they’ve enjoyed personalizing their home with decor.

“At the flat, we were always out. Now, we love staying in.”

With stunning views over the fields, Charlotte has found the perfect mix of countryside and modern living.

“Shared Ownership made homeownership possible when we needed it—we wouldn’t have been able to buy otherwise.”

“My sales advisor was a godsend—he went above and beyond.”

Charlotte, 32, from Hitchin, first used the Shared Ownership scheme to buy a two-bedroom apartment.

After marrying Stephen and becoming a family of four, they needed a three-bedroom home. Wanting to stay near Hitchin but find something more affordable, Charlotte discovered a Shared

Ownership home in Lower Stondon with Domovo and enquired immediately.

Her Domovo Sales Advisor referred her to an independent mortgage advisor (IMA), who contacted her the next day. Both stayed in touch throughout the process, making it smooth and reassuring.

“I had everything confirmed in emails, so I always knew what was agreed and when.”

Since she bought off-plan, Charlotte couldn’t view her actual home, but a finished, identical plot helped her visualize the space. The brochure’s detailed floor plans and specifications also reassured her.



Lidlington GARDENS

Heydon Close, Lidlington, Bedfordshire, MK43 2AS

01234 674070 | sales@domovohomes.co.uk

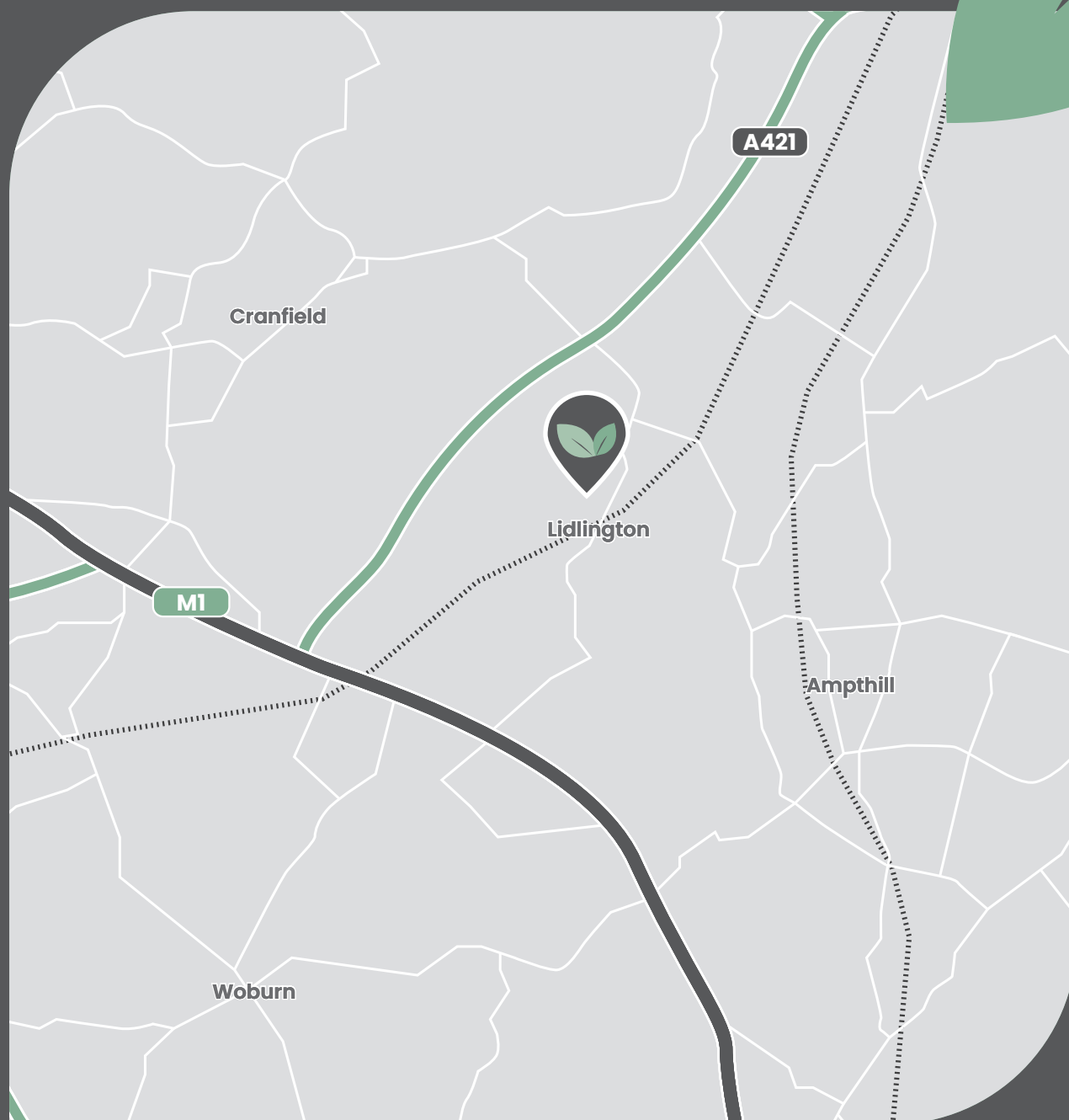

Marketing and Sales Brand
domovohomes.co.uk



A development by
bpha.org.uk

Disclaimer: Whilst we endeavour to make our property details accurate and reliable, these particulars are set out as a general outline only for the guidance of intended purchasers or lessees and do not constitute as a full or part offer or contract. Other details are given without responsibility and intending purchasers or tenants should not rely on them as statements or representations of fact but must satisfy themselves by inspection or otherwise as to the correctness of them. The purchaser is advised to obtain verification from their Solicitor or Surveyor to their own satisfaction.