

**Sherwin
Gardens**

**The Darwell
3 bedroom home**



Plots as drawn: 27, 33 and 48
Handed: 28, 34 and 49

81.14 sq.m / 873 sq.ft

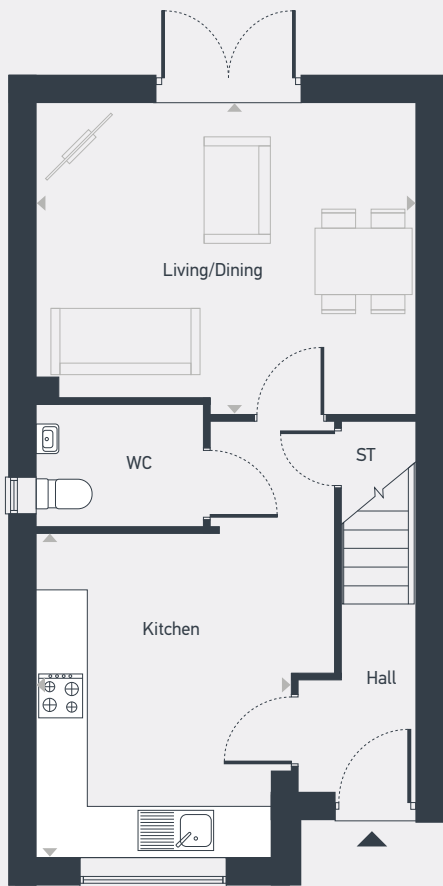

GROUND FLOOR

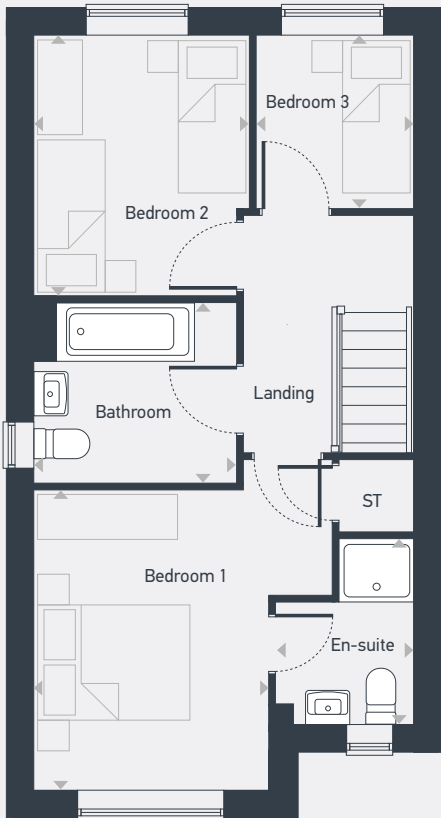

FIRST FLOOR

ST: Store WC: Water Closet

DIMENSIONS	m	ft
Kitchen	3.91m x 3.07m	12'10" x 10'1"
Living/Dining	4.59 x 3.76m	15'1" x 12'4"

DIMENSIONS	m	ft
Bedroom 1	3.61m x 2.84m	11'10" x 9'4"
En-suite	2.25m x 1.67m	7'4" x 5'6"
Bedroom 2	3.15m x 2.59m	10'4" x 8'6"
Bedroom 3	2.10m x 1.91m	6'11" x 6'3"
Bathroom	2.43m x 2.15m	8'0" x 7'1"



centralandnorthsales@placesforpeople.co.uk | placesforpeople.co.uk/sherwin-gardens
Sherwin Gardens, Sidings Lane, Bramcote, Nottingham NG9 3GJ

Please note: All layouts and floor plans, configurations, maps and information are intended for guidance only and accuracy of this information cannot be relied upon by prospective purchasers who must make their own enquiries to satisfy themselves by inspection or otherwise as to the correct detail.