

Approximate Floor Area = 79.1 sq m / 851 sq ft  
Garage = 18.9 sq m / 203 sq ft  
Total = 98.0 sq m / 1054 sq ft

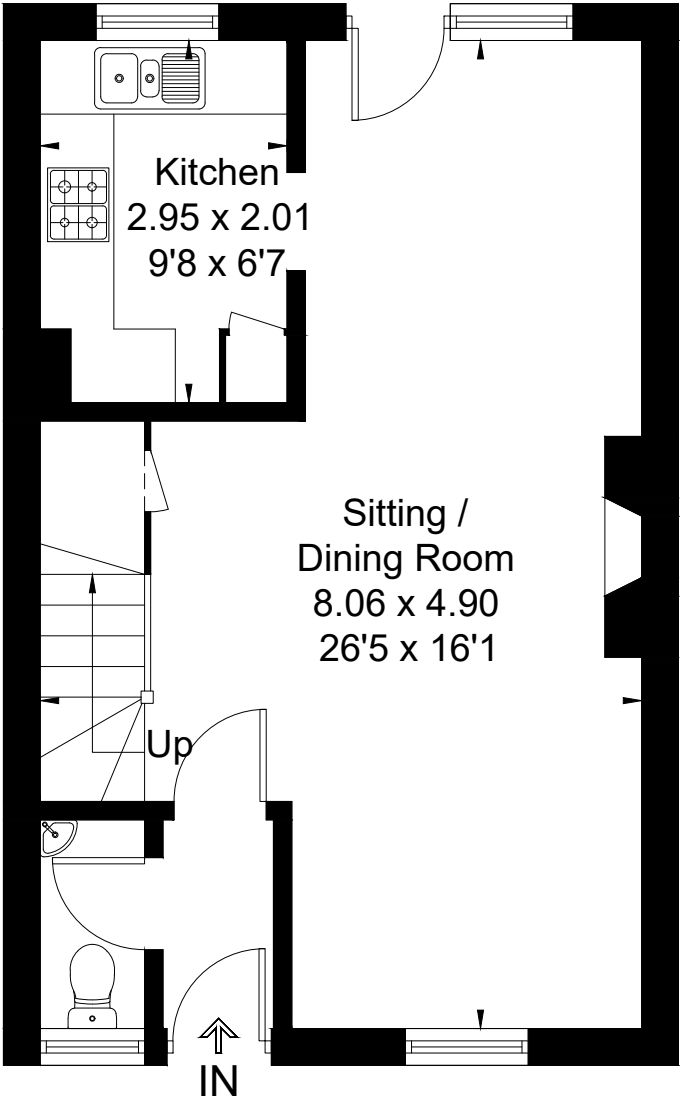

Ground Floor

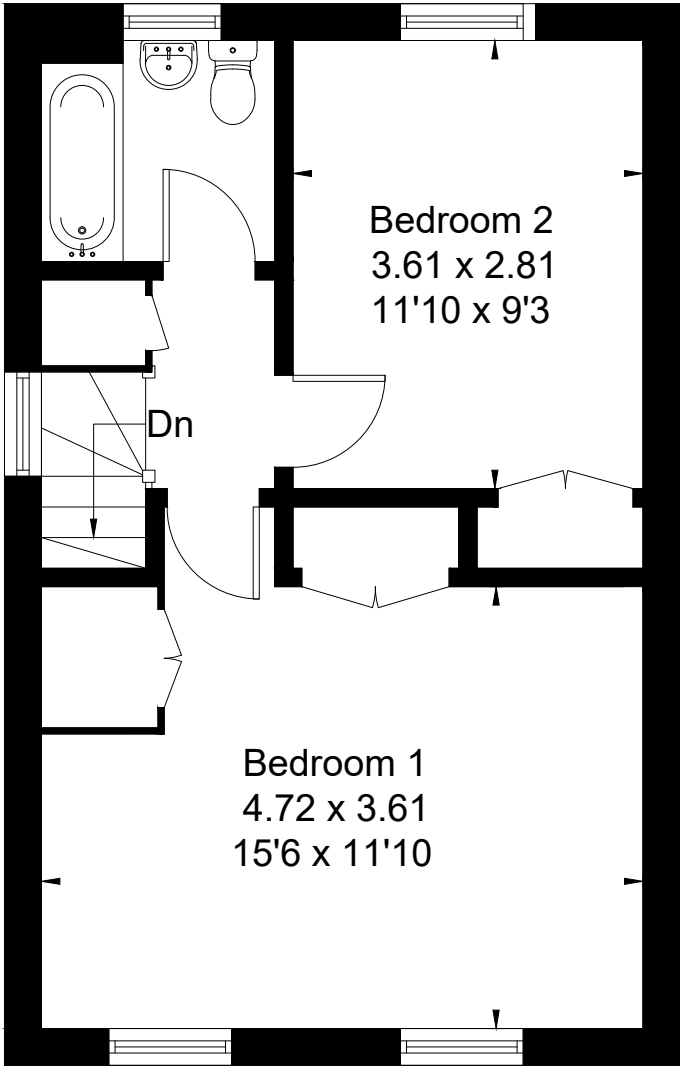

First Floor

[ ] = Reduced head height below 1.5m

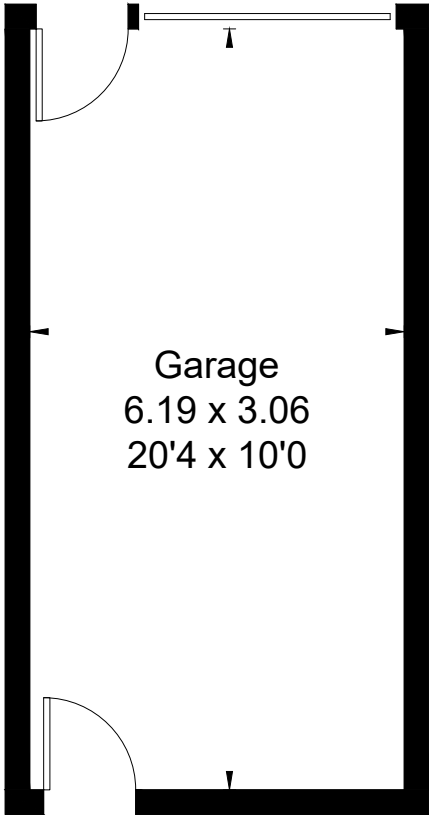

(Not Shown In Actual Location / Orientation)



This floor plan has been drawn in accordance with RICS Property Measurement 2nd edition.  
All measurements, including the floor area, are approximate and for illustrative purposes only. @fourwalls-group.com #93463