

Abbeville Park

The Dallington Type 2 3 bedroom home



Abbeville Park

The Dallington Type 2 3 bedroom home

Plots as drawn: 151, 188, 195, 197, 199, 201, 213 and 216
Handed: 149, 150, 187, 194, 196, 198, 200, 214 and 215

94 sq. m / 1,015 sq. ft

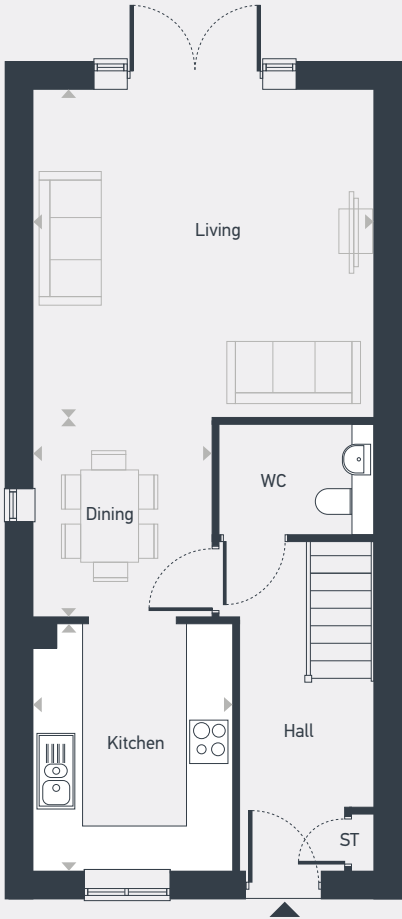

GROUND FLOOR

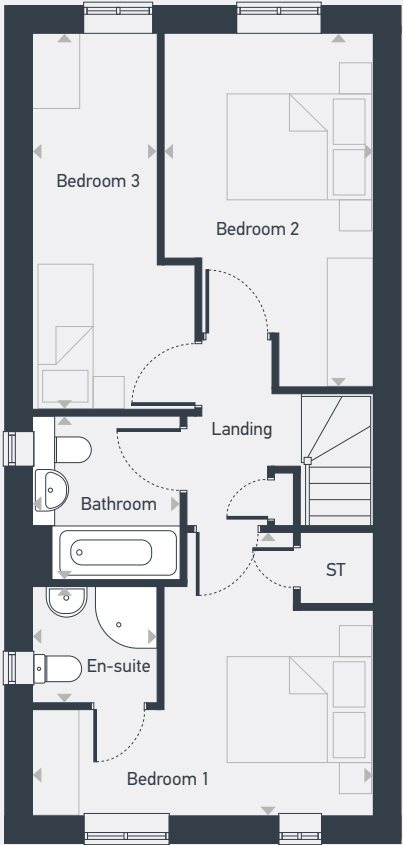

FIRST FLOOR

ST: Store WC: Water Closet

| DIMENSIONS | m | ft |
|------------|---------------|----------------|
| Living | 4.53m x 4.36m | 14'10" x 14'4" |
| Kitchen | 3.27m x 2.64m | 10'9" x 8'8" |
| Dining | 2.67m x 2.37m | 8'9" x 7'9" |

| DIMENSIONS | m | ft |
|------------|---------------|----------------|
| Bedroom 1 | 4.53m x 3.76m | 14'10" x 12'4" |
| En-suite | 1.70m x 1.55m | 5'6" x 5'1" |
| Bedroom 2 | 4.69m x 2.78m | 15'5" x 9'2" |
| Bedroom 3 | 4.99m x 1.65m | 16'4" x 5'5" |
| Bathroom | 2.15m x 1.95m | 7'1" x 6'5" |



01444 360 065 | placesforpeople.co.uk/abbevillepark
Abbeville Park, Fairbridge Way, Burgess Hill, West Sussex RH15 8BF

Please note: All layouts and floor plans, configurations, maps and information are intended for guidance only and accuracy of this information cannot be relied upon by prospective purchasers who must make their own enquiries to satisfy themselves by inspection or otherwise as to the correct detail. May25