

## Worting Park **The Daisy**

3 bedroom end terraced



Computer generated image for illustration purposes only. Finishes and materials used may be subject to change. Image depicts Plot 7, other plots may vary.



# Worting Park

## The Daisy

3 bedroom end terraced  
Plot 7, 17, 19\*

3  1  2 

Room

Kitchen/dining room	5.5m x 3.0m
Living room	5.5m x 3.3m
Bedroom 1	2.9m x 4.5m
Bedroom 2	3.2m x 4.0m
Bedroom 3	2.5m x 3.3m
Total area	95.5m <sup>2</sup>

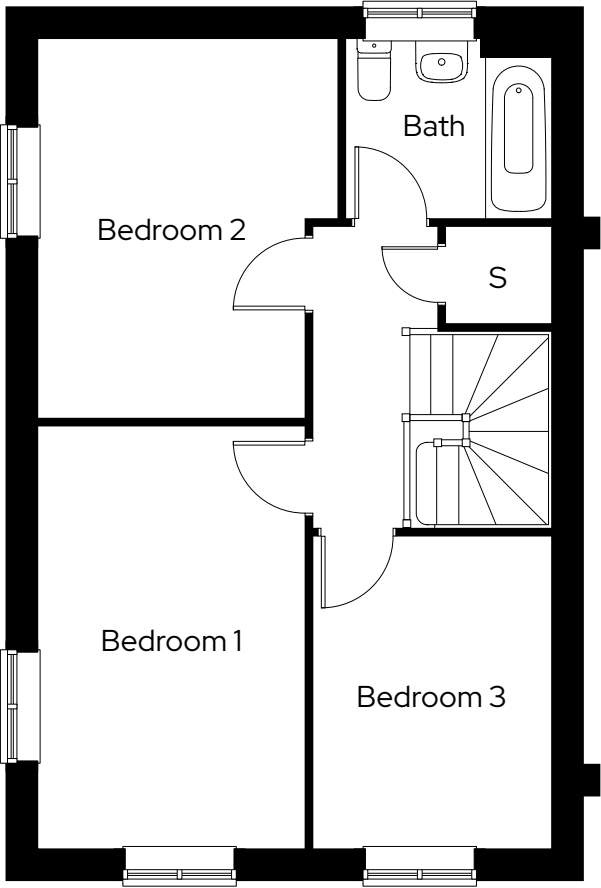
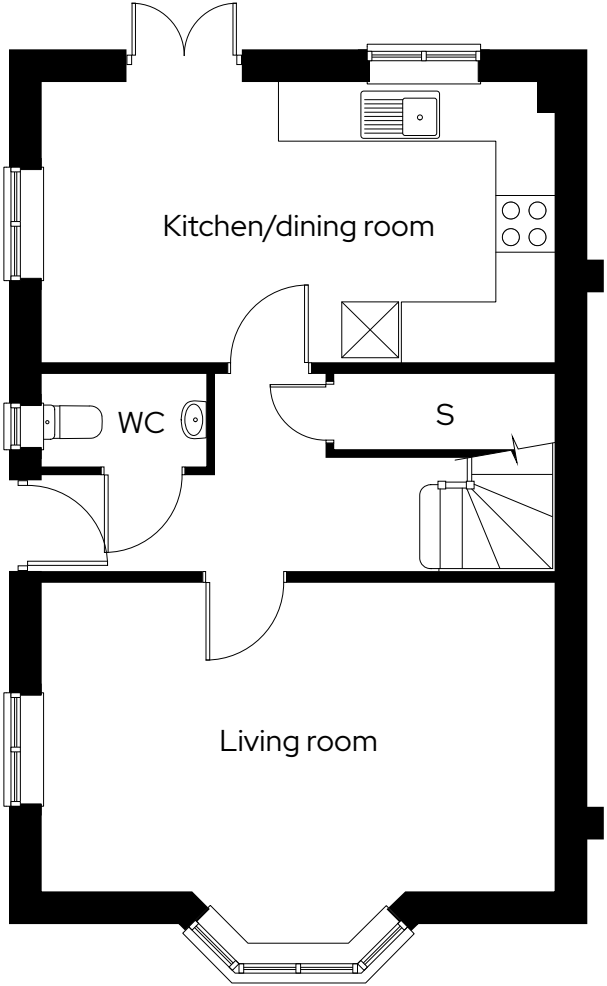

\* Mirrored plot   S Storage









Floor plan for illustration purposes only and not to scale. Dimensions are maximum and for general guidance, not suitable for furniture, appliances, or carpet sizing. Typical floor plan.



# Worting Park Site plan

North



-  **The Daisy**  
3 bedroom semi-detached/  
3 bedroom mid/end terraced
-  **The Clover**  
3 bedroom end terraced
-  **The Bellflower**  
2 bedroom mid terraced
-  **Parking spaces**
-  **Carport parking**
-  **Visitor parking**
-  **Cycle store**
-  **Electric vehicle charging point**

Site layout and landscaping is  
indicative only and subject to change.

