



# Marble Square

# The Cornflower 3 bedroom house

Plots drawn: 8, 32, 304 and 306  
Plots handed: 33, 305, 307 and 326

70.98 sq.m / 764 sq.ft

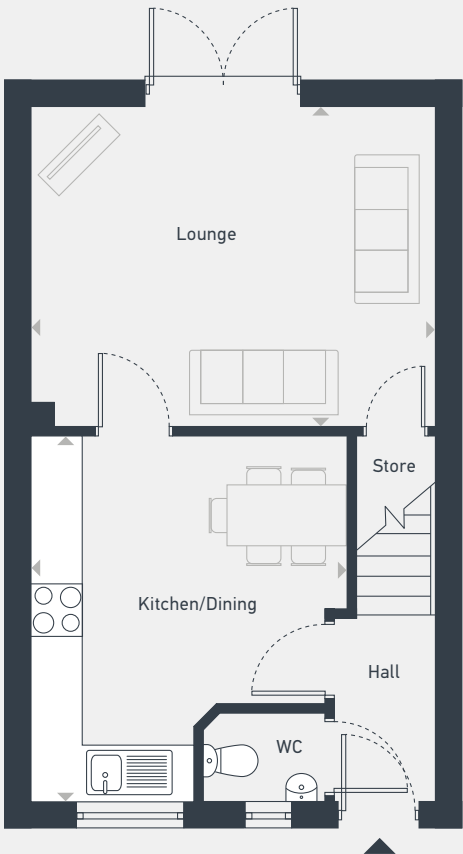

GROUND FLOOR

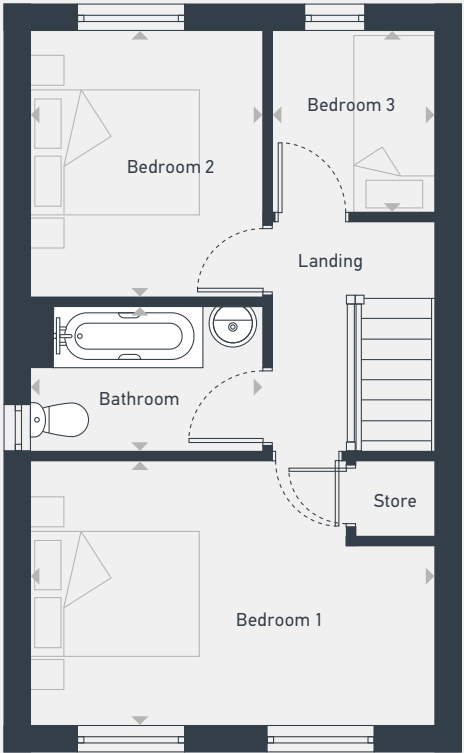

FIRST FLOOR

ST: Storage WC: Water Closet

DIMENSIONS	m	ft
Kitchen/Dining	4.10m x 3.54m	13'1" x 11'2"
Lounge	4.49m x 3.57m	14'2" x 11'2"

DIMENSIONS	m	ft
Bedroom 1	4.49m x 2.94m	14'9" x 9'8"
Bedroom 2	2.98m x 2.57m	9'9" x 8'5"
Bedroom 3	2.04m x 1.83m	6'8" x 6'0"
Bathroom	2.57m x 1.65m	8'5" x 5'5"



0115 671 0397 | [sales@thesohub.co.uk](mailto:sales@thesohub.co.uk) | [placesforpeople.co.uk/marble-square](https://placesforpeople.co.uk/marble-square)  
Marble Square, Nightingale Road, Osmaston, Derby DE24 8BF

**Please note:** All CGIs, layouts and floor plans, configurations, maps and information are intended for guidance only and accuracy of this information cannot be relied upon by prospective purchasers who must make their own enquiries to satisfy themselves by inspection or otherwise as to the correct detail. Sizes and dimensions approximate and subject to change.