

Prices
from
£133,000

Hazel End, Bishops Stortford

Black Thorn Row, Bishops Stortford, Hertfordshire, CM23 1GN

A brand new development of 2, 3 & 4 bedroom houses

//// ParadigmLiving



£ Prices from **£133,000 (35% share)**

% Share available **30%-75%**

🛏 **2 & 3 Bedrooms**



Hazel End KEY FEATURES

Bathroom suite and thermostatic shower

Carpet throughout living areas & Bedrooms

Tiled flooring in kitchen, vinyl flooring in the bathroom & downstairs toilet

Gas central heating

Allocated parking

Fitted kitchen with integrated oven and hob

Integrated washing machine and fridge freezer

A brand new development with a collection of 2, 3 & 4 bedroom homes. Located on the doorstep is a 16 Acre country park with green open space. A new primary school and nursery located on the outskirts of the Development.



These particulars do not constitute any part of an offer or contract. Any intended purchasers must satisfy themselves as to the correctness of each of the statements contained in these particulars. All floor layouts may be subject to changes. The dimensions given on the plan are subject to minor variations intended for guidance only and are not to be used for carpets, appliances or items of furniture.



Two Bedroom House

Plots 457 & 458*

(* handed)

KITCHEN

9'0" x 11'2" 1.84m x 3.42m

LIVING/DINING

14'4" x 15'11" 4.39m x 4.87m

BEDROOM 1

14'4" x 9'8" 4.39m x 2.96m

BEDROOM 2

14'4" x 10'2" 4.39m x 3.11m

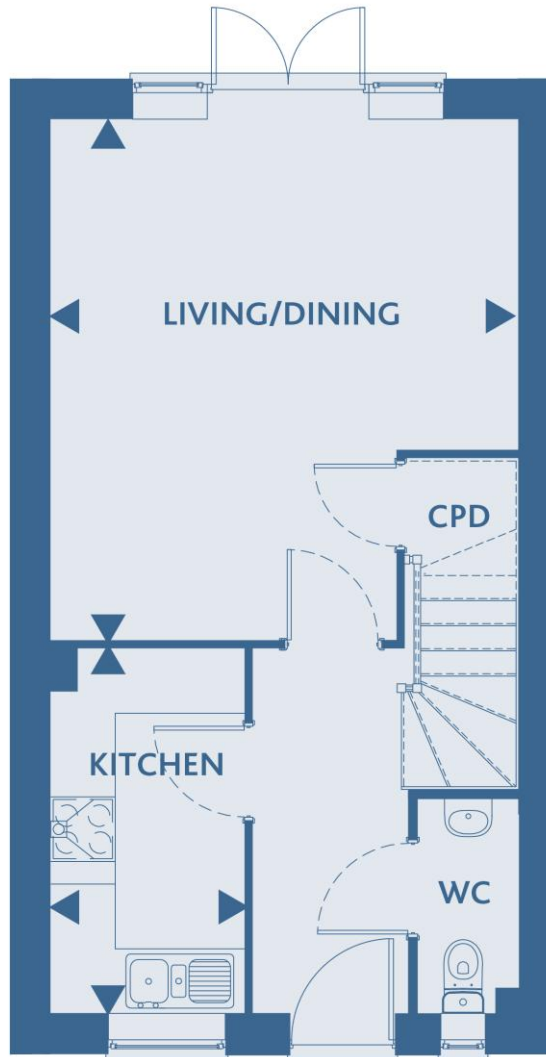

GROUND FLOOR

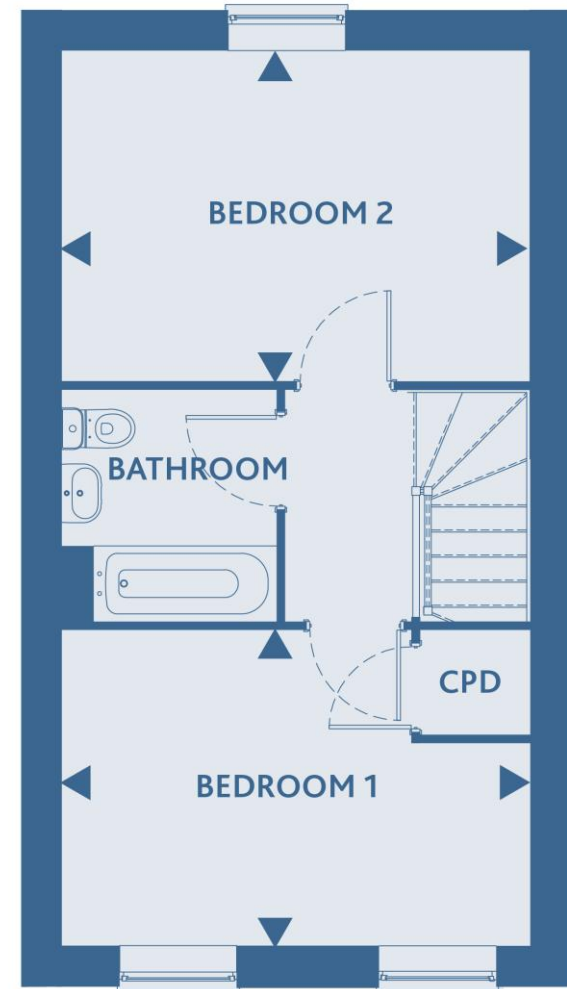

FIRST FLOOR

These particulars do not constitute any part of an offer or contract. Any intended purchasers must satisfy themselves as to the correctness of each of the statements contained in these particulars. All floor layouts may be subject to changes. The dimensions given on the plan are subject to minor variations intended for guidance only and are not to be used for carpets, appliances or items of furniture.





Three Bedroom House

Plots 455 & 459

(* handed)

KITCHEN

9'7" x 8'7"

2.94m x 2.64m

LIVING/DINING

16'6" x 13'7"

5.05m x 4.15m

BEDROOM 1

9'1" x 14'5"

2.79m x 4.41m

BEDROOM 2

8'10" x 12'9"

2.70m x 3.89m

BEDROOM 3

7'2" x 10'11"

2.20m x 3.33m

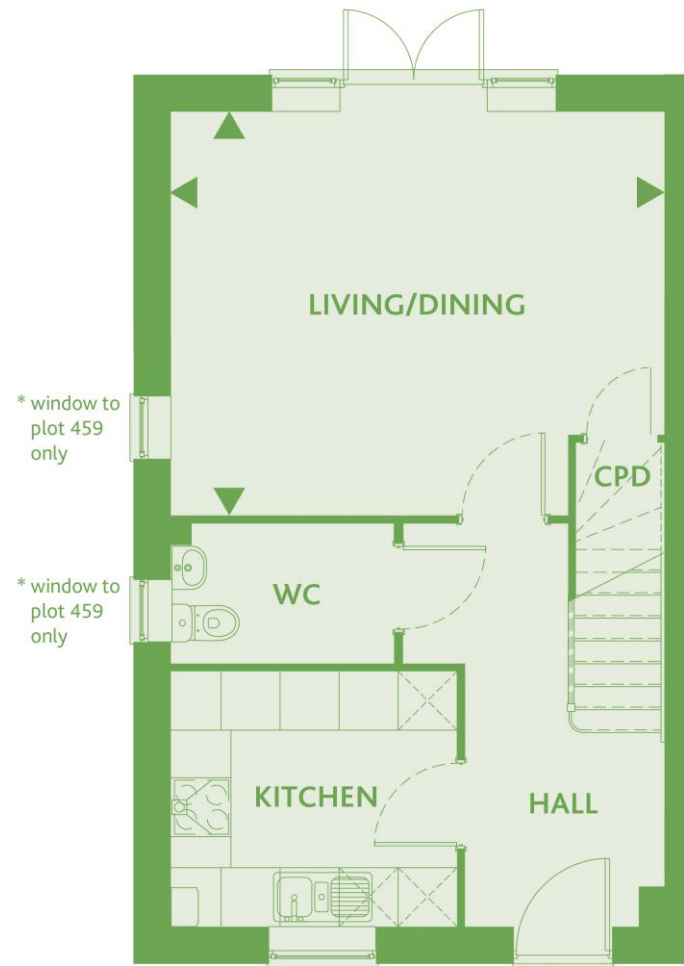

GROUND FLOOR

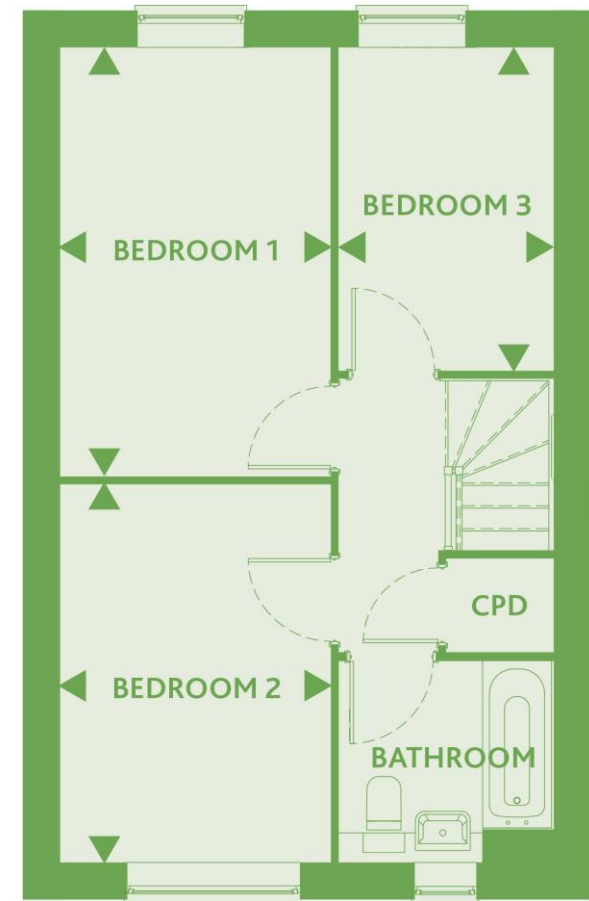

FIRST FLOOR

These particulars do not constitute any part of an offer or contract. Any intended purchasers must satisfy themselves as to the correctness of each of the statements contained in these particulars. All floor layouts may be subject to changes. The dimensions given on the plan are subject to minor variations intended for guidance only and are not to be used for carpets, appliances or items of furniture.



SITE PLAN



Rented properties

These particulars do not constitute any part of an offer or contract. Any intended purchasers must satisfy themselves as to the correctness of each of the statements contained in these particulars. All floor layouts may be subject to changes. The dimensions given on the plan are subject to minor variations intended for guidance only and are not to be used for carpets, appliances or items of furniture.



For more information

0300 303 8046

www.paradigmliving.co.uk

These particulars do not constitute any part of an offer or contract. Any intended purchasers must satisfy themselves as to the correctness of each of the statements contained in these particulars. All floor layouts maybe subject to changes. The dimensions given on the plan are subject to minor variations intended for guidance only and are not be used for carpets, appliances or items of furniture.

