

Mary

TWO BEDROOM

PLOTS 108, 109, 110, 111, 120*, 121*, 122*, 123*

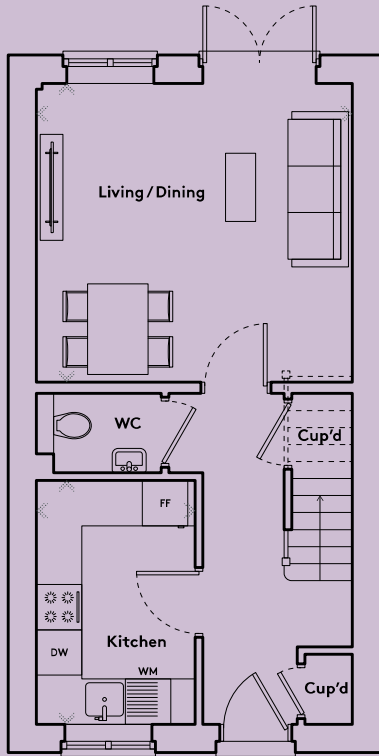

GROUND FLOOR

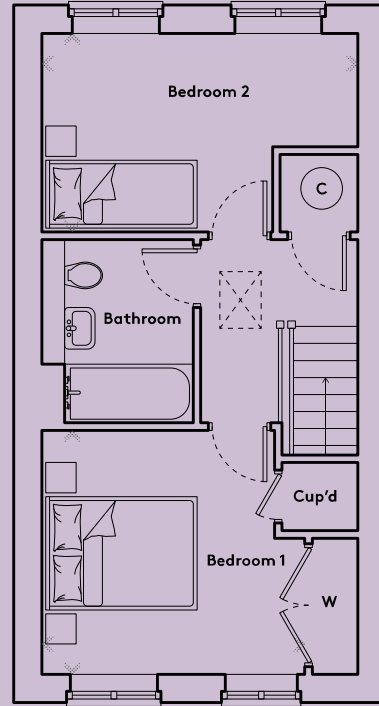

FIRST FLOOR

| | | |
|----------------------------|------------------|------------------|
| Kitchen | 2.10m x 3.24m | 6'11" x 10'8" |
| Living/Dining | 4.16m x 3.93m | 13'8" x 12'11" |
| Bedroom 1 | 3.47m x 3.24m | 11'5" x 10'8" |
| Bedroom 2 | 4.16m x 2.62m | 13'8" x 8'7" |
| GROSS INTERNAL AREA | 70.5 sq m | 759 sq ft |

FF | Fridge Freezer WM | Washing Machine DW | Dishwasher
C | Cylinder W | Wardrobe Cup'd | Cupboard WC | Water Closet

* These plots are handed to those shown. Floorplans are not to scale and are indicative only. Location of windows, doors, bathroom fittings, kitchen units and appliances may differ. Dimensions given are approximate and should not be used to order carpets or furniture. Wardrobe locations and sizes may differ.

