

Oakridge Park, Milton Keynes, MK14

Approximate Area = 896 sq ft / 83.2 sq m

Outbuilding = 56 sq ft / 5.2 sq m

Total = 952 sq ft / 88.4 sq m

For identification only - Not to scale

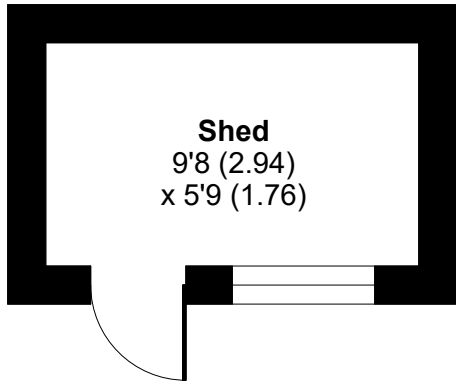

Shed
9'8 (2.94)
x 5'9 (1.76)

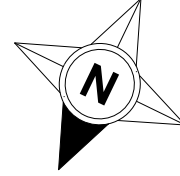

OUTBUILDING

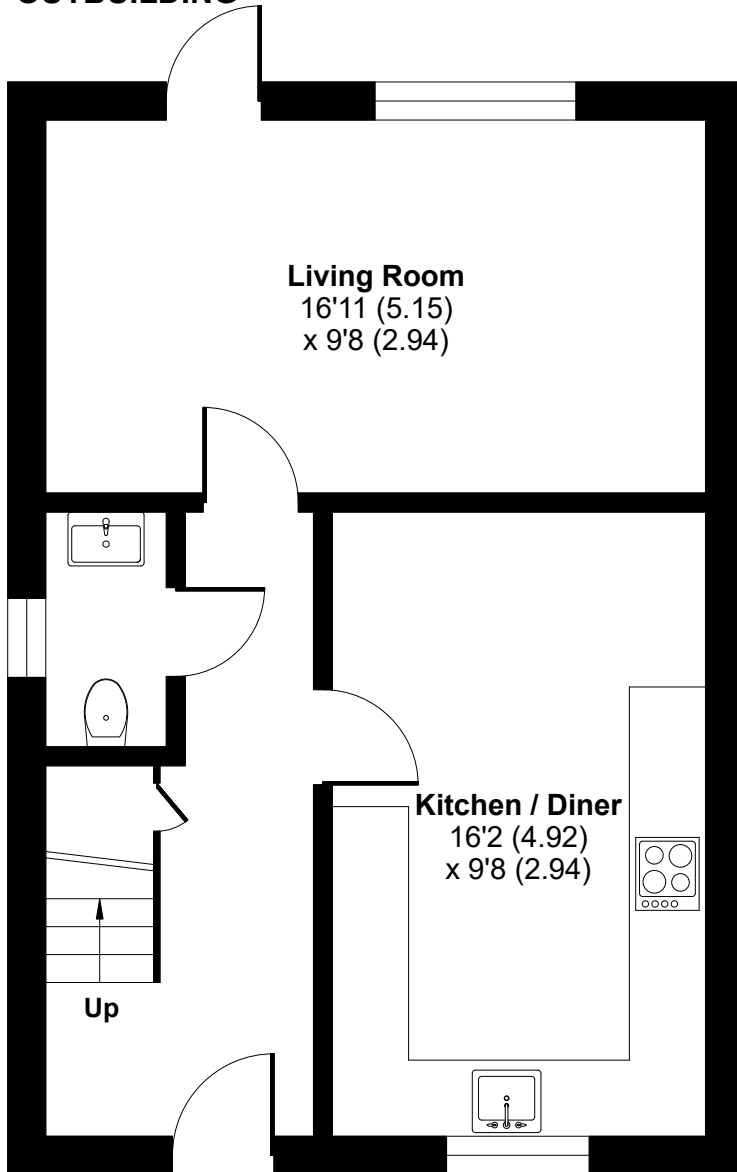

Living Room
16'11 (5.15)
x 9'8 (2.94)

Kitchen / Diner
16'2 (4.92)
x 9'8 (2.94)

Up

GROUND FLOOR

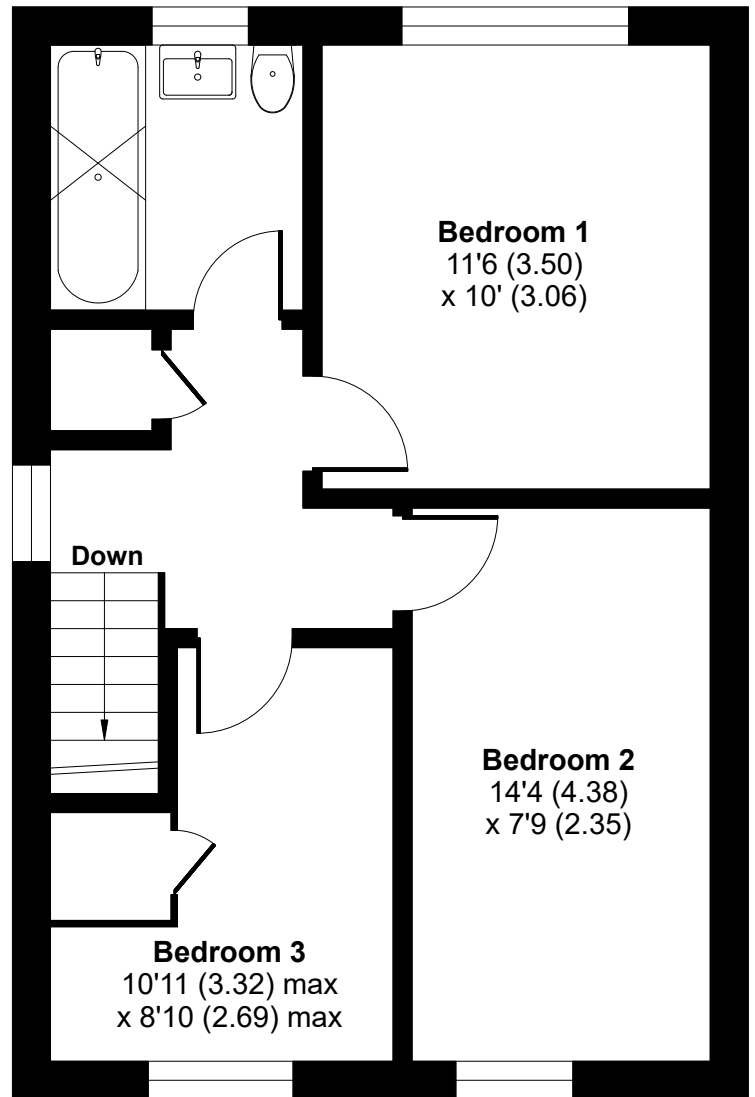

Bedroom 1
11'6 (3.50)
x 10' (3.06)

Bedroom 2
14'4 (4.38)
x 7'9 (2.35)

Bedroom 3
10'11 (3.32) max
x 8'10 (2.69) max

Down

FIRST FLOOR