

The Whittington

Orbit Homes at Cromwell Wharf

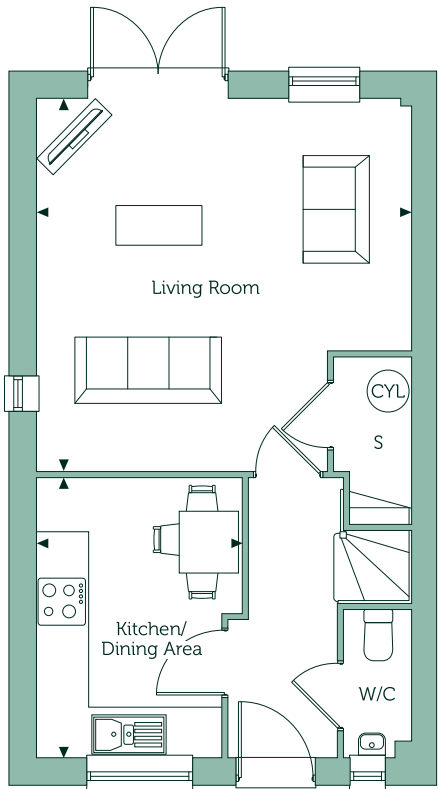

Ground Floor

Kitchen/Dining Area	
8'6" x 11'9"	2.60m x 3.58m
Living Room	
15'8" x 15'7"	4.79m x 4.77m

Handed Plot 263

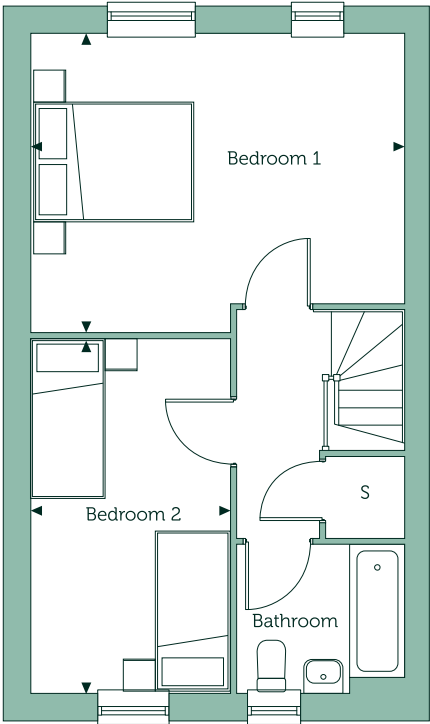

First Floor

Bedroom 1	
15'8" x 12'6"	4.79m x 3.82m
Bedroom 2	
8'4" x 14'10"	2.54m x 4.53m

Gross internal area	
81.0 sqm	871.7 sqft

Key

S Store Cupboard **CYL** Hot Water Cylinder

Floorplans are not drawn to scale. Measurements are taken from areas marked ►. They are maximum approximate dimensions and given as a guide only. These should not be used as a basis for purchasing flooring or furniture. Orbit reserves the right to alter plans, specification, position of doors and windows and change tenure subject to demand without prior notice. External elevations vary from plot to plot. Please ask your Sales Consultant for current information when reserving your new home. Computer generated image overleaf. Information correct at time of going to print. November 2025. 07447-01.